

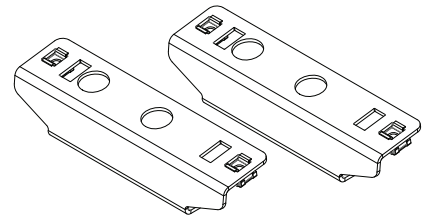

FORD TRANSIT CUSTOM CROSSBAR BASE FITMENT



MAX 3 BAR EVENLY DISTRIBUTED LOAD: 100KG.
IMPORTANT: THIS LOAD CAPACITY INCLUDES WEIGHT OF CROSSBARS (5KG EACH).

Important information:

- Do not exceed the maximum roof load capacity of your vehicle (found in vehicle owners manual). If lower than roof rack system, always use the lower of the two figures. The mass of the roof rack and any bar accessories fitted, must be subtracted from the maximum carrying capacity to determine actual payload capacity. As a guide each cross bar weighs 5kgs. Example: Maximum Carrying capacity of 100kgs, Subtract 15kgs for a three bar system. Actual Payload is 85kgs.
 - Narrow and heavy loads are to be carried near the feet. - Loads which overhang shall conform to any relevant state laws.
 - Check tie down strap tension every 50kms as loads can shift and resetttle
 - Do not use elastic straps to secure a load. Surfboards or similar large wind resistive loads should NOT be carried side by side but on top of each other. Each should be secured independently to the front and rear roof bar.
 - Specialised equipment carriers for specific products should always be used. I.e Ladder rack, bike and kayak carriers
- Note:** The handling characteristics of a vehicle will change when a carrier system is fitted. Driving techniques should be altered to allow for these changes, reducing speed, cornering and allowing longer braking distances.
- Roof bars can be removed when not in use.

Parts list:

Item	Part	3 Bar
1	M6 x 30mm pan HD Screw - F008	12
2	M6 Spring Washer - F012	12
3	M6 x 16mm Flat Washer - F011	12
4	M8 x 16mm pan HD screw - F016	12
5	M8 Spring Washer - F018	12
6	M8 x 17mm Flat washer - F017	12
7	Right Bracket - C085	2
8	Left Bracket - C086	2
9	Rear Right Bracket - C189	1
10	Rear Left Bracket - C190	1
11	Allen Tool - C028	1

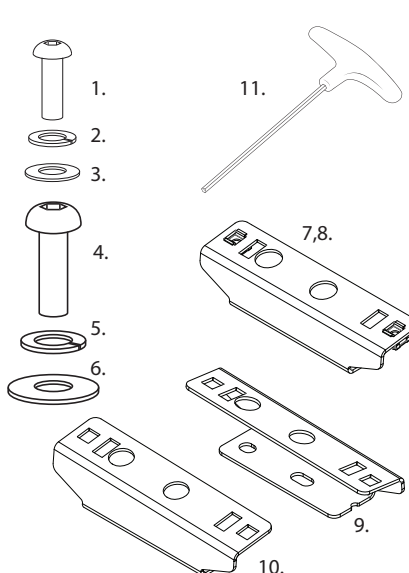

Required kits (as separate):

Crossbar x3
1500mm
10mm
spacer x 1

Crossbar Mount
Kit x3

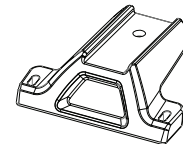

Low Mount

Required Tools:

- 1 - Screw Driver.
- 2 - Butyl Sealant.
- 3 - T40 Torx Key.
- 4. 5mm Allen Key.

Step 1

Identify the factory crossbars mounts on the roof of the vehicle.

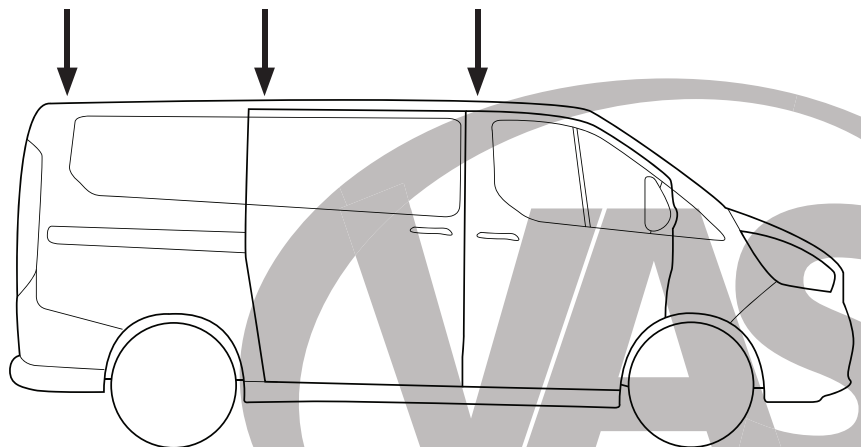
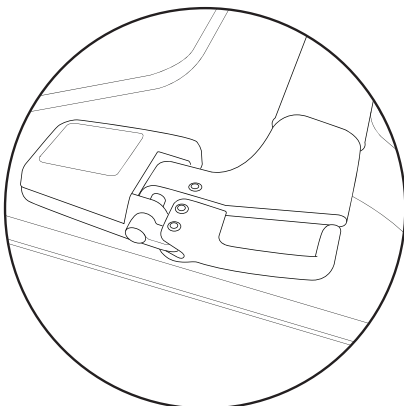

VAN RACKING MOUNT FITMENT

Step 2

1 - Using a screw driver, remove the cover from the factory crossbars. 2 - With a T40 torx-key, remove the screws and the crossbars from the roof. Store in a safe place. 3 - Apply butyl mastic to each exposed thread in the roof.

1:

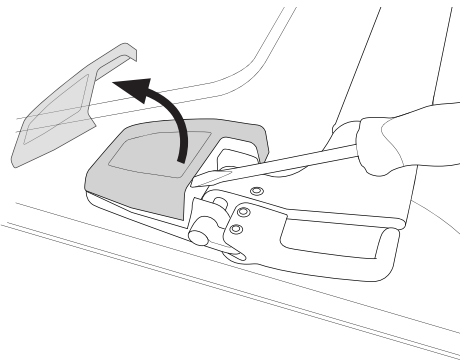

2:

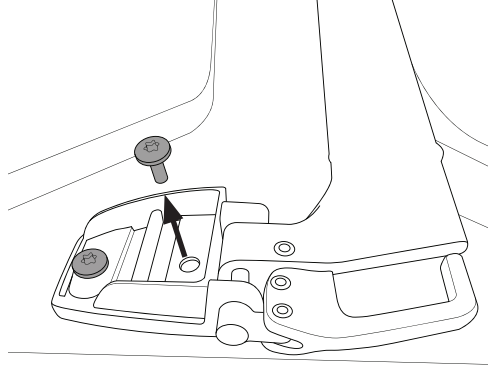

3:

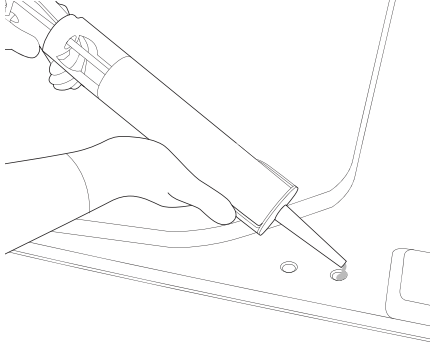

Step 3

1 - Install the M8 hardware into each bracket. 2 - Place the assemblies over the exposed mounting points in the roof. Tighten the assembly with a 5mm allen key.

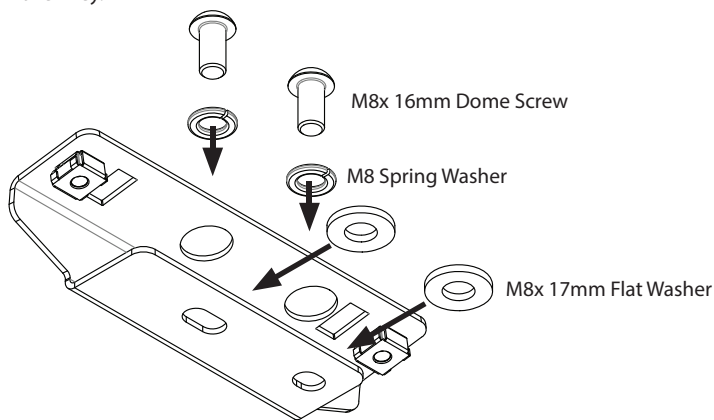

2:

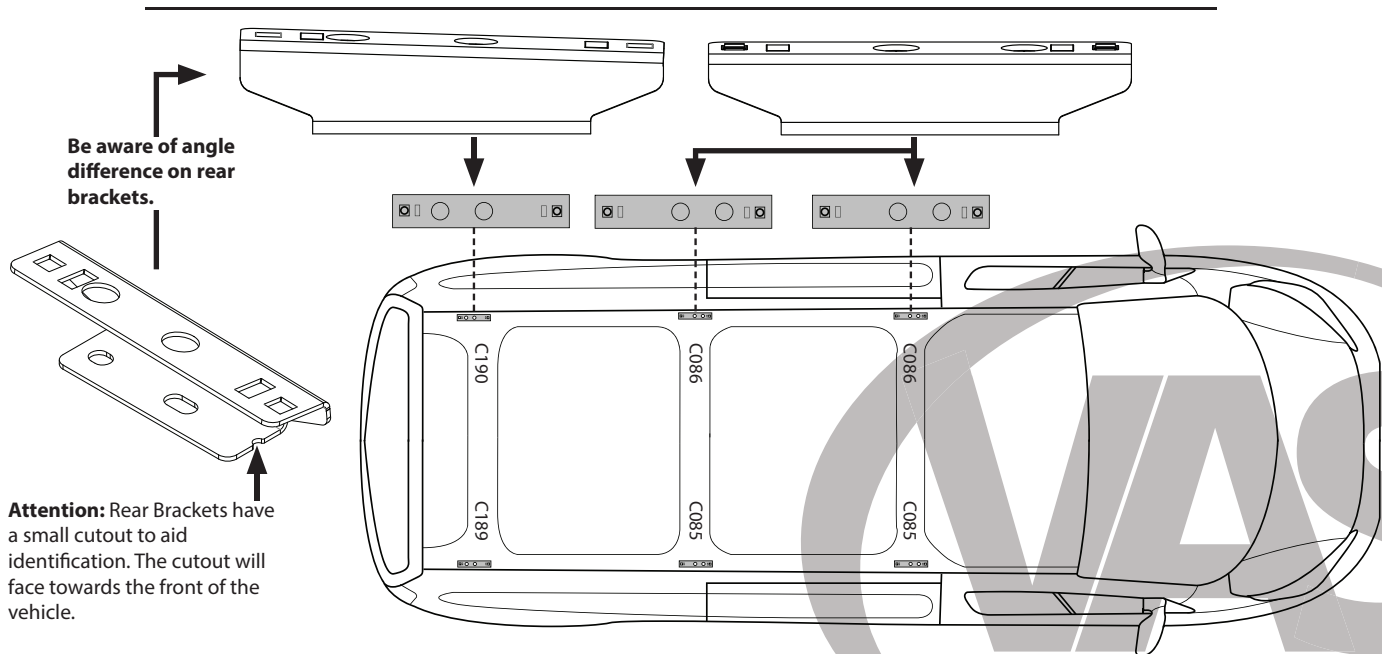
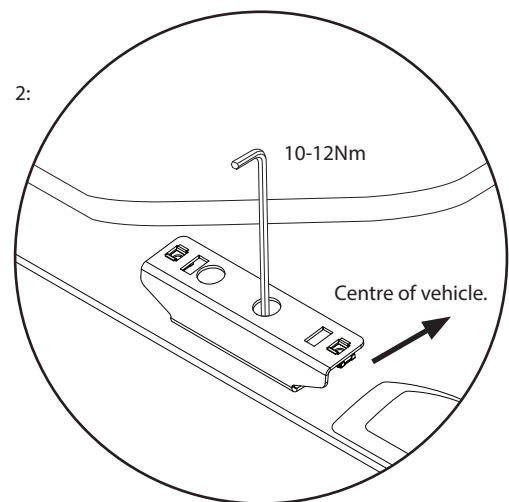

VAN RACKING MOUNT FITMENT

Step 4

Complete crossbar mount kits as specified in their instructions. Place the crossbars onto the installed brackets in the roof. Fix in place with the M6 hardware provided and tighten with the allen key provided.

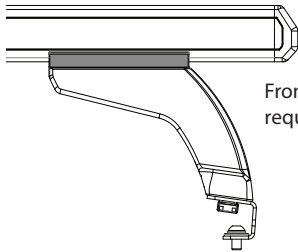

Front and rear crossbars require a 10mm spacer.

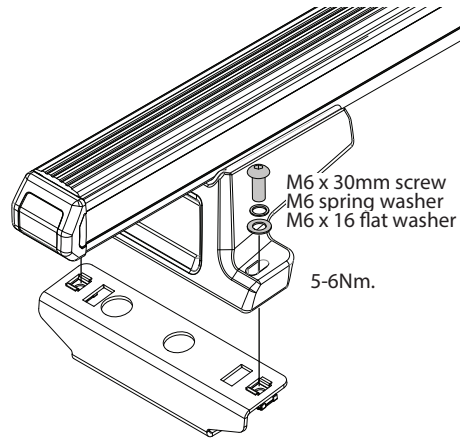

NOTE

ATTENTION:

Thoroughly check all fasteners are secure before driving away.

