



RHINO-RACK®

ISUZU MU-X Gen 2 Backbone

RIMB2

Important:

1. Check the Rhino-Rack website to ensure you have the latest issue of these instructions.
2. Please refer to your fitting instruction to ensure that the roof racks are installed in the correct locations.
3. Check the contents of kit before commencing fitment and report any discrepancies.
4. Place these instructions in the vehicle's glove box after installation is complete.
5. These instructions must be followed for warranty to be upheld.

Fit Time: 3 hours

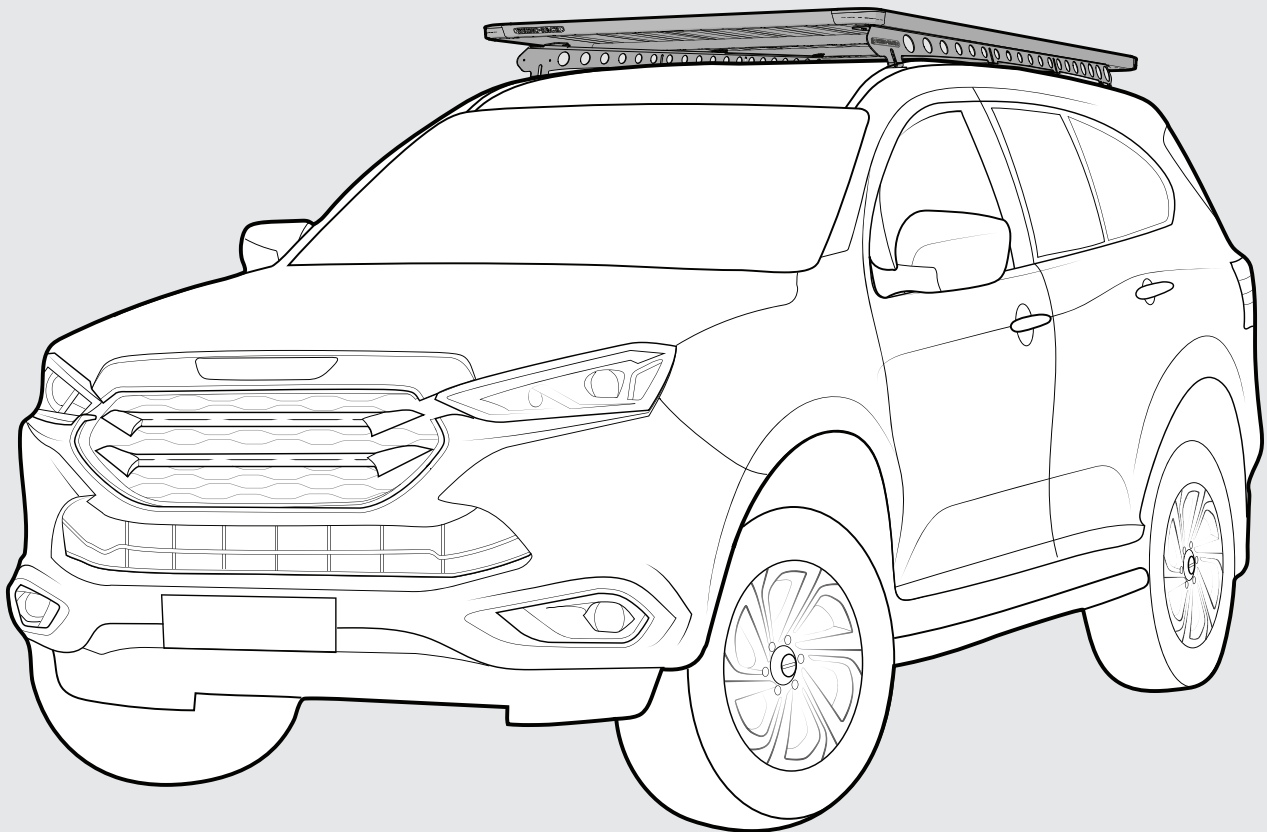

Rhino-Rack AUSTRALIA
22A Hanson Pl,
Eastern Creek, NSW, 2766
(02) 8846 1900
rhinorack.com.au

Rhino-Rack USA
Unit D, 2450 Airport Blvd,
Aurora, CO, 80011
877-744-6622
rhinorack.com

Document No: 520-RFI-00071
Issue No: 02
Issue Date: 11/02/2022

RIMB2 Backbone Instructions

Carrying Capacity

Check the website and the vehicle owners hand book for your vehicle manufacturer's maximum carrying capacity. Load must be evenly distributed over the system.

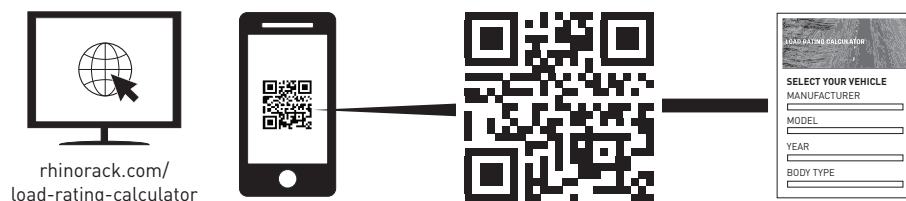

Cargo Load Limit

Total permissible weight allowed on top, and attached to the rack whilst the vehicle is in motion.

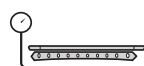

System Weight

Total weight of the rack system. (e.g. Crossbars, Backbone, Platform)



Max System Load Capacity

Please ensure you use the vehicle manufacturer's maximum roof allowance if it is lower than the figure listed in the fitting chart/supplement.



Vehicle Manufacturer's Load Limit

Total permissible weight attached to the rack. This is inclusive of the weight of the rack system.

Warning

- Check part number or kit is correct for use with your vehicle.
- Do not attempt to fit the rack system to your vehicle unless you fully understand these fitting instructions. Please direct any questions regarding fitting to the dealer from where the roof racks were purchased.
- Off-road conditions can be much more rigorous. Extreme care must be taken on any driven path that does not contain a surface protection layer (tar/bitumen).
- Racks must be removed when vehicle is put through an automatic car wash.
- With utility/pick up vehicles, the cabin and the utility tray/truck bed move independently. Racks and vehicle can be damaged if the item transported is rigidly fixed at points on both the cabin and utility tray/truck bed. Instead, rigidly fix to either the utility tray/bed racks or the canopy roof racks.
- Always ensure you fasten your load securely.
- Use only non-stretch fastening ropes or straps to attach cargo to your load.

In service maintenance checks

- All bolt connections should be checked after driving a short distance when you first install your roof racks.
- All bolted connections should be checked again at regular intervals (weekly is recommended, depending on road conditions, usage, loads and distances travelled).
- All bolted connections should be checked each time they are re-fitted.
- Off-road conditions are more rigorous. Check all bolted connections and your load more regularly.
- Ensure that your vehicle manufacturer's GVM, and gross axle weights are not exceeded (refer to vehicle owner's manual).

Torque Settings:

Unless stated otherwise in these instructions, all fasteners should be set to the following torque settings:

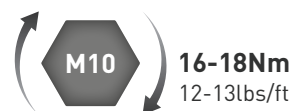

Note for Dealers and Fitters

It is your responsibility to ensure these fitting instructions are given to the end user or client. These instructions remain the property of Rhino-Rack Australia Pty. Ltd. and may not be used or changed for any other purpose than intended.

RIMB2 Backbone Instructions

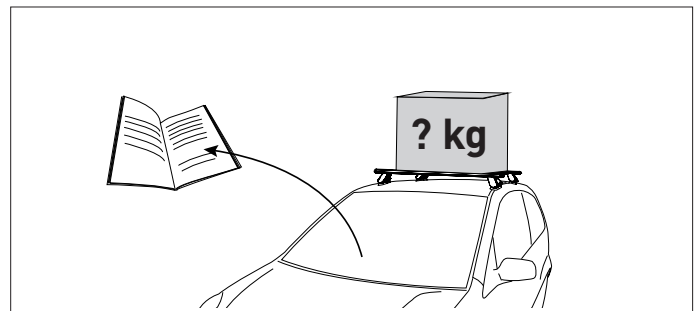
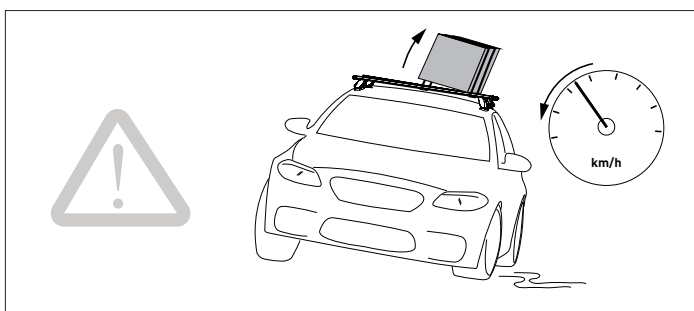
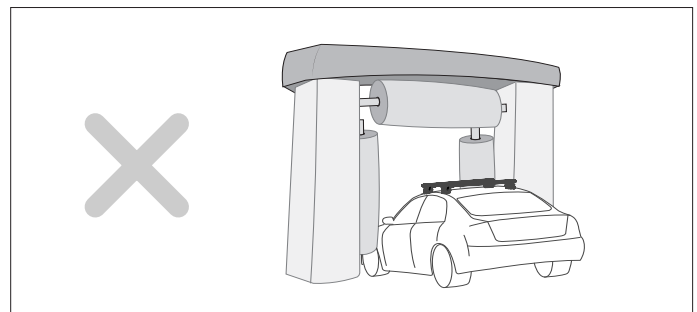
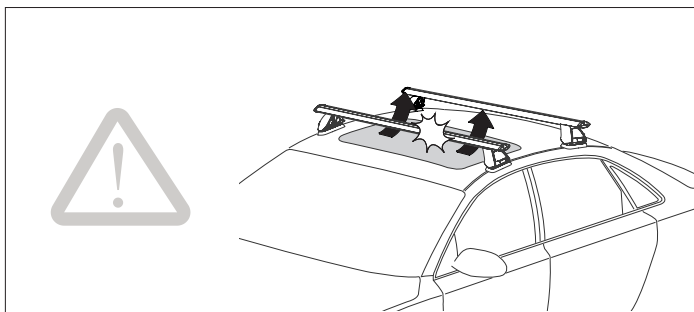
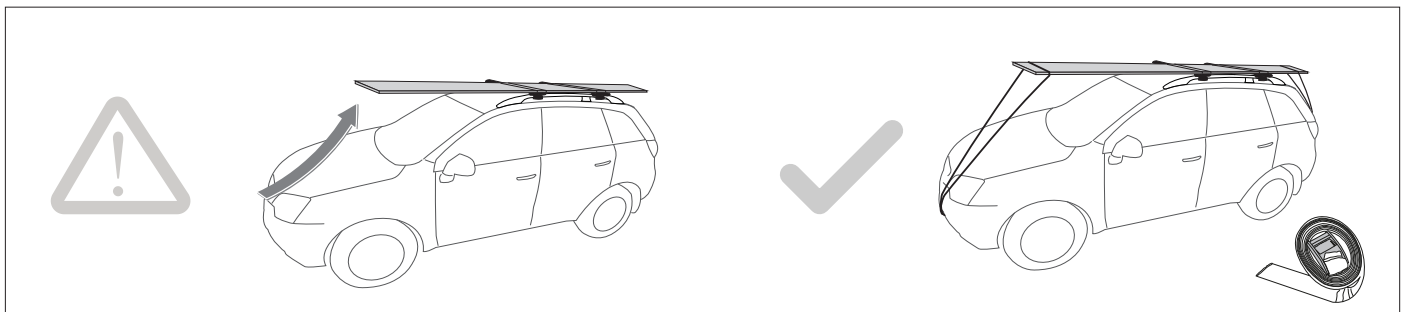

The handling characteristics of the vehicle changes when a load is transported on the roof. Exercise extreme care when transporting wind-resistant loads. Special consideration must be taken when cornering and braking.

Off-road conditions can be much more rigorous. Extreme care must be taken in off-road conditions.

Ensure Ladder is well supported on the ground to support tent. Take extreme caution when climbing heights above 1.2m/4ft.

Paddle/ Surfboards should be fixed to the front of the vehicle.

RIMB2 Backbone Instructions

Parts List

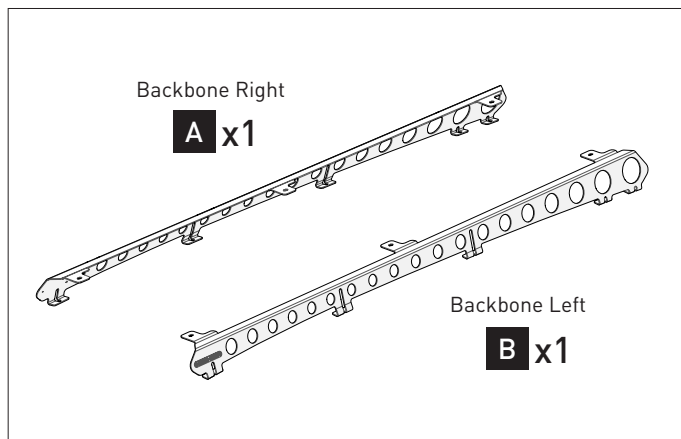

Tools Required:

- T1 - 13mm Socket + Ratchet
- T2 - Trim tool
- T3 - Cleaning Rag
- T4 - Masking Tape
- T5 - Flathead Screwdriver
- T6 - 6mm Allen Key
- T7 - 4mm Allen Key
- T8 - Caulking Gun with Butyl Mastic
- T9 - Measuring Tape
- T10 - Black Felt Tip Marker
- T11 - Scissors
- T12 - 13mm Spanner

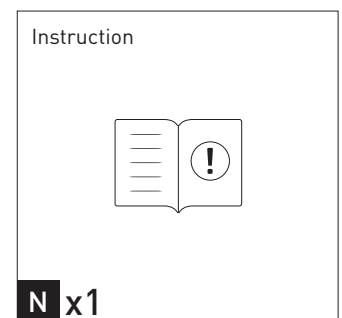
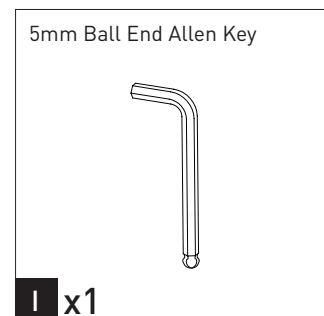
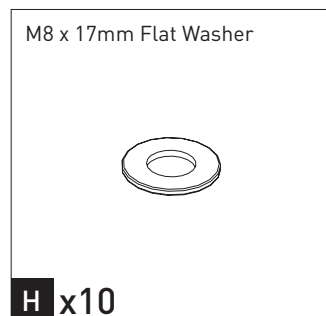
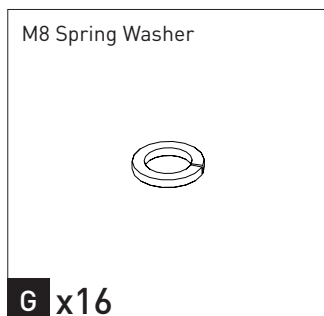
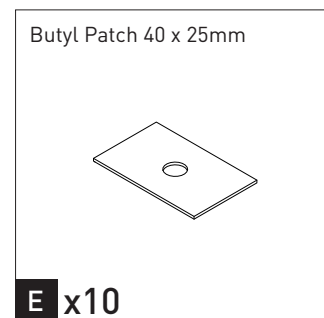
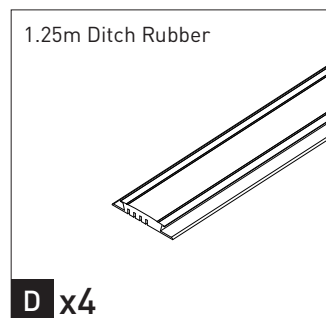
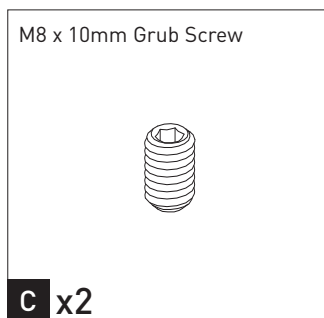

CONTENTS:

For **Factory Rail Variants**, complete Steps **1** - **8b** and **13** - **26**

For **Bare Roof Variant**, complete Steps **9** - **26**

FACTORY RAIL REMOVAL (For **Bare Roof** Variant, skip to Step **9**)

1 Remove rail end covers, using a clean rag to protect ditch and roof.

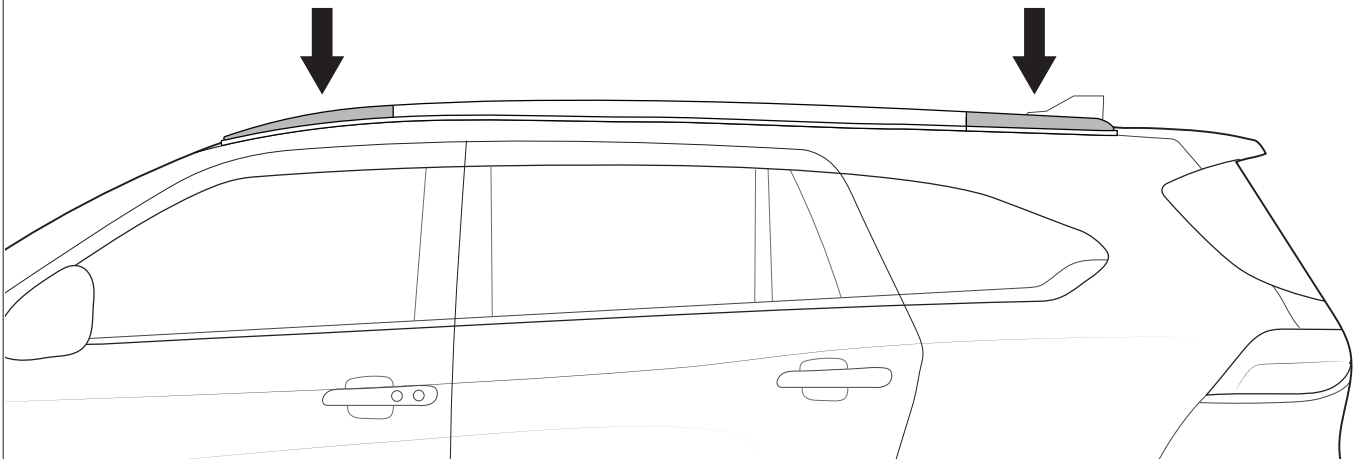

1a **Note:** Pull tool upwards to remove, **DO NOT** pry downwards and lever off roof or windscreen, as this may damage the vehicle.

FRONT
WINDSCREEN

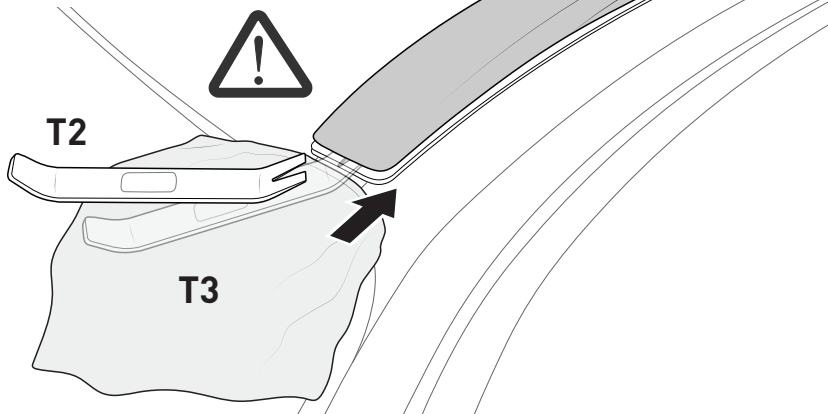

Fully insert tool between plastic cap and sealing rubber up to the internal clip.

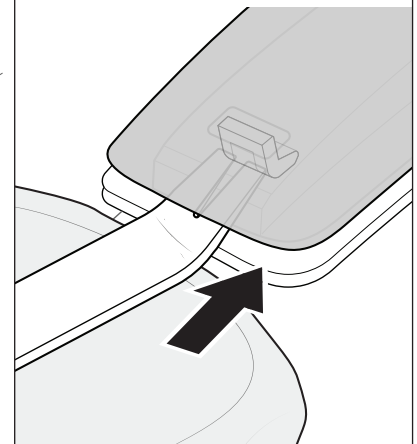

1b

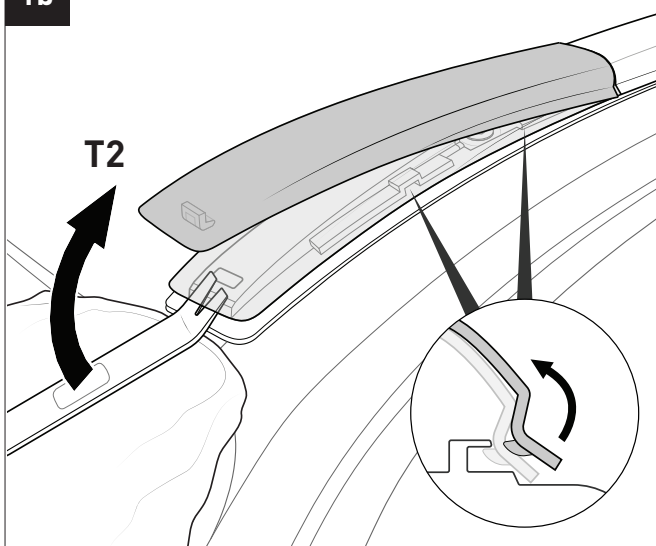

1c

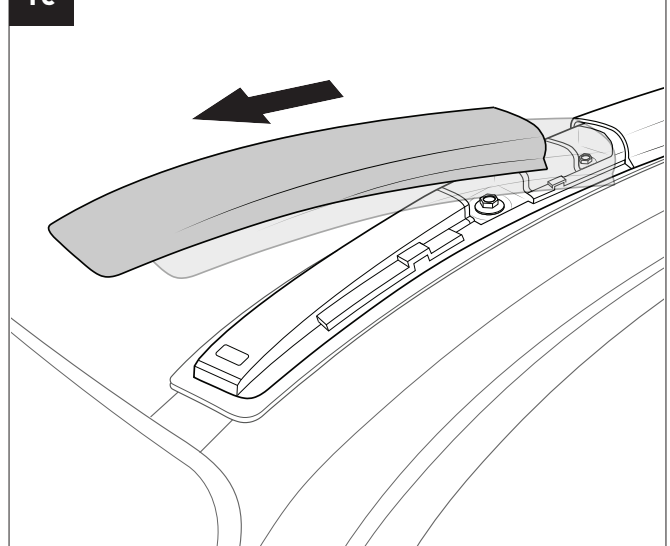

RIMB2 Backbone Instructions

- 2** Remove hardware underneath front and rear rail cover.

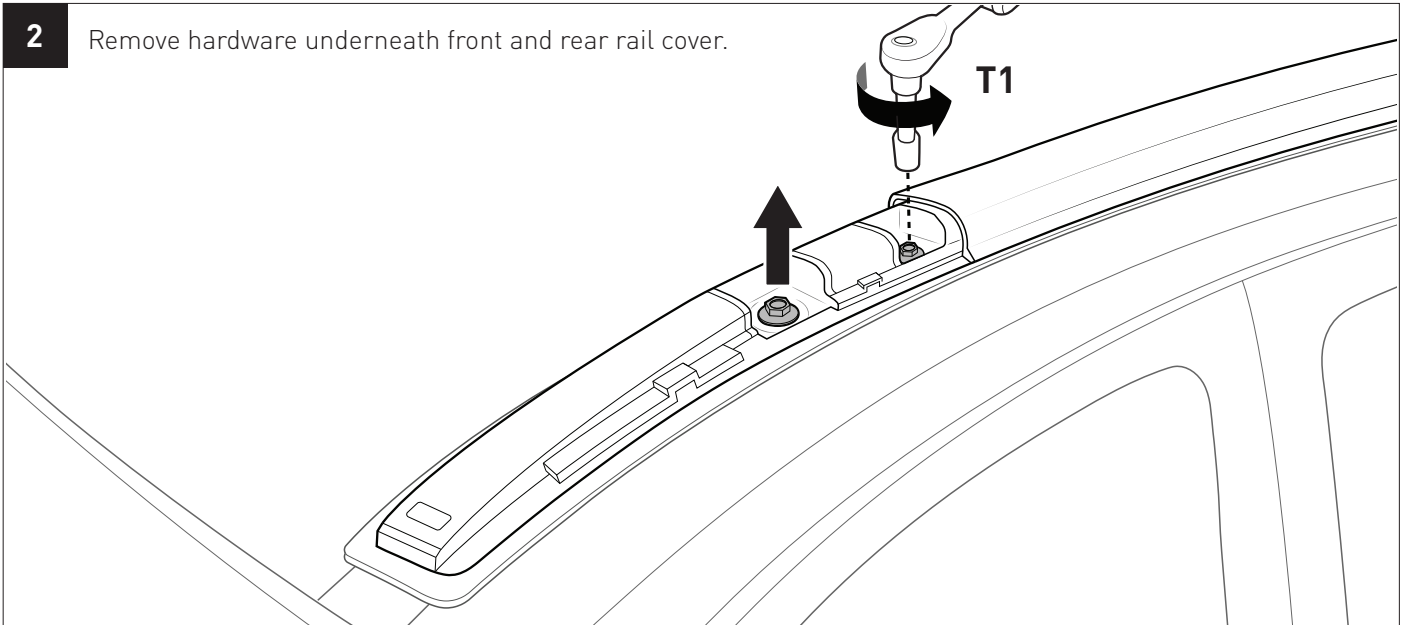

- 3** Remove the two middle rail covers. Use masking tape to protect edge.

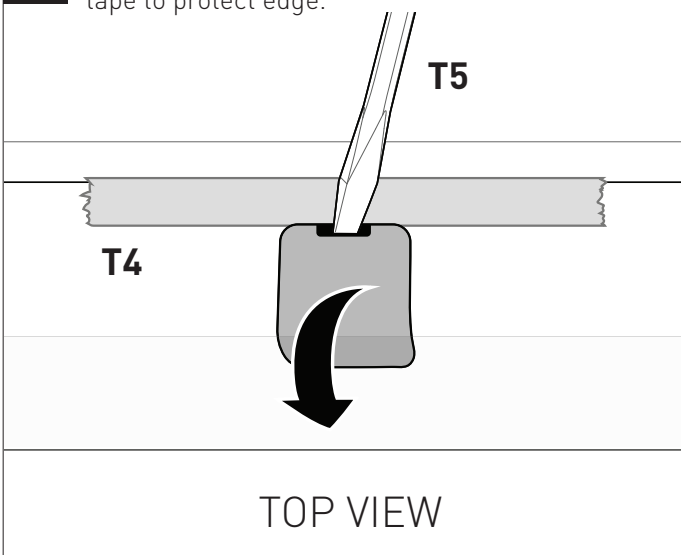

- 4** Loosen socket head cap screws fully.

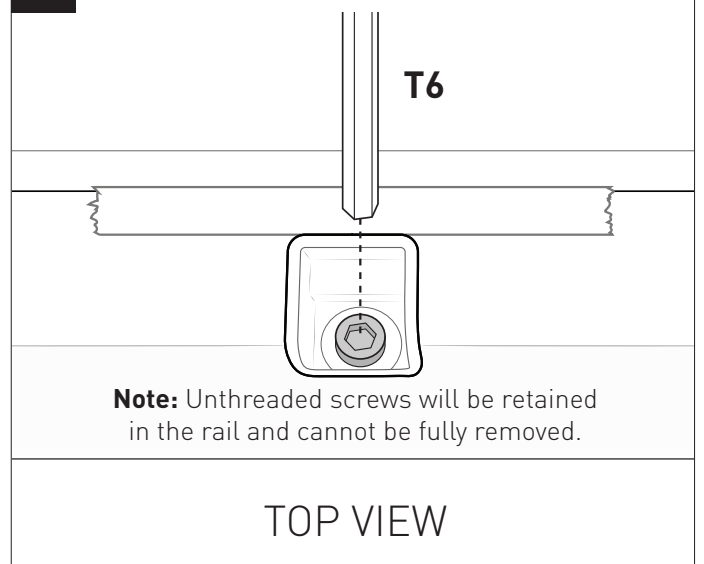

- 5** Remove entire rail by lifting vertically.

Note: Store rail, rail hardware and rail covers in a safe place.

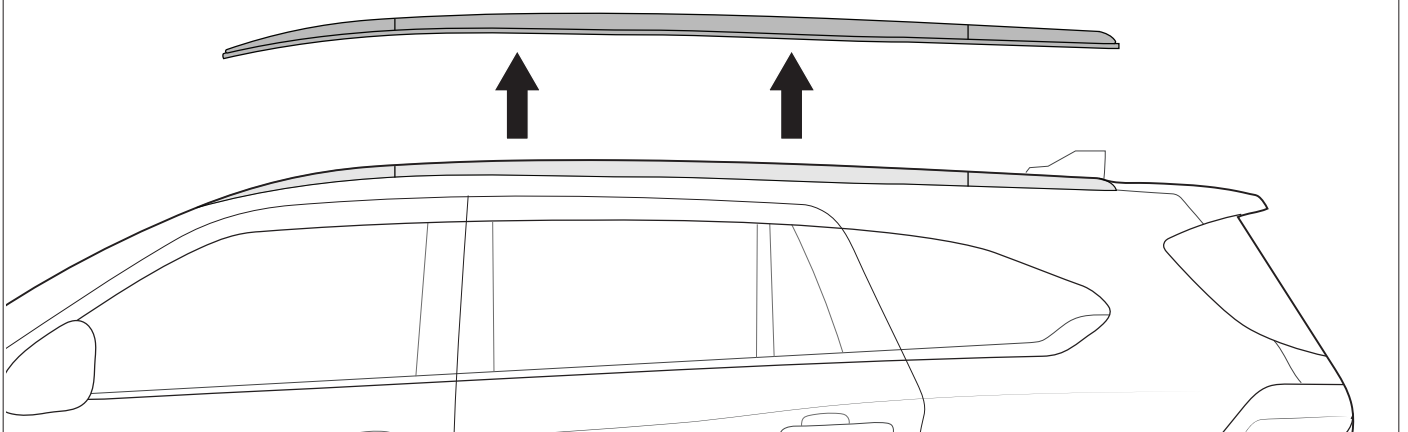

RIMB2 Backbone Instructions

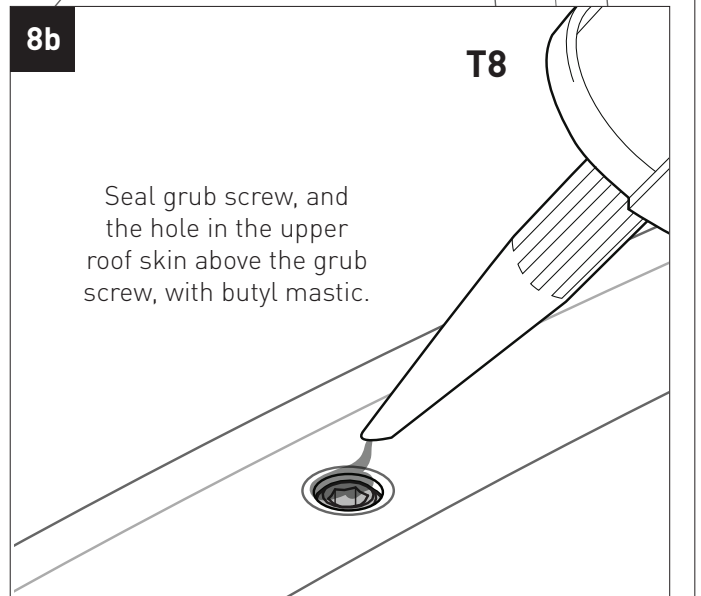
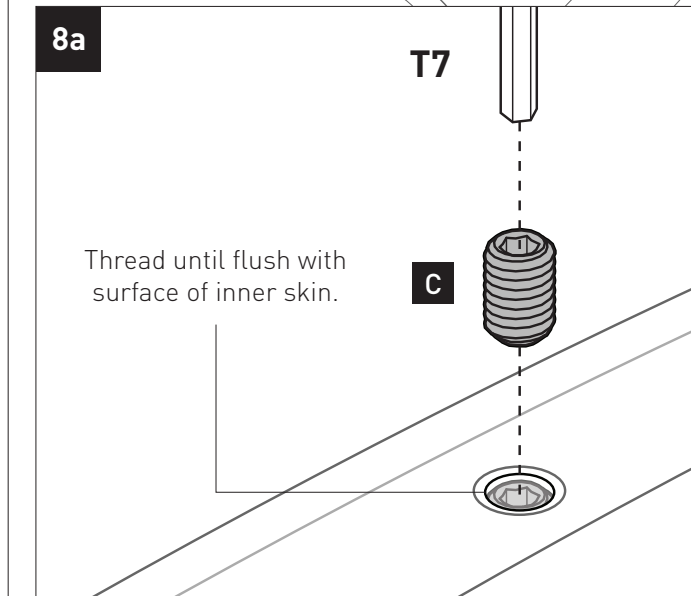
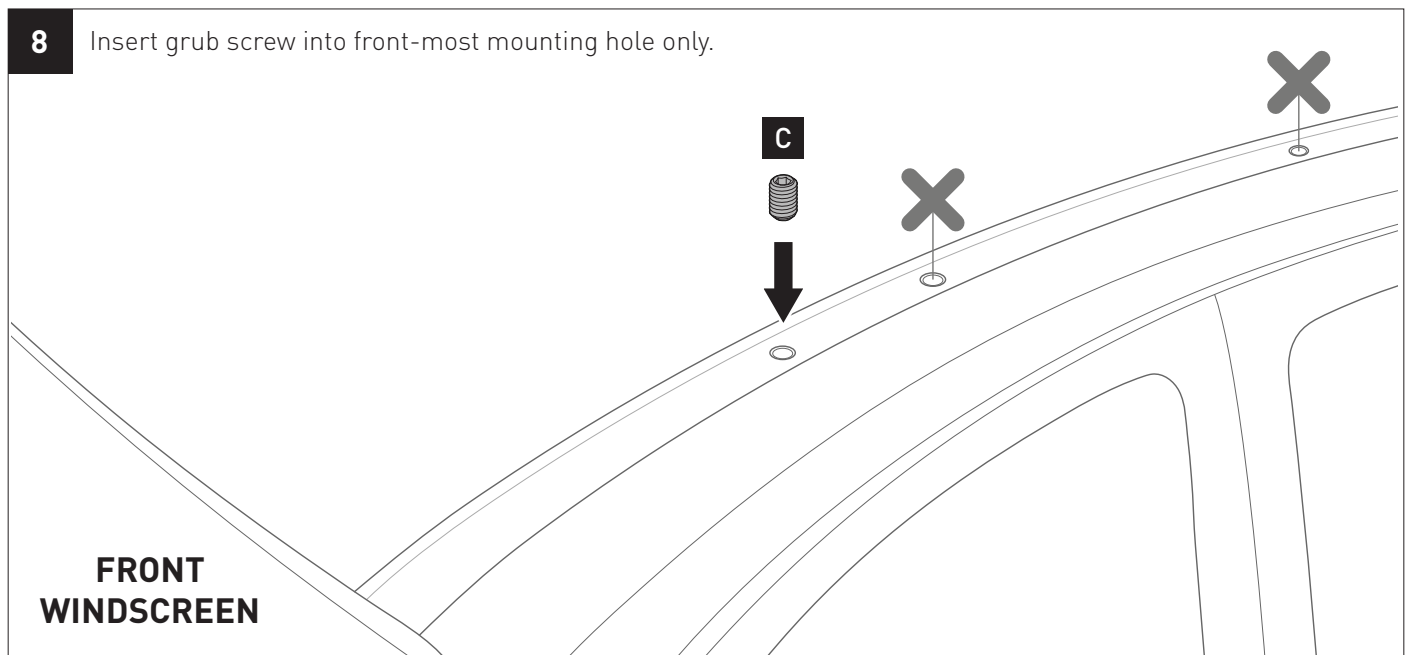
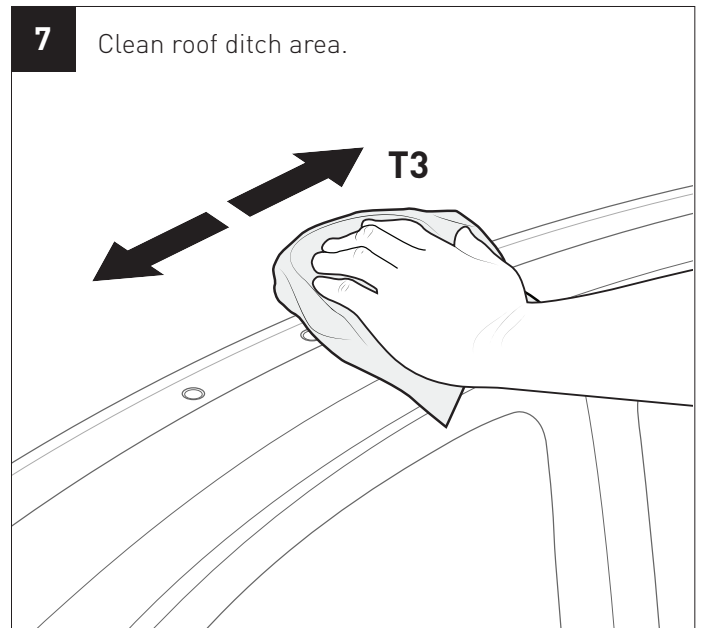
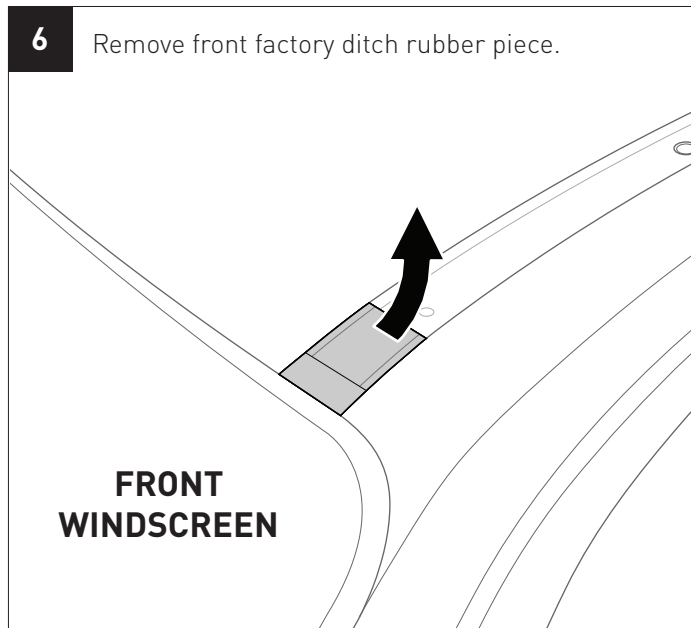

BARE ROOF VARIANT (For **Factory Rail Variant**, skip to Step **13**)

9 Remove factory ditch rubber.

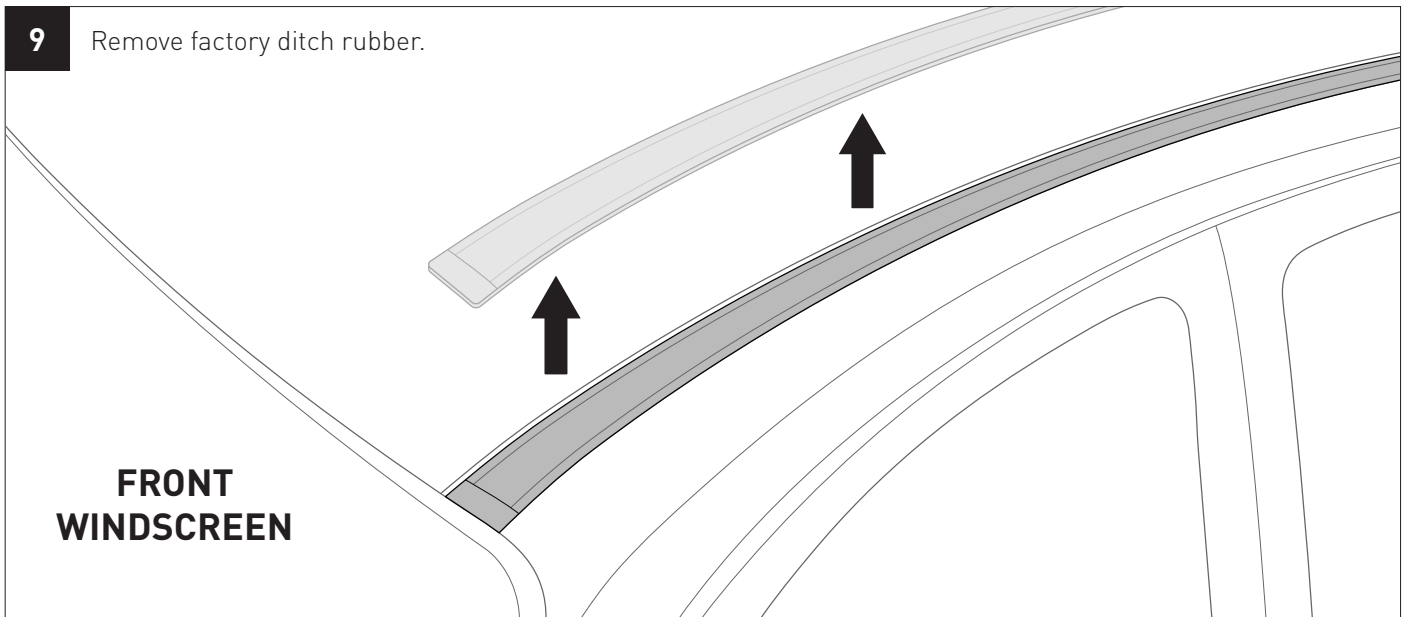

10 Peel off any remaining ditch rubber tape.

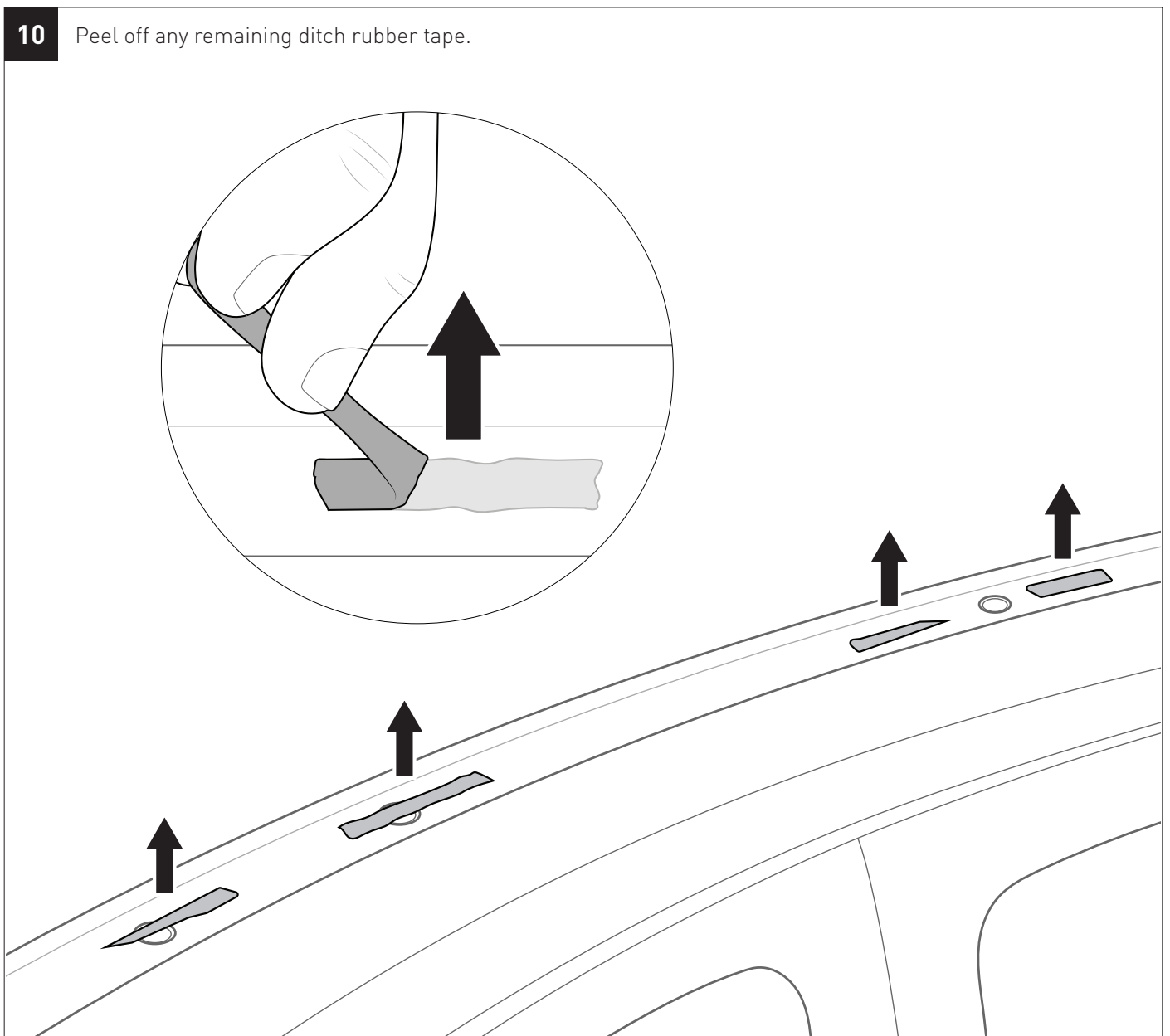

11 Locate circular indents in the ditch.

NOTE:
Do not remove infill from the front-most hole.



Use a screwdriver to dig out a circular hole through the factory infill on each mounting location.

5 per side.

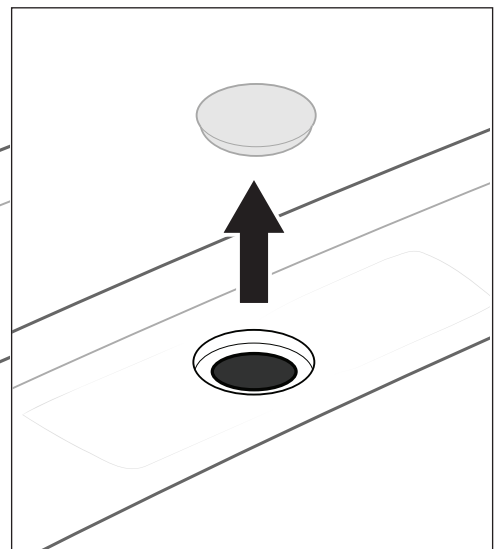
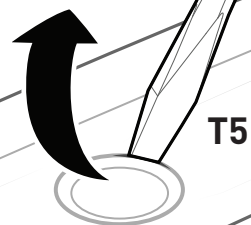

12 Clean roof ditch area.

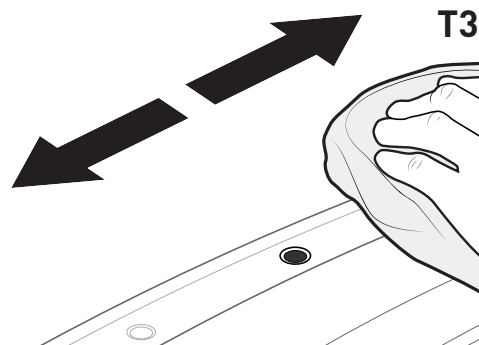

FRONT

13 Mark dimensions onto ditch surface, measuring from the edge of the rear plastic cover.

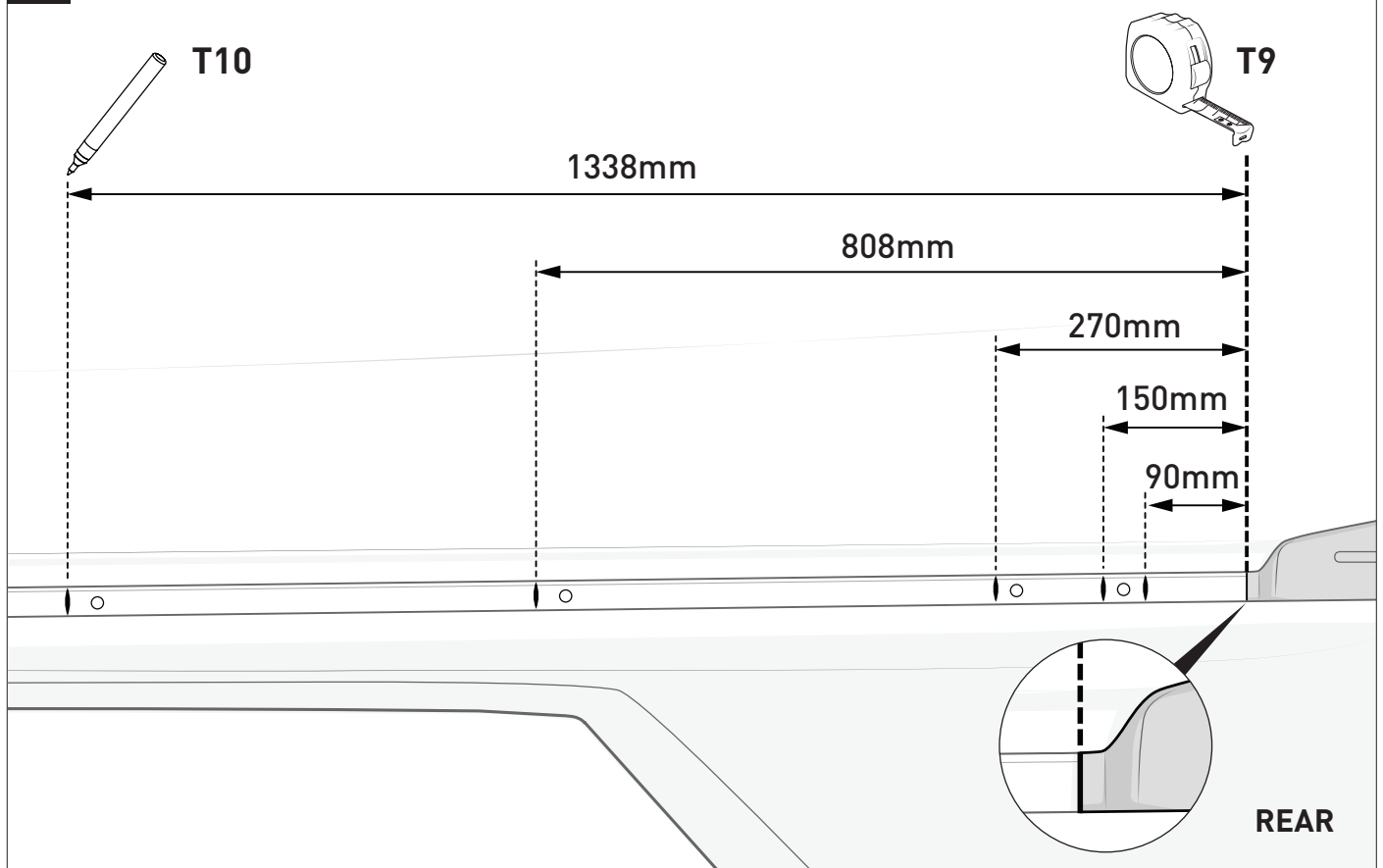

14 Cut Ditch Rubber to the dimensions specified.

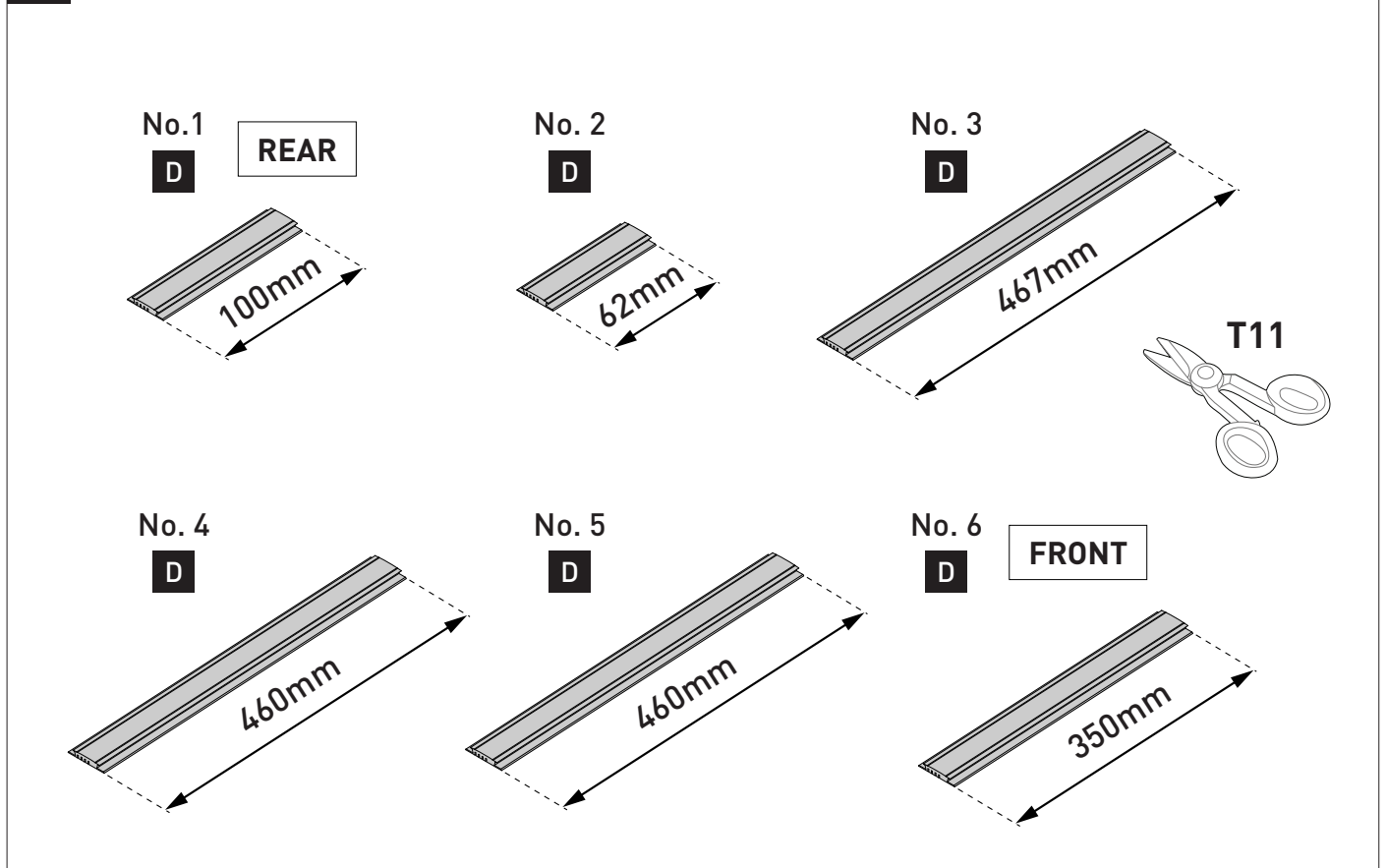

15 Position the trimmed Ditch Rubber strips next to the ditch, and cross check each corresponding dimension.

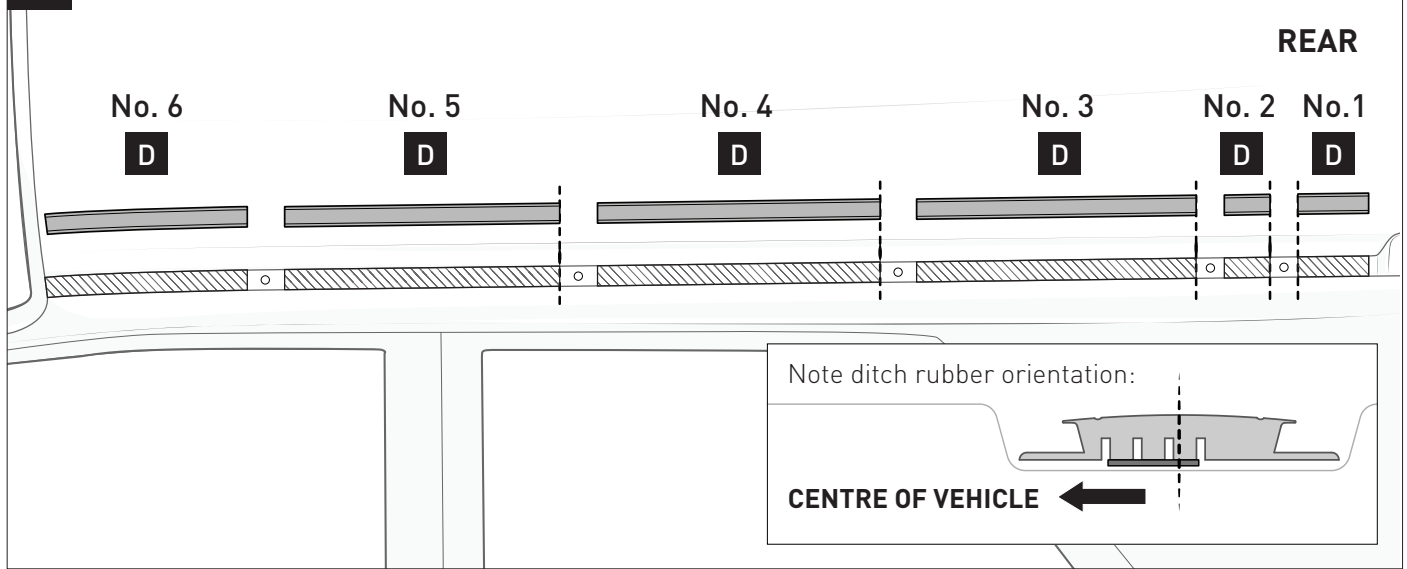

16 Adhere the ditch rubber strips with the markings made in Step **13**. Refer window below for the front rubber position.

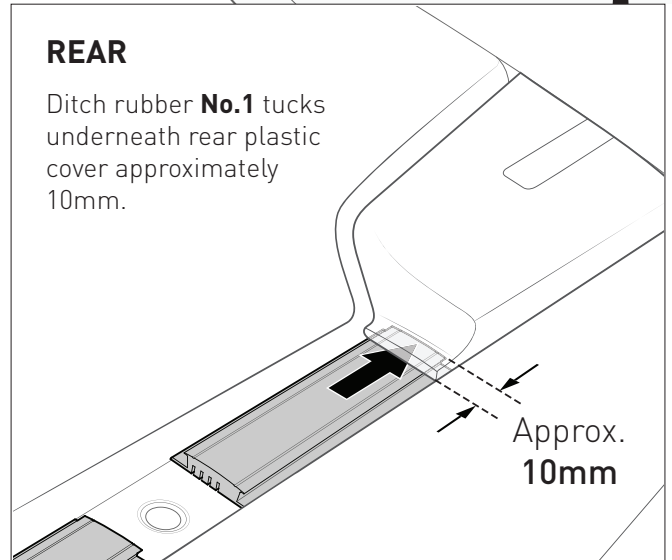
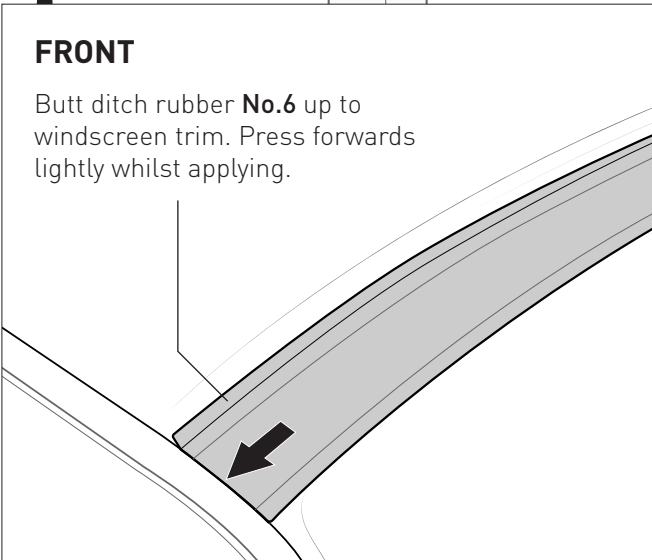
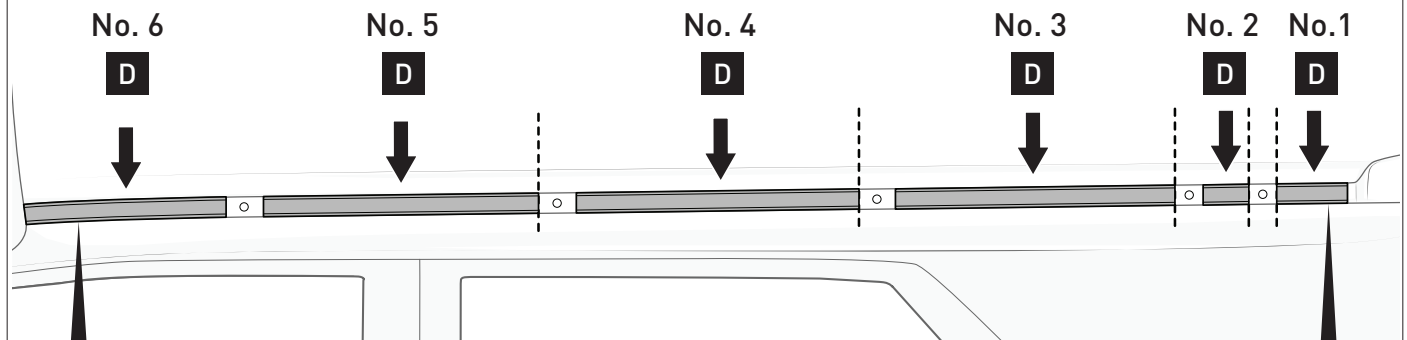
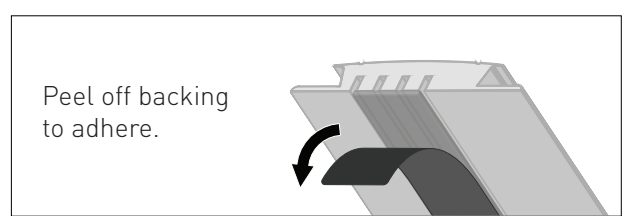

17

17a Peel off the underside of the backing tape.

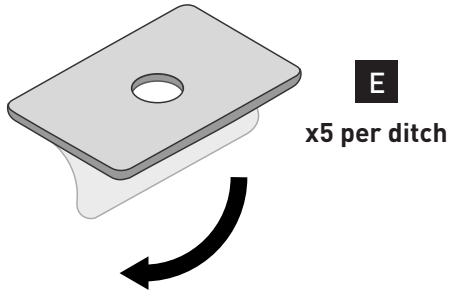

17b Place over the top of the exposed factory holes. Remove the top layer of backing.

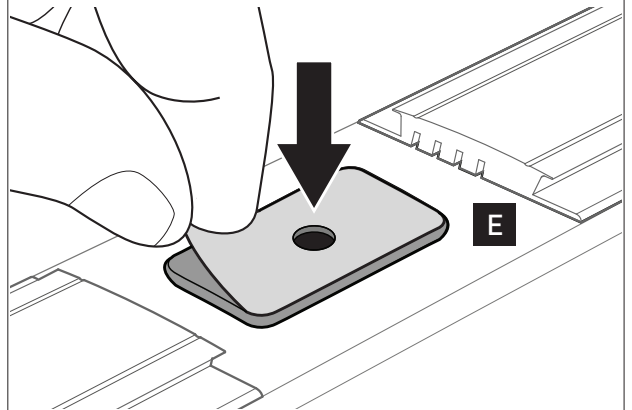

FRONT

REAR



18

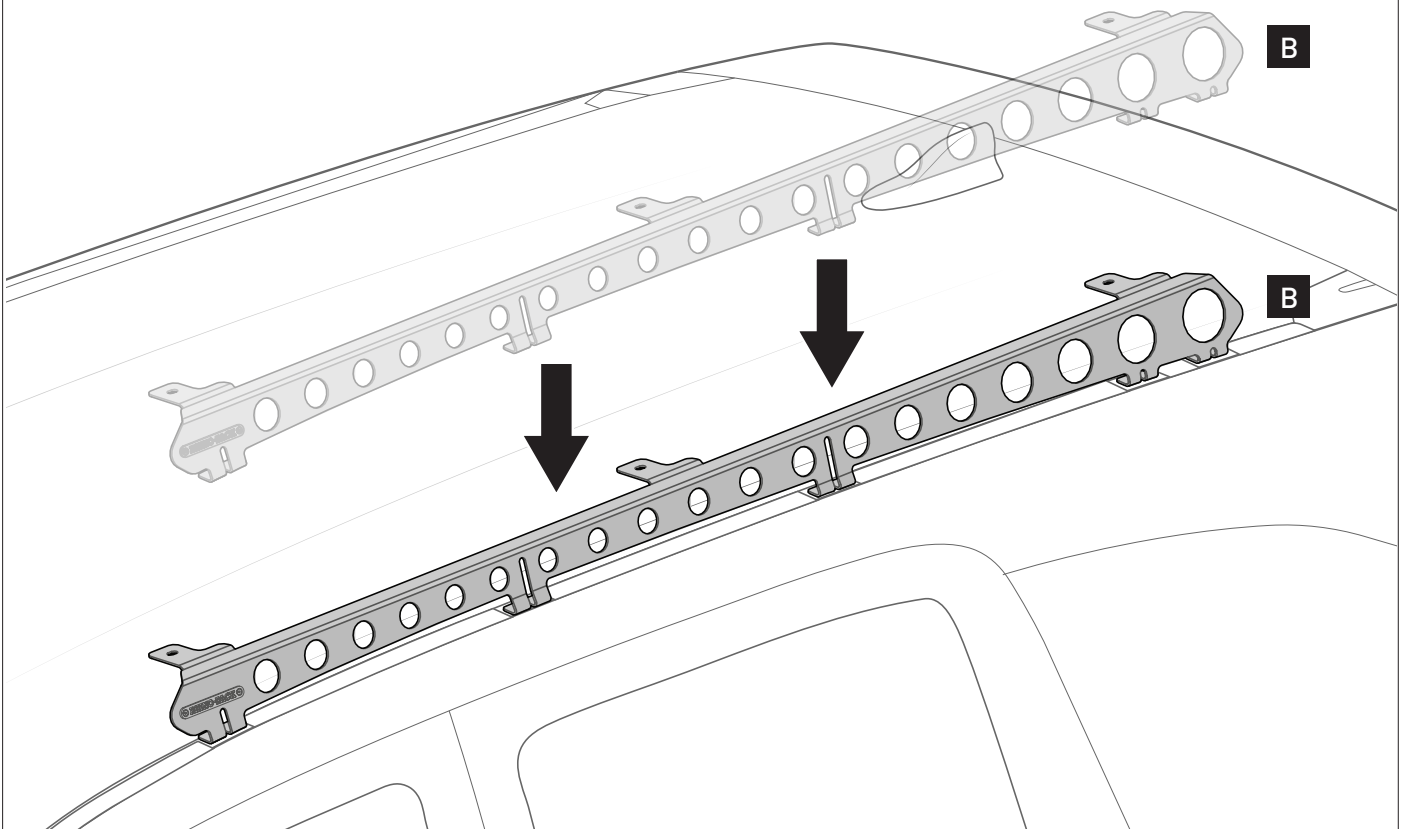

19 Assemble hardware on front three legs. Start each screw.

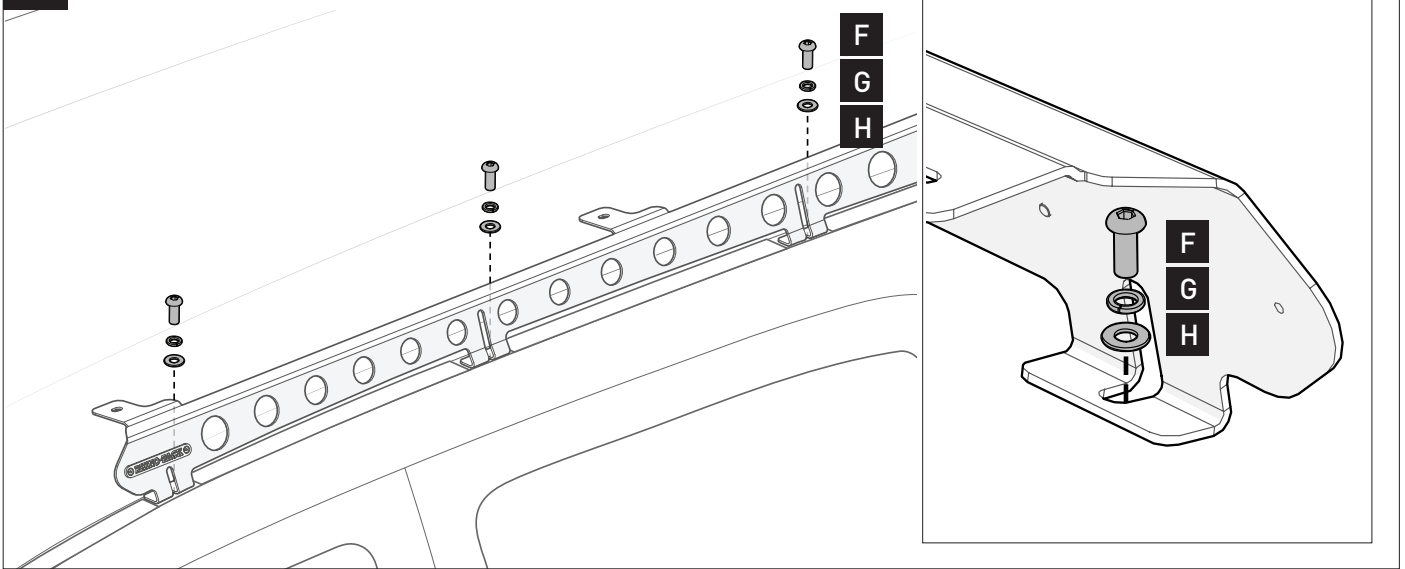

20 Assemble hardware on rear two legs. Start each screw.

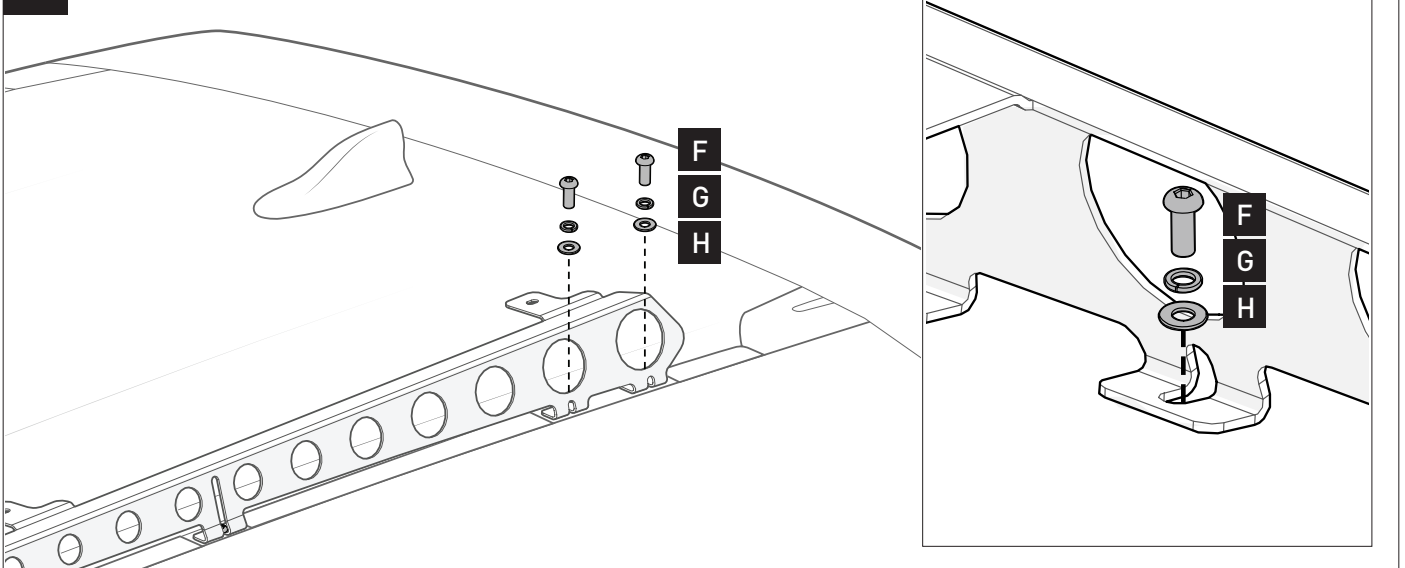

21 Incrementally tighten all hardware **starting with front three screws**, and finishing with rear two screws.

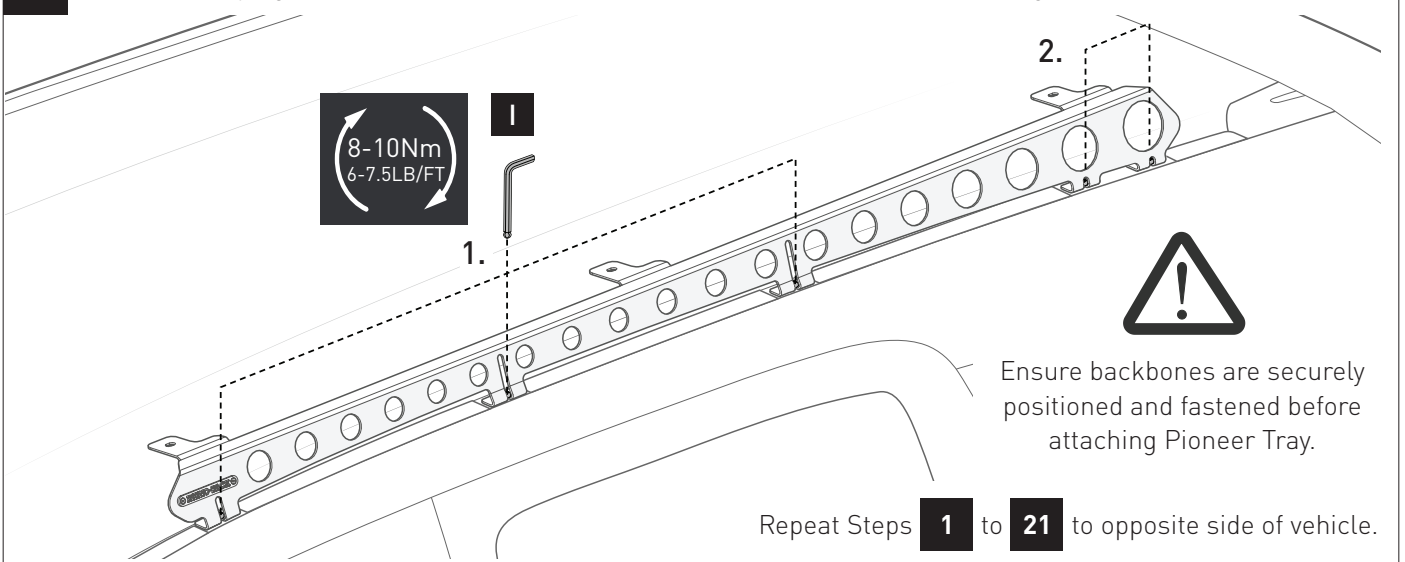

22 PLATFORM INSTALLATION



rhinorack.com/roof

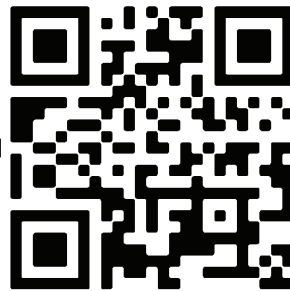

EXAMPLE ONLY

RHINO-RACK | PIONEER VEHICLE FITTING INFORMATION

| VEHICLE | MODEL | YEAR | LOADING | WEIGHT DISTRIBUTION |
|-----------|-----------|-----------|-----------|---------------------|
| 2018-2020 | 2018-2020 | 2018-2020 | 2018-2020 | 2018-2020 |

SEEK THE ONLINE FITTING CHART FOR YOUR VEHICLE. ALWAYS USE THE ONLINE FITTING CHART TO DETERMINE THE CORRECT BAR SPACING.

USE THE VEHICLE MANUFACTURER'S SPECIFIED ROOF LOAD LIMIT (RLL) IF LOWER THAN THE PROVIDED LIMITS.

$96 \text{ Kg} + 24 \text{ Kg} = 120 \text{ Kg}$
 $212 \text{ lbs} + 53 \text{ lbs} = 265 \text{ lbs}$

VEHICLE MANUFACTURER'S ROOF LOAD LIMIT

UNDERBAR SPACING

| BAR NO. | A | B | C | D | E | F | G |
|------------------|---|---|---|---|---|---|---|
| UNDERBAR SPACING | | | | | | | |
| CONNECTOR | | | | | | | |

View Fitting Chart

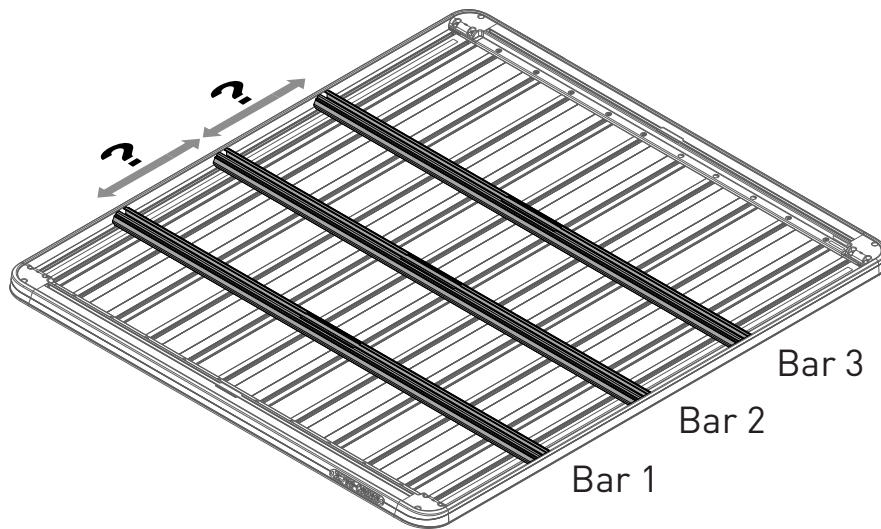

23 For 5XXXX Series Platform

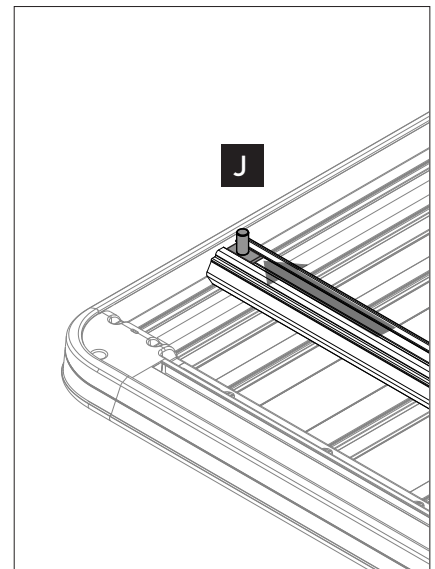
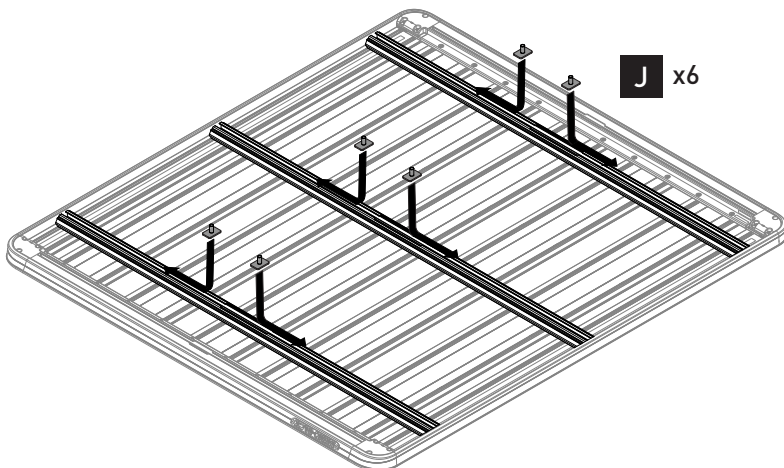

24 For 5XXXX Series Platform

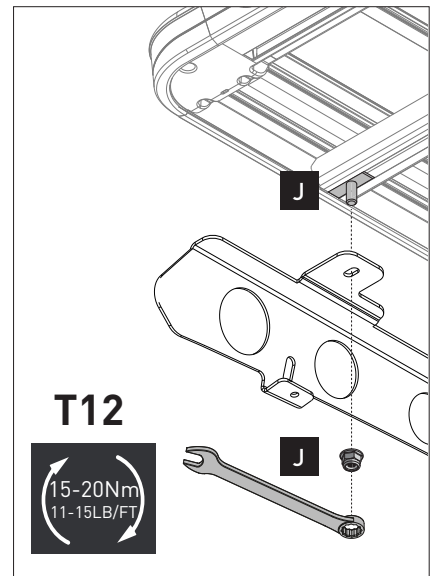
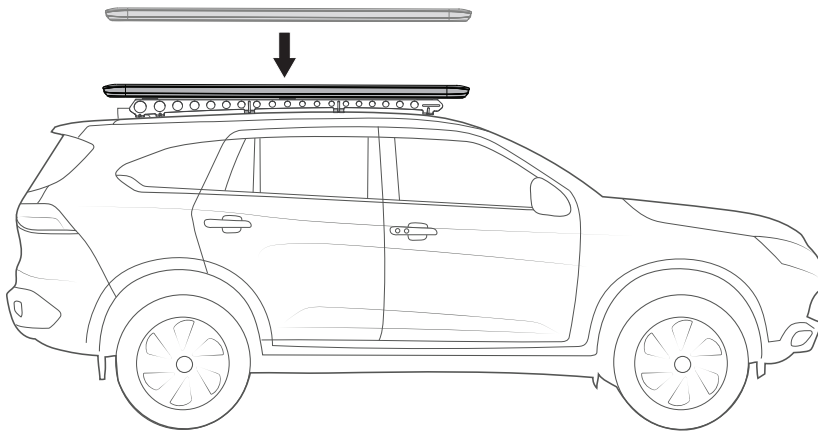

25 For 4XXXX Series Platform

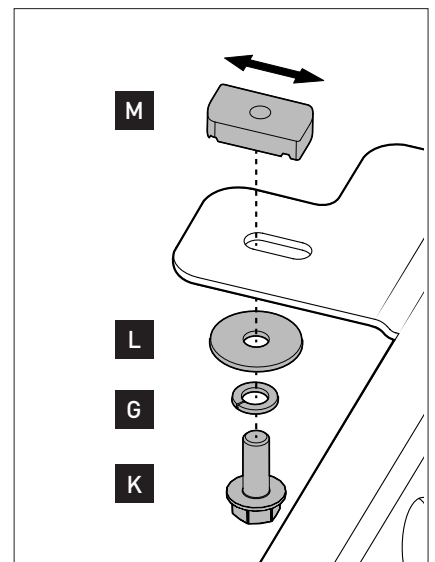
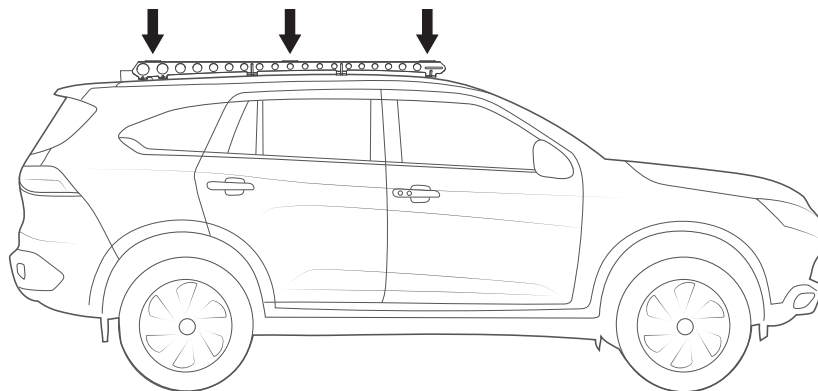

26 For 4XXXX Series Platform

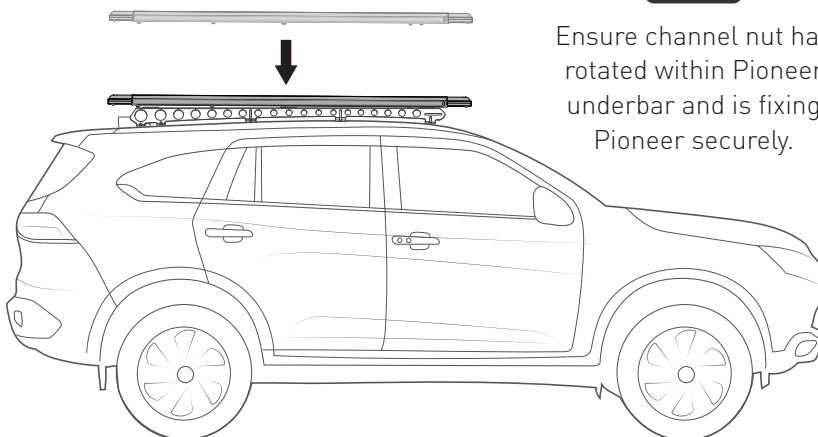

Ensure channel nut has rotated within Pioneer underbar and is fixing Pioneer securely.

