

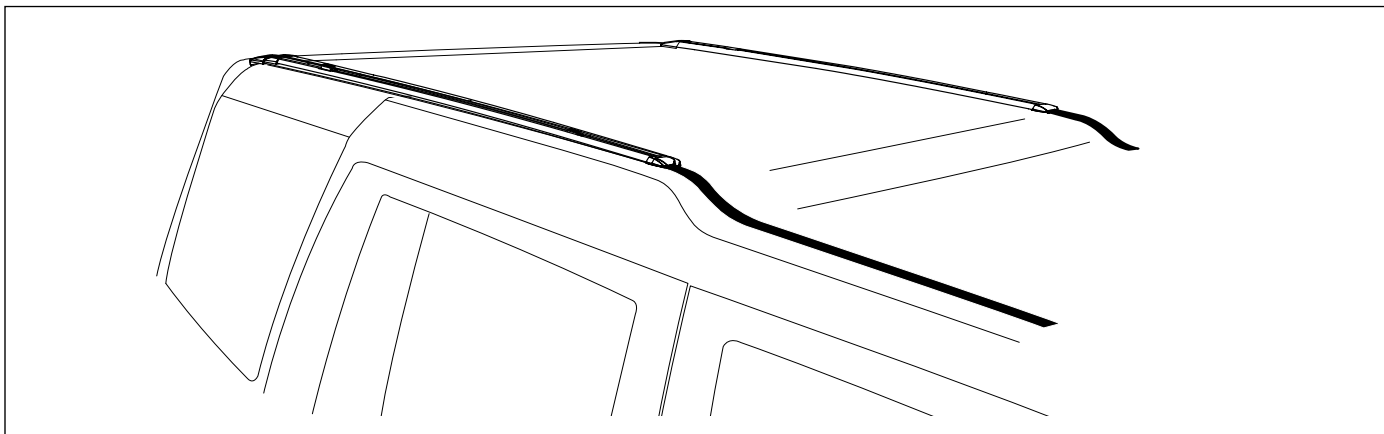

# RHINO-RACK

Aerodynamic & Heavy Duty Roof Rack Systems

## Rhino Tracks RTS502 - Land Rover - Discovery 3, Discovery 4. - LR3, LR4.



**Important:** Please read these instructions carefully prior to installation.  
Please refer to your fitting instruction to ensure that the roof racks are installed in the correct locations.  
Check the contents of kit before commencing fitment and report any discrepancies.  
Place these instructions in the vehicle's glove box after installation is complete.

### Important Information

**Warning:** Do not fit rear cross bar behind the rear M6 track attachment screw unless rear of the track is riveted to the roof, refer page 5 for fitting info.

**Maximum carrying capacity:** 75kg/165lbs evenly distributed over the cross bars. Please refer to your vehicle manufacturers handbook for maximum roof loading. Always use lower of the two figures.

#### Recommendations:

It is essential that all bolt connections be checked after driving a short distance when you first install your cross bars. Bolt connections should be checked again at regular intervals (probably once a week is enough, depending on road conditions, usage, loads and distances travelled). You should also check the cross bars each time they are refitted. Make sure to fasten your load securely. Please ensure that all loads are evenly distributed and that the centre of gravity is kept as low as possible.

#### Use only non-stretch fastening ropes or straps:

**Caution:** The handling characteristics of the vehicle changes when you transport a load on the roof. For safety reasons we recommend you exercise extreme care when transporting wind-resistant loads. Special consideration must be taken into account when cornering and braking.

**Please remove cross bars when putting vehicle through an automatic car wash.**

#### Load Ratings:

Maximum permissible load is 75kg/165lbs per pair of cross bars (include the weight of the cross bars, 5kg/11lbs). When cross bars are to be used in off-road conditions, please build a safety factor of 1.5 into this load limit, 50kg/110lbs for off-road use. Although the roof racks are tested and approved to AS1235-2000, off-road road conditions can be much more rigorous. However, increasing the number of cross bars does not increase the vehicles maximum permissible roof loading.

#### Note for Dealers and Fitters:

It is your responsibility to ensure instructions are given to the end user or client.

Rhino-Rack  
3 Pike Street, Rydalmere,  
NSW 2116, Australia.  
(Ph) (02) 9638 4744  
(Fax) (02) 9638 4822

Document No: RR-140  
Prepared By: Craig Jones  
Authorised By: Gary England

Issue No: 03  
Issue Date: 06/09/2010

These instructions remain the property of Rhino-Rack Pty Ltd and may not be used or changed for any other purpose than intended.



# Rhino Tracks RTS502

## Parts List

Item	Component Name	Qty	Part No.
1	M6 x 20m security screw	6	B062
2	M6 spring Washer	6	W004
3	M6 x 12mm flat washer	6	W003
4	M6 x 16mm flat washer	4	W031
5	M6 foam backed washer	4	C461
6	10G self tapping screw	2	B083
7	5mm rivet	2	H007
8	End cap FL (front left)	1	M253
9	End cap FR (front right)	1	M254
10	End cap RL (rear left)	1	M255
11	End cap RR (rear right)	1	M256
12	5mm security allen key	1	H021
13	Track extrusion RIGHT	1	A314RH
14	Track extrusion LEFT	1	A314LH
15	Fitting Instruction	1	RR140

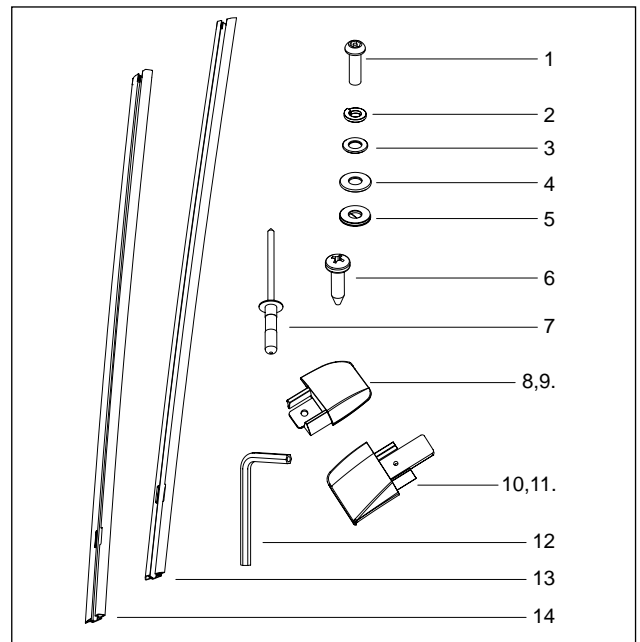

### Care Instruction:

Clean vehicle roof prior to fitting Rhino tracks, especially roof channel where the tracks are to be fitted.

### Tools required:

Marking pen.  
5mm security allen key, provided in kit.  
Flat head screw driver.  
Phillips head screw driver.  
Pneumatic or concertina rivet gun.  
Power drill.  
5mm drill bit.

Drill stop.  
Measuring tape.  
Hacksaw.  
Cold Galvanising paint.  
Butyl mastic sealer.  
Vacuum cleaner.

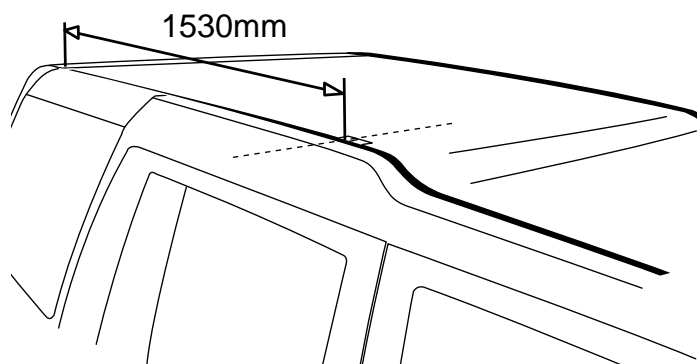
**1**

- Measure 1530mm from rear of roof channel strip then mark a line on the strip.
- Remove channel strip.
- Cut strip at mark using a hacksaw.
- Clip the front piece of strip (shorter piece) back into the channel.
- Repeat for opposite side.

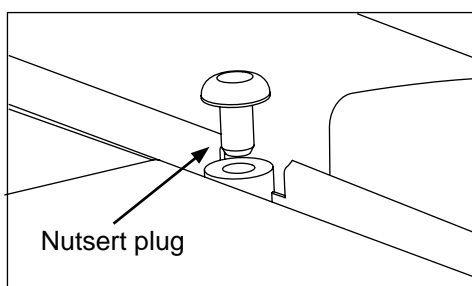
**2**

Using a flat head screwdriver lever out the plastic plugs in the roof channel. This will expose the nutserts which the track fastens to.

**DO NOT REMOVE THE WHOLE BOSS.**



# Rhino Tracks RTS502

3

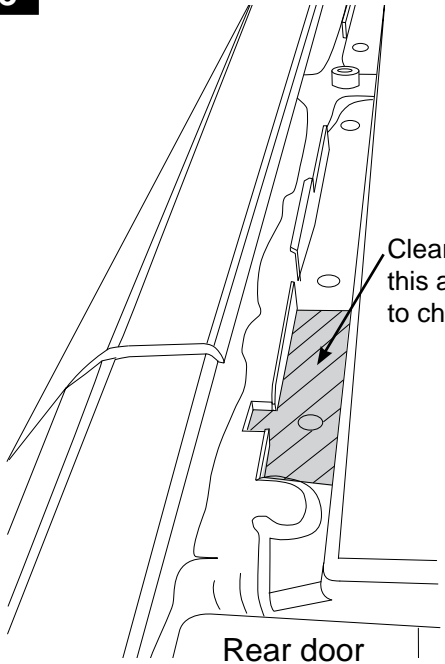

Clear drip-check from this area. Fit end cap to check.

Rear door

Remove all drip-check at the rear where the end cap sits. Rear end cap must sit down onto the roof channel surface.  
Cold Galvanise paint the area where drip-check has been removed.

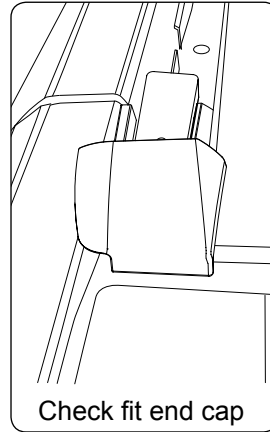

Check fit end cap

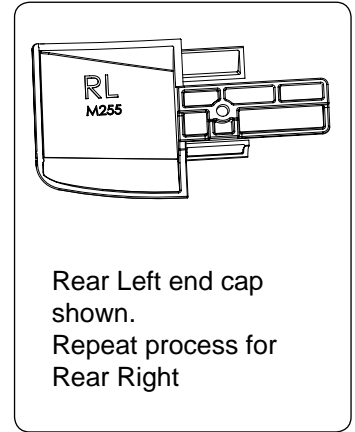

Rear Left end cap shown.  
Repeat process for Rear Right

4

Front end caps  
FR & FL.

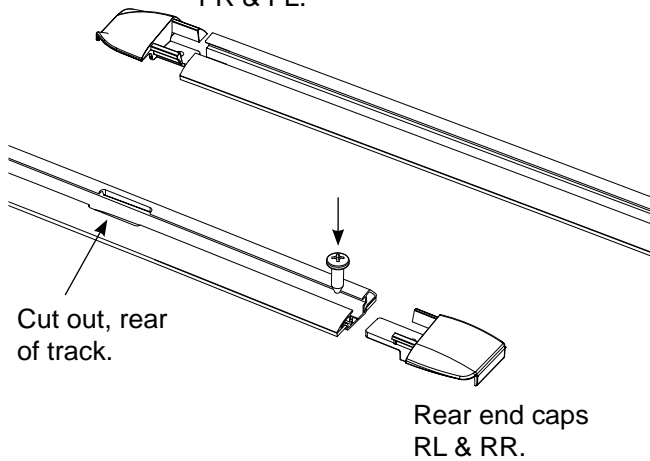

Cut out, rear of track.

Rear end caps  
RL & RR.

Insert end caps into the tracks.

RR = Rear Right  
RL = Rear Left  
FR = Front Right  
FL = Front Left

Rear of track has the cutout.

**Rear end caps only.** Screw the self-tapping screw through the track and into the end caps prior to fitting the tracks.

**Refer notes on page 5, for riveting the rear end caps to the roof channel. For use with extended loads.**

5

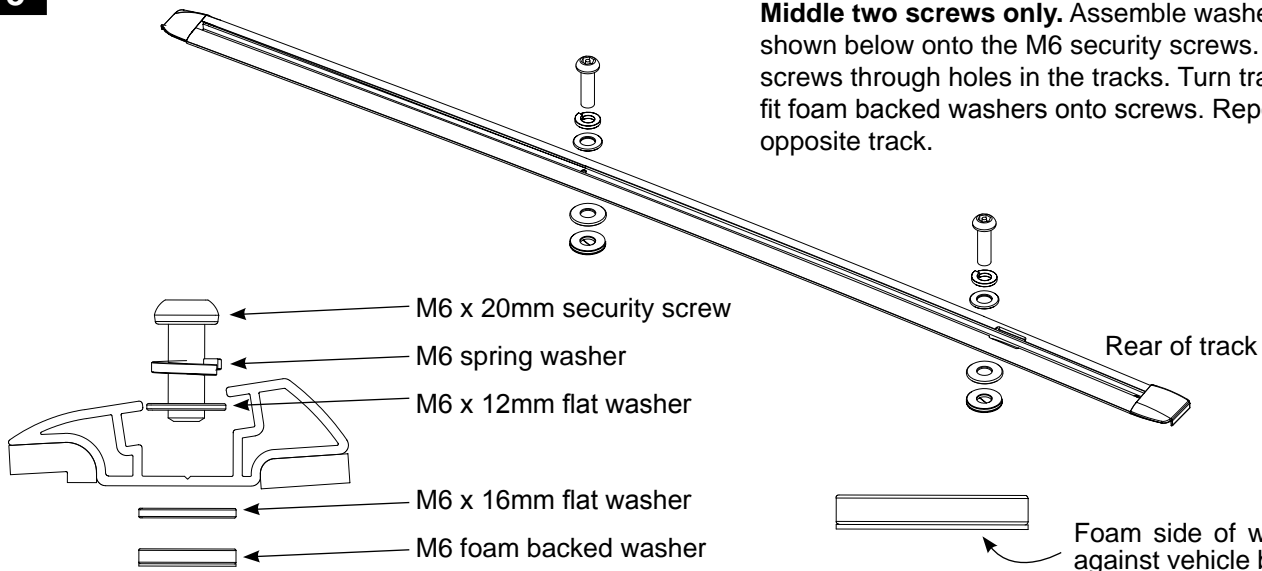

M6 x 20mm security screw

M6 spring washer

M6 x 12mm flat washer

M6 x 16mm flat washer

M6 foam backed washer

Rear of track

Foam side of washer against vehicle body

**Middle two screws only.** Assemble washers as shown below onto the M6 security screws. Place screws through holes in the tracks. Turn track over, fit foam backed washers onto screws. Repeat for opposite track.



## Rhino Tracks RTS502

- 6** Rear end caps only. Apply Butyl mastic to underside of end cap, prior to fitting the tracks. Peel white backing strips off tracks.

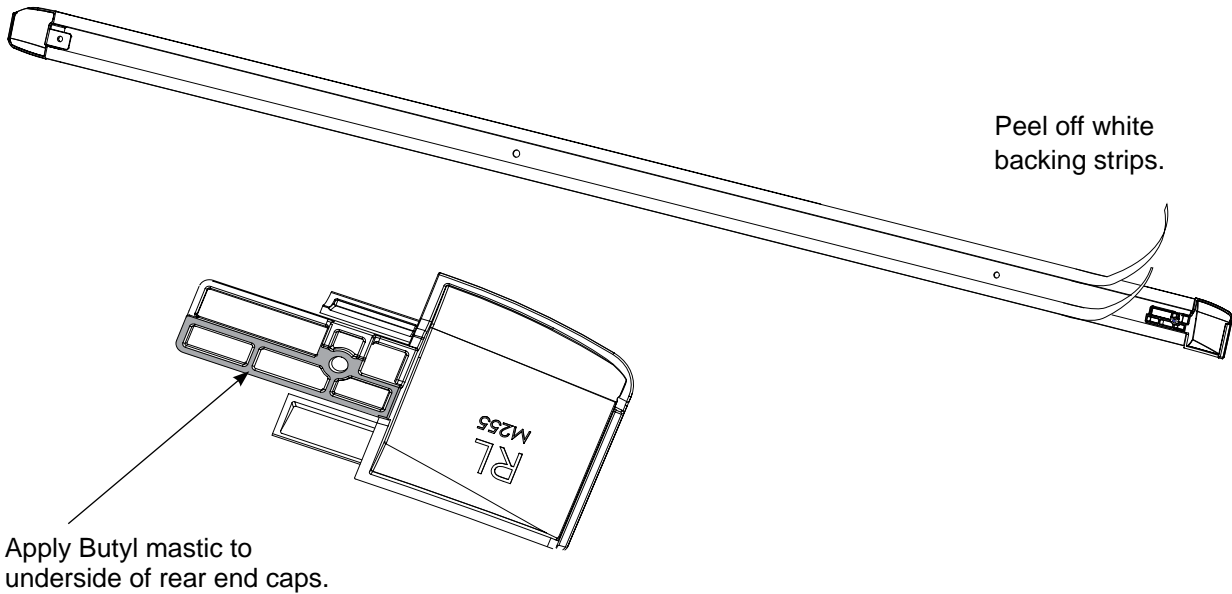

- 7** Place tracks into roof channels, narrow edge to outside of vehicle. Assemble the spring and flat washer onto the M6 x 20mm security screw. Locate through front hole in track and fasten to roof nutserts, leave loose at this stage. Engage the middle and rear screws into the remaining nutserts. Progressively tighten all three screws. **Tighten to 3-4Nm / 26-35lb.in.** Repeat for opposite side.

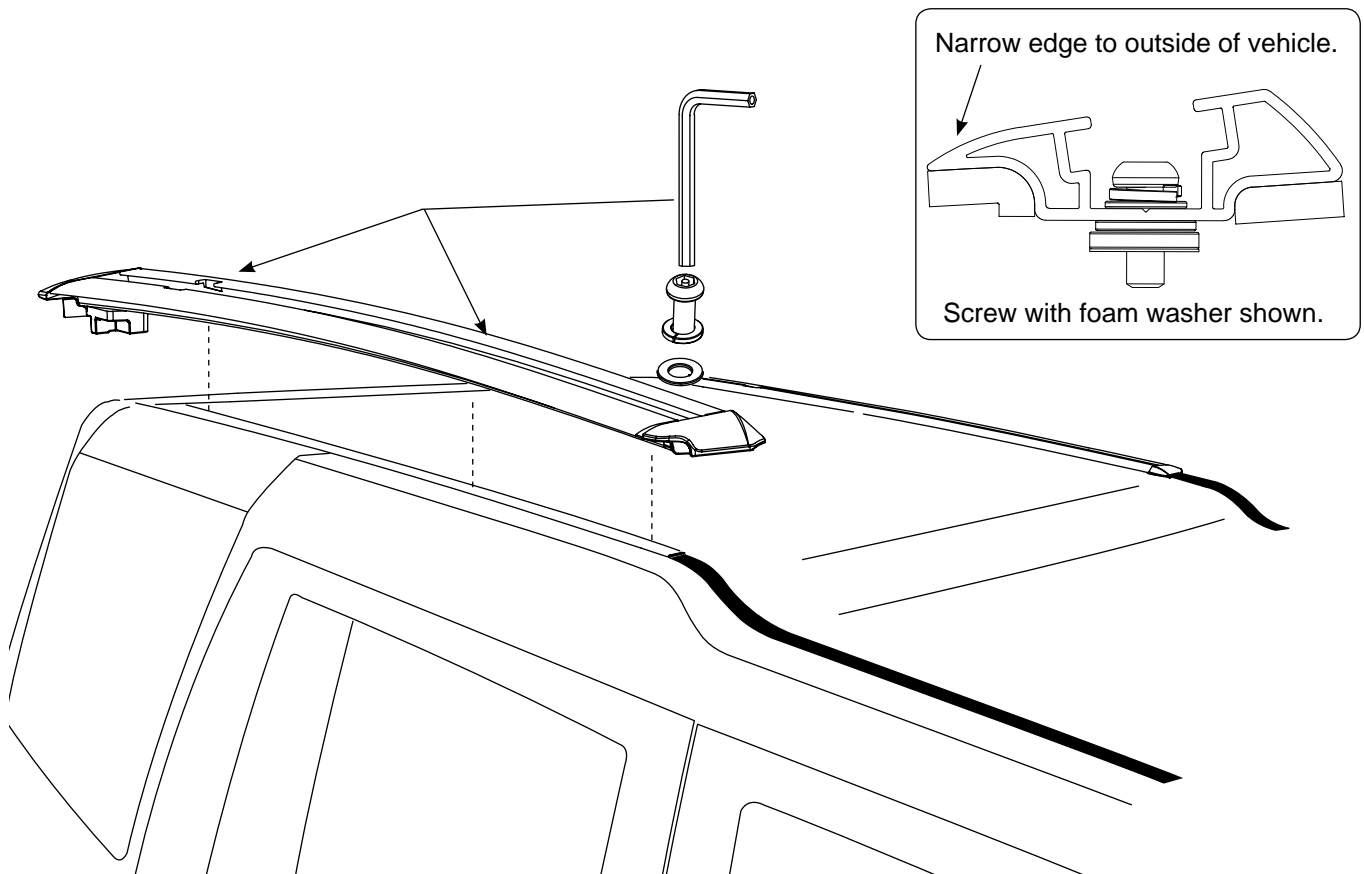



## Rhino Tracks RTS502

### ADDITIONAL INSTRUCTION FOR RIVETING REAR OF TRACK.

Riveting is required when a cross bar is to be fitted rearward of the last mounting screw.  
Accessories which require this attachment are the boat loader and large roof trays.

8

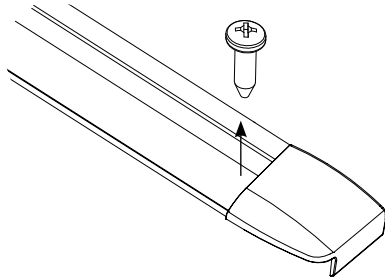

If previously installed, remove self tapping screw from the rear end cap.

9

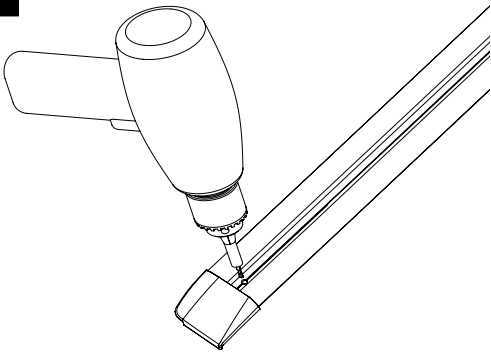

Using a 5mm drill bit, drill through the track and end cap to mark the roof channel.

10

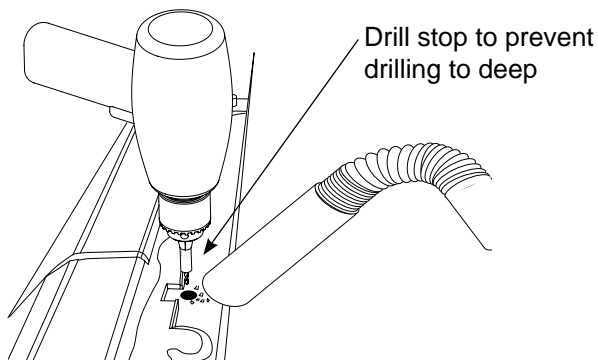

Remove the track. Drill through the roof channel at the mark. Use drill stop to prevent drilling to deep. Set the stop so approximately 5mm of drill tip shows, adjust depth if necessary.  
Vacuum swarf out of the roof channel to minimise scratching.

11

Apply Butyl Mastic sealant liberally around the drilled hole and on base of end cap.

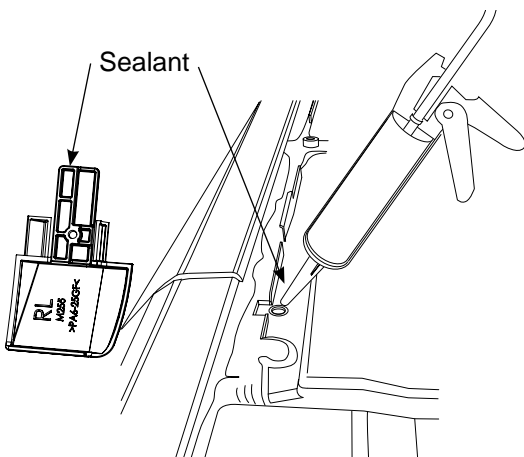

12

Place the track into roof channel. Insert all screws as previously instructed. Insert the rivet through track and end cap. Secure the rivet using a pop rivet gun or pneumatic rivet gun. Repeat steps for opposite track.

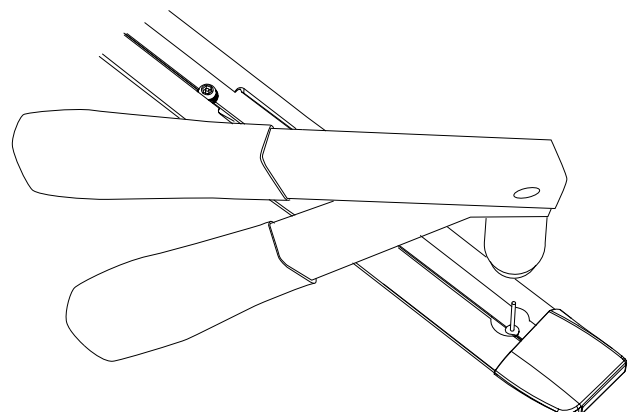



**RHINO-RACK**  
Aerodynamic & Heavy Duty Roof Rack Systems

## Rhino-Rack Track Mount System Supplement

**Important :** Please read these instructions carefully prior to installation.  
Place these instructions in the vehicle's glove box after installation is complete.

**Do not use N009 Brass Nuts supplied with RLTP or RLTF legs**

**Use the N036 Brass Nuts supplied separately with this kit**

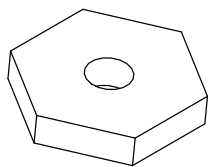

**N009**

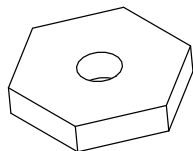

**N036**

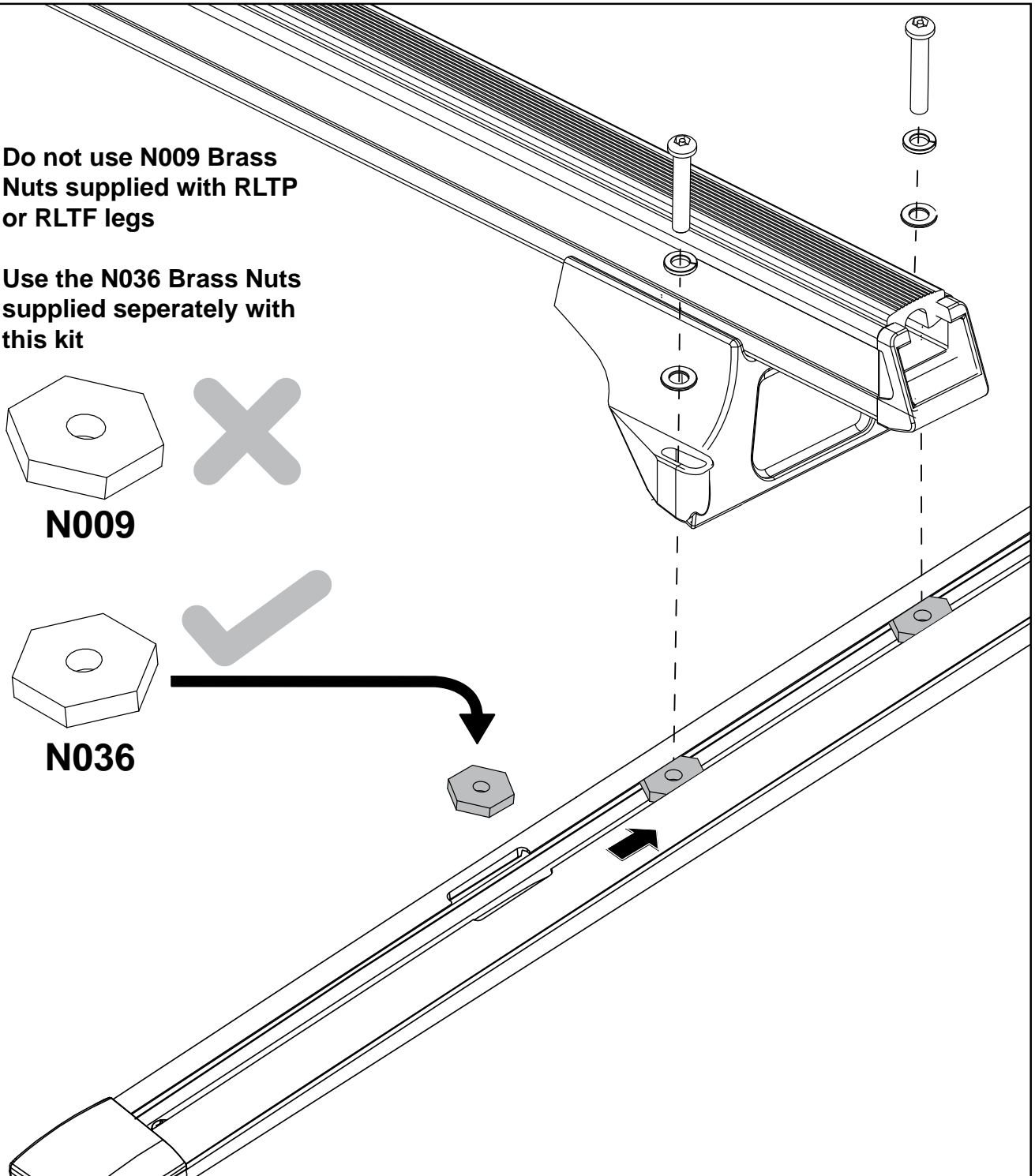

Rhino-Rack  
3 Pike Street, Rydalmere,  
NSW 2116, Australia.  
(Ph) (02) 9638 4744  
(Fax) (02) 9638 4822

Issue No: RR253  
Prepared By: Andy Wana  
Authorised By: Gary England

Issue No: 01  
Issue Date: 23/06/2010

These instructions remain the property of Rhino-Rack Australia Pty Ltd and may not be used or changed for any other purpose than intended.