

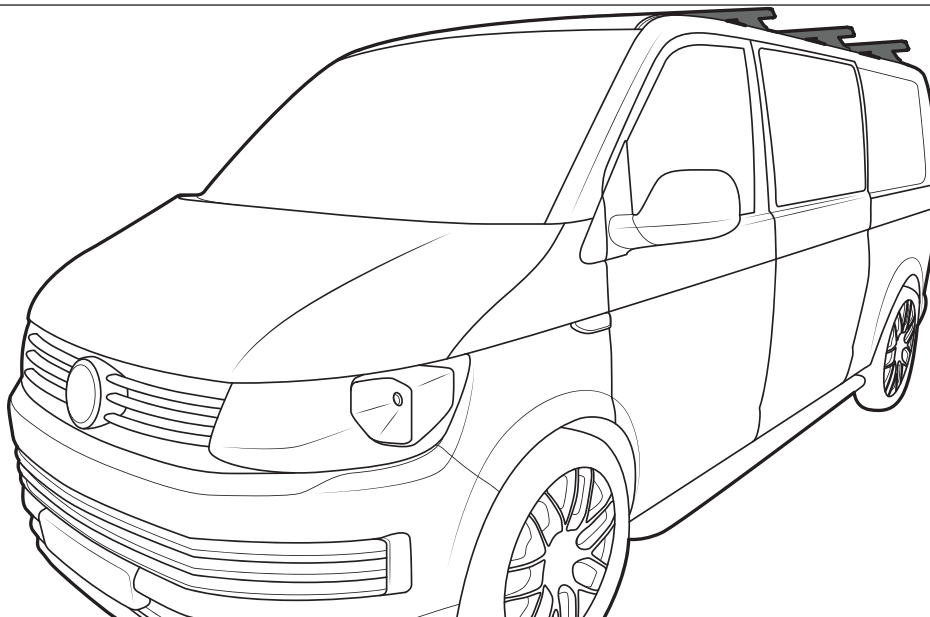

RHINO-RACK

Volkswagen Transporter T6 RLT600 Crossbar Fitment

- Important:**
- ☐ 1. Please refer to your fitting instruction to ensure that the roof racks are installed in the correct locations.
 - ☐ 2. Check the contents of kit before commencing fitment and report any discrepancies.
 - ☐ 3. Place these instructions in the vehicle's glove box after installation is complete.
 - ☐ 5. These instructions must be followed for warranty to be upheld.



Important Information

Maximum carrying capacity: (100kg/220lbs)

Please refer to your vehicle manufacturers handbook for maximum carrying capacity of your roof racks. Always use the lower of the two figures. Load must be evenly distributed over the crossbars. Maximum permissible load is 100kg (220lbs) (including the weight of the roof bars, 5kg). When roof racks are to be used in off-road conditions, please build a safety factor of 1.5 into this load limit and reduce the load limit to 66kg (145lbs). Although the roof racks are tested and approved to AS1235-2000, Australian road conditions can be much more rigorous. However, increasing the number of crossbars does not increase the vehicles maximum permissible roof loading.

Do not attempt to fit the crossbars to your vehicle unless you fully understand this fitting instructions. Please direct any questions regarding fitting to the dealer from where the kit was purchased. **Use only non-stretch fastening ropes or straps.**

Recommendations:

It is essential that all bolt connections be checked after driving a short distance when you first install your roof racks. Bolt connections should be checked again at regular intervals (once a week is enough, depending on road conditions, usage, loads and distances travelled). You should also check the roof racks each time they are re-fitted. Always make sure to fasten your load securely. Please also ensure that all loads are evenly distributed and that the centre of gravity is kept as low as possible. Long loads (e.g. canoes and kayaks) must be secured front and rear with non-stretch fastening ropes or straps.

Roof racks must be removed when putting vehicle through an automatic car wash.

Caution: The handling characteristics of the vehicle changes when you transport a load on the roof. For safety reasons we recommend you exercise extreme care when transporting wind-resistant loads. Special consideration must be taken into account when cornering and braking.

Note for Dealers and Fitters:

It is your responsibility to ensure these fitting instructions are given to the end user or client.

Rhino-Rack

3 Pike Street, Rydalmere,
NSW 2116, Australia.

(Ph) (02) 9638 4744

(Fax) (02) 9638 4822

Document No: R1262

Prepared By: Kayle Everett

Authorised By: Chris Murty

Fit Time: 45min

Issue No: 01

Issue Date: 13/07/2015

These instructions remain the property of Rhino-Rack Australia Pty Ltd and may not be used or changed for any other purpose than intended.



Volkswagen Transporter T6 RLT600 Crossbar Fitment

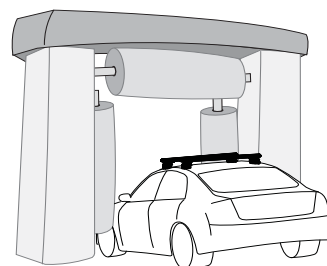
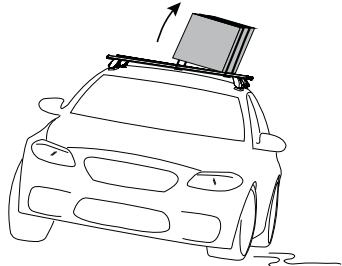
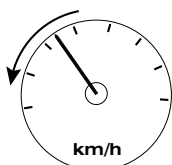
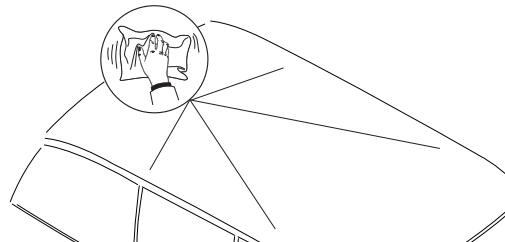
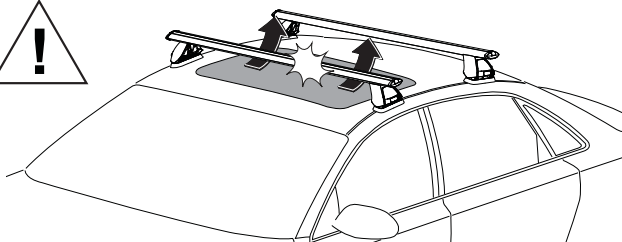
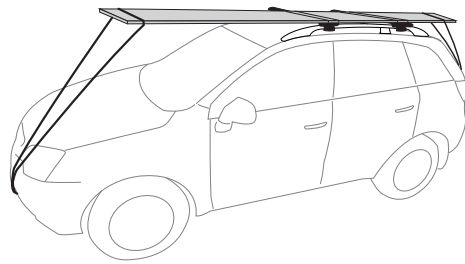
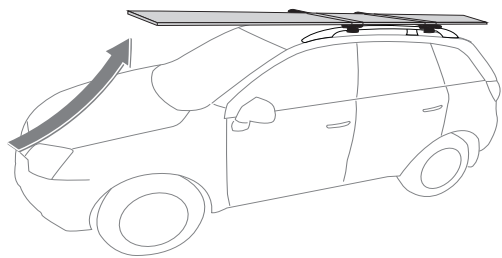

Ensure Ladder is well supported on the ground to help support tent. Take extreme caution when climbing heights above 1.2m/4ft.

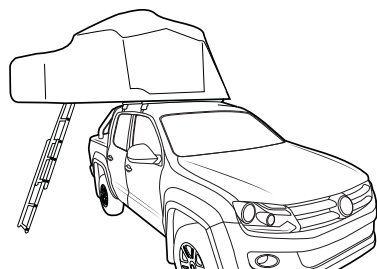

It is required for Clam Shell Roof Top Tents to use a 3 Crossbar System.

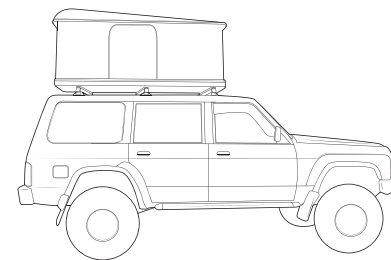

When these roof racks are to be used on a vehicle that is driven off sealed roads, the manufacturer maximum roof load rating (to be found in the vehicles User Manual) should be **divided by 1.5**. Do not forget to subtract the complete crossbar system weight from your maximum carrying capacity.

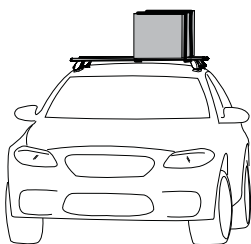

100kg/220lbs
(Urban Road)

=

66kg/145lbs
(Off Road)

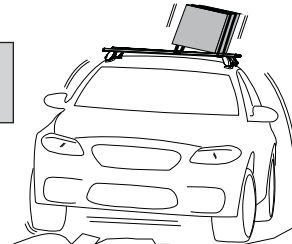

WARNING! Important Load Carrying Instructions

With utility vehicles, the cabin and the canopy move independently. Roof racks and vehicle can be damaged if the item transported is rigidly fixed at points on both the cabin and canopy. Instead, rigidly fix to either the cabin roof racks or the canopy roof racks.

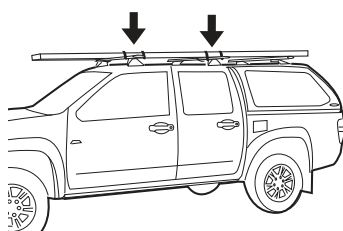
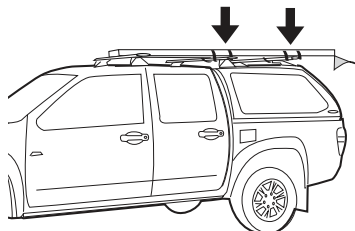

Paddle/ Surfboards should be fixed to the front of the vehicle.

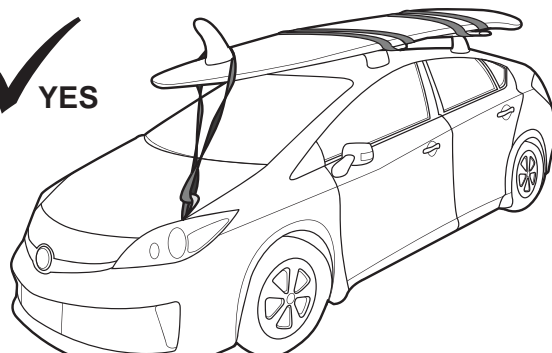



Volkswagen Transporter T6 RLT600 Crossbar Fitment

Instructions

Tools Required: - 5mm security allen key
- Tape measure - Cleaning cloth

Note: All kits are sold as separate. Ensure you have the required kits to complete your fitment.

- 1** Move to the roof of the vehicle and locate the Roof Plugs as shown. Remove carefully with security allen key. LWB Transporter shown. Refer to step 7 for leg height spacer arrangement.

Top View:

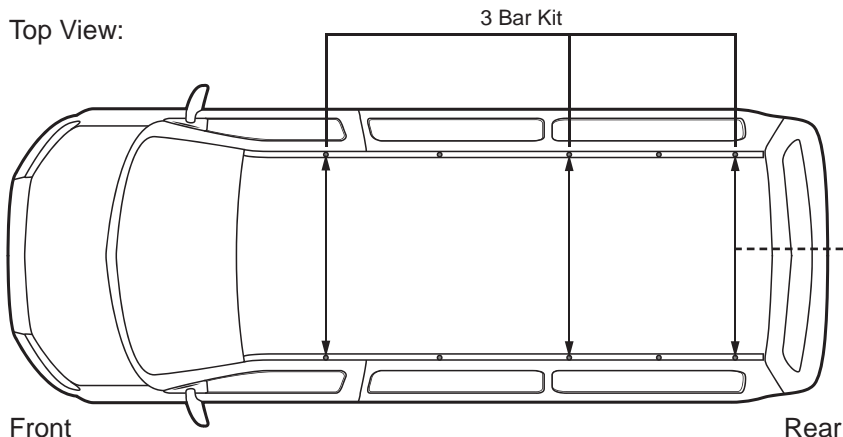

Remove the plugs with 5mm security allen key.

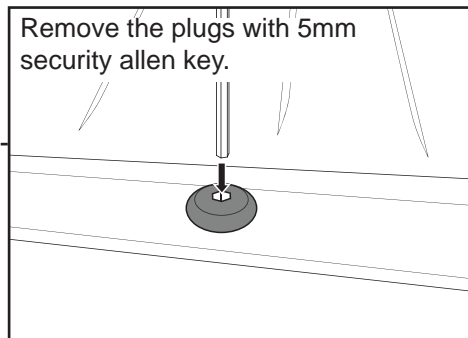

- 2** Clean all dirt and debris out of the roof ditch to enable a positive seal with the butyl patches.

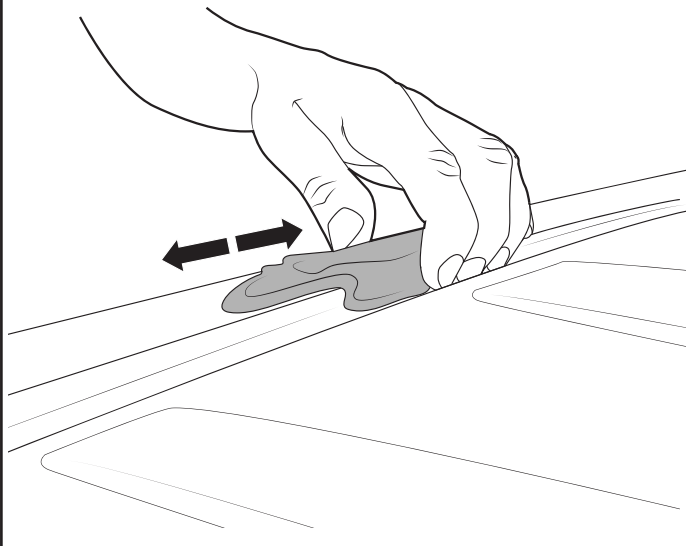

- 3** Apply butyl patches to **ALL** exposed threads. 1: Remove the backing tape from the butyl patch. 2: Place over holes drilled in the roof ditch. 3: Remove tape from top of patches.

1:

A.

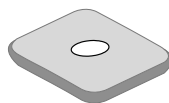

B.



2:

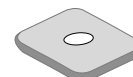

3:

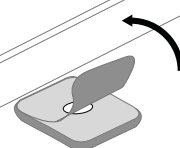

- 4** Fit the rubber bases from the QMFK04 kit to the RLT600 quick mount bases.

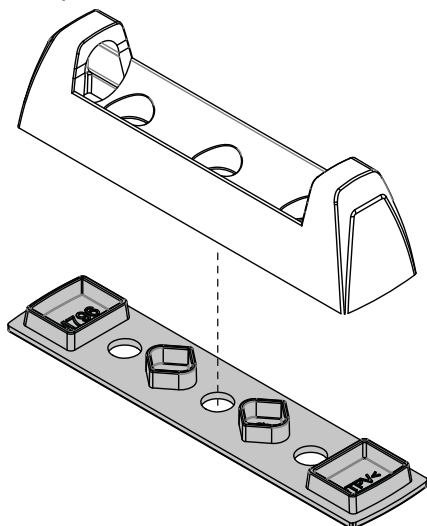

- 5** Place the quick mount base assembly carefully onto the butyl patches. Use the M6 x 25mm security screw from the QMFK04 Kit and the M6 spring and flat washers from the RLT600 Kit to fix the base in place. Tighten all screws with the 5mm security allen key (3-4Nm) provided in the RLT600 kit.

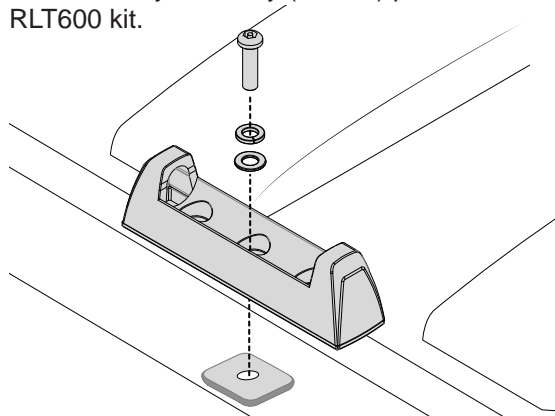



Volkswagen Transporter T6 RLT600 Crossbar Fitment

- 6** Be sure Brackets are parallel across the vehicle. This is required to correctly fit the legs and cross-bars.

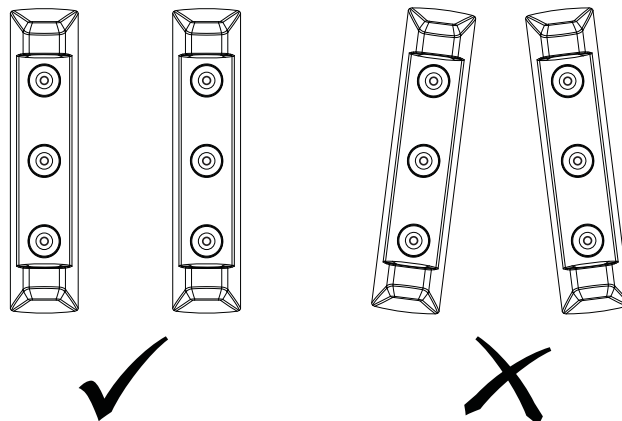

- 7** LWB - Crossbar spacer arrangements for 3 bar Vortex and Heavy Duty systems shown below:

3 Vortex Crossbar Fitment.  QMVA10 N/A  QMVA10

3 Heavy Duty Crossbar Fitment.  QMHD15  QMHD05  QMHD15

