

RHINO-RACK®

Ford Ranger P703 Double Cab

RFRB3

Important:

1. Check the Rhino-Rack website to ensure you have the latest issue of these instructions.
2. Please refer to your fitting instruction to ensure that the accessory is installed in the correctly.
3. Check the contents of kit before commencing fitment and report any discrepancies.
4. Place these instructions in the vehicle's glove box after installation is complete.
5. These instructions must be followed for warranty to be upheld.

Fit Time: 150mins

TWO-PERSON
INSTALLATION

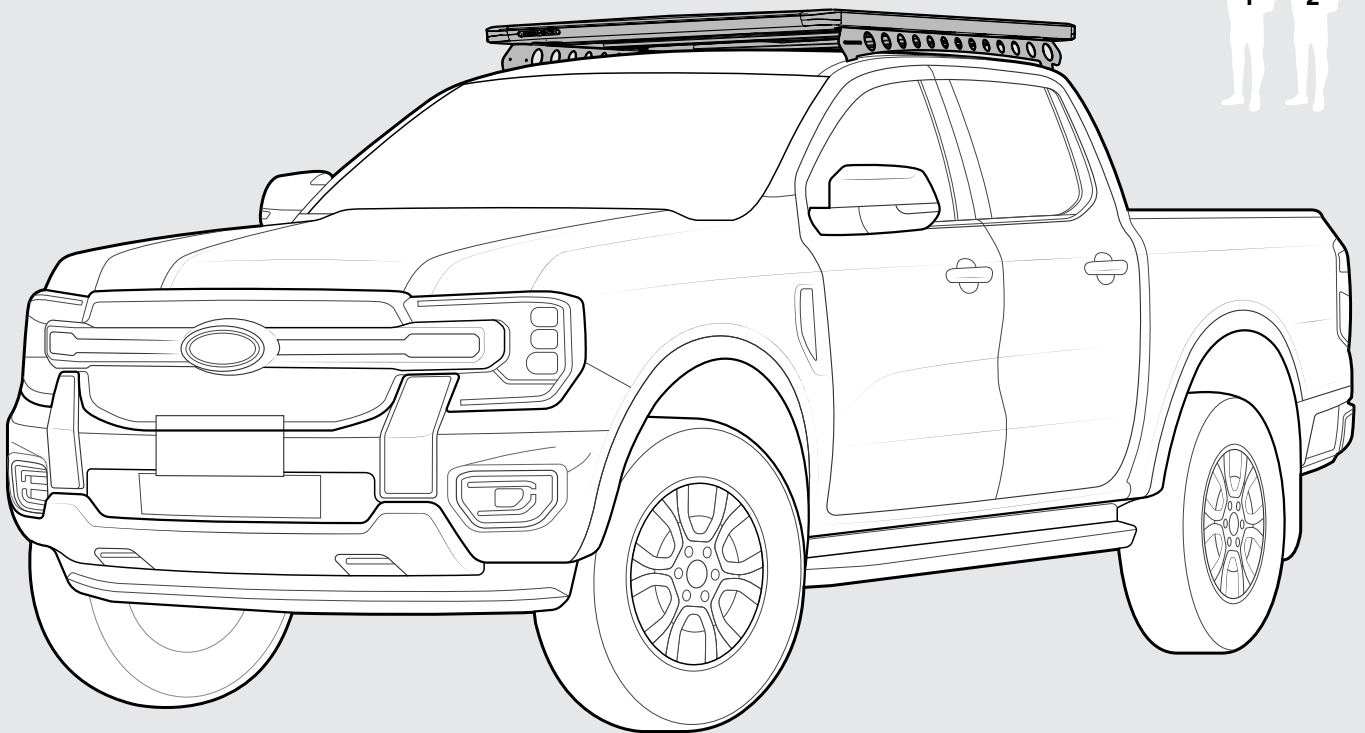

Distribute loads evenly and longitudinally as low as possible over the span.

Avoid point loads concentrated at the front or rear.

Exercise extreme care when transporting wind-resistant loads. Special consideration must be taken when cornering and braking.

Off-road conditions can be much more rigorous. Extreme care must be taken on any driven path that does not contain a surface protection layer (tar/bitumen).

Long flexible loads must attach securely to rigid support and be tied down to the bonnet

Surfboard Overhang > 600mm must be tied to the bonnet

Use only non-stretch fastening ropes or straps to attach cargo to roof racks

Do NOT obstruct windscreen camera sensors

Warranty for roof rack system will be void if the front of the kayak is not secured to the bonnet

Racks must be removed when vehicle is put through an automatic car wash.

Ensure Ladder is well supported on the ground to support tent. Take extreme caution when climbing heights above 1.2m/4ft.

Tub/tray/canopys can move independently from the vehicle cabin. Rigidly fix to either the cabin roof racks **or** the tub/tray/canopy roof racks but not both simultaneously.

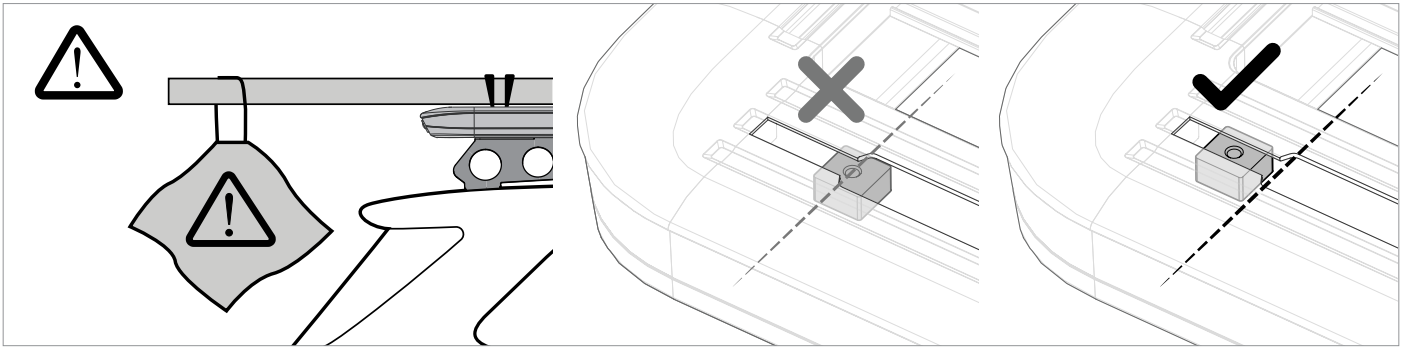

Ensure sunroof will not collide with roof rack system.

Youtube.com/Rhinorackaustralia

Carrying Capacity

Check the website and the vehicle owners hand book for your vehicle manufacturer's maximum carrying capacity. Load must be evenly distributed over the system.

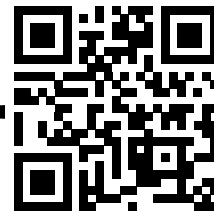
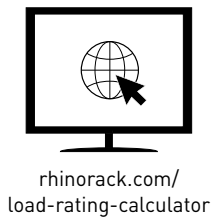

LOAD RATING CALCULATOR

SELECT YOUR VEHICLE

MANUFACTURER

MODEL

YEAR

BODY TYPE



Cargo Load Limit

Total permissible weight allowed on top, and attached to the rack whilst the vehicle is in motion.

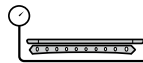

System Weight

Total weight of the rack system. (e.g. Crossbars, Backbone, Platform)



Max System Load Capacity

Please ensure you use the vehicle manufacturer's maximum roof allowance if it is lower than the figure listed in the fitting chart/ supplement.



Vehicle Manufacturer's Load Limit

Total permissible weight attached to the rack. This is inclusive of the weight of the rack system.

In service maintenance checks

- All bolt connections should be checked after driving a short distance when you first install your roof racks.
- All bolted connections should be checked again at regular intervals (weekly is recommended, depending on road conditions, usage, loads and distances travelled).
- All bolted connections should be checked each time they are re-fitted.
- Off-road conditions are more rigorous. Check all bolted connections and your load more regularly.
- Ensure that your vehicle manufacturer's GVM, and gross axle weights are not exceeded (refer to vehicle owner's manual).

Torque Settings:

Unless stated otherwise in these instructions, all fasteners should be set to the following torque settings:

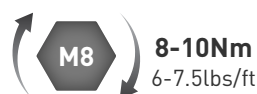

Note for Dealers and Fitters

It is your responsibility to ensure these fitting instructions are given to the end user or client. These instructions remain the property of Rhino-Rack Australia Pty. Ltd. and may not be used or changed for any other purpose than intended.

PARTS LIST

P1 PHASE 1 - ROOF PREPARATION

Trim Tool

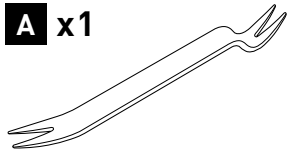
A x1

Nylon Scaper

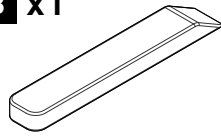
B x1

Ditch Infill Rubber

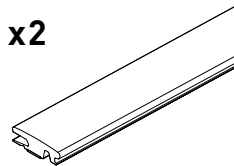
C x2

TOOLS REQUIRED:

T1 - 6mm Hex Socket**T2** - T30 Torx Bit**T3** - T20 Torx Bit**T4** - T50 Torx Bit**T5** - T25 Torx Bit**T6** - 15mm Hex Socket**T7** - Cleaning Rag**T8** - Ruler / Tape Measure**T9** - Fine Tip Marker**T10** - Masking Tape**T11** - 16mm Open-ended Spanner**T12** - 17mm Hex Socket**T13** - 8mm Hex Socket**T14** - 75mm Extension Bar**T15** - Torque Wrench 10-50Nm**T16** - 13mm Spanner

P2 PHASE 2 - BACKBONE INSTALLATION

Left Backbone

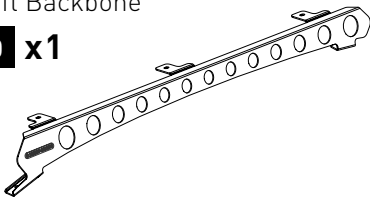
D x1

Right Backbone

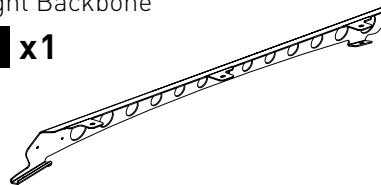
E x1

M10 x 20mm Hex Head Bolt

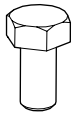
F x4

M10 x 24 Flat Washer

G x2

M10 x 38 Flat Washer

H x2

M10 Nyloc Nut

I x4

Front Left Ditch Cover Trim

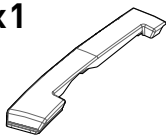
J x1

Rear Left Ditch Cover Trim

K x1

Front Right Ditch Cover Trim

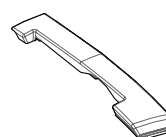
L x1

Rear Right Ditch Cover Trim

M x1

P3 PHASE 3 - PLATFORM INSTALLATION (5XXXX Series Pioneer)

T-Bolt

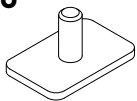
N x6

M8 x 24mm Flat Washer

O x6

M8 Nyloc Nut

P x6

Fitting Instruction

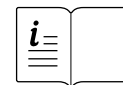
Q x1

CONTENTS:

For **Factory Rail Variants**, complete Steps **1** - **24** and **30** - **43**For **Bare Roof Variants**, complete Steps **1** - **21** and **25** - **43****NOTE:** Roof lining drop requires safe storage of removed parts, for ease of re-fitment.

INTERNAL ROOF LINING DROP - For All Variants

P1
▼

1 Remove all 4 pillar grab handles by removing end caps and then bolts.
NOTE: Store all internal trimming and hardware in a safe location, for ease of re-fitment.

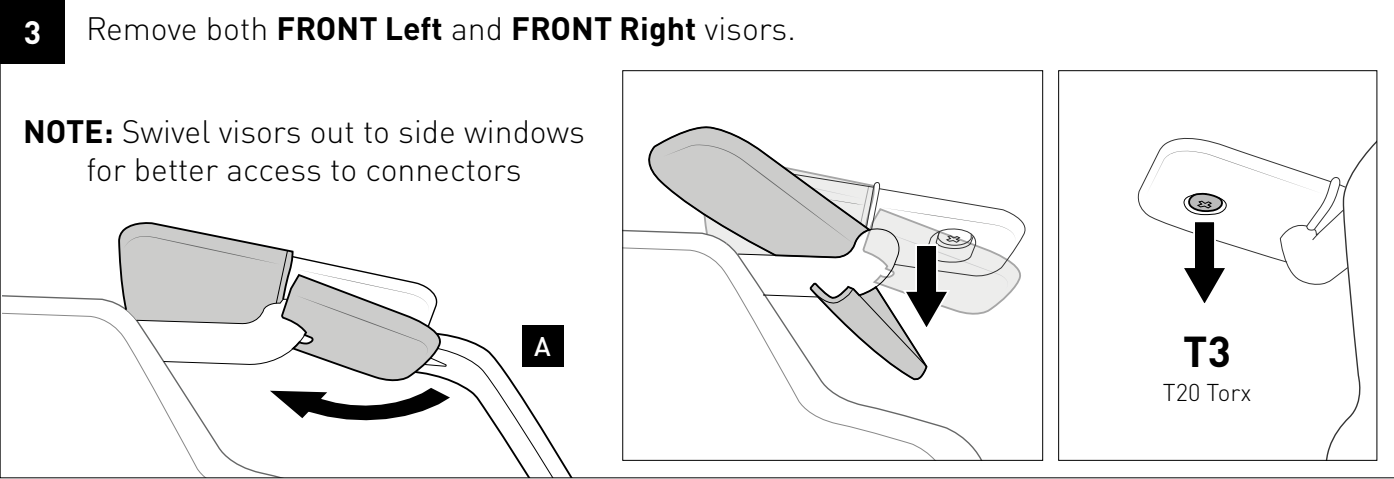
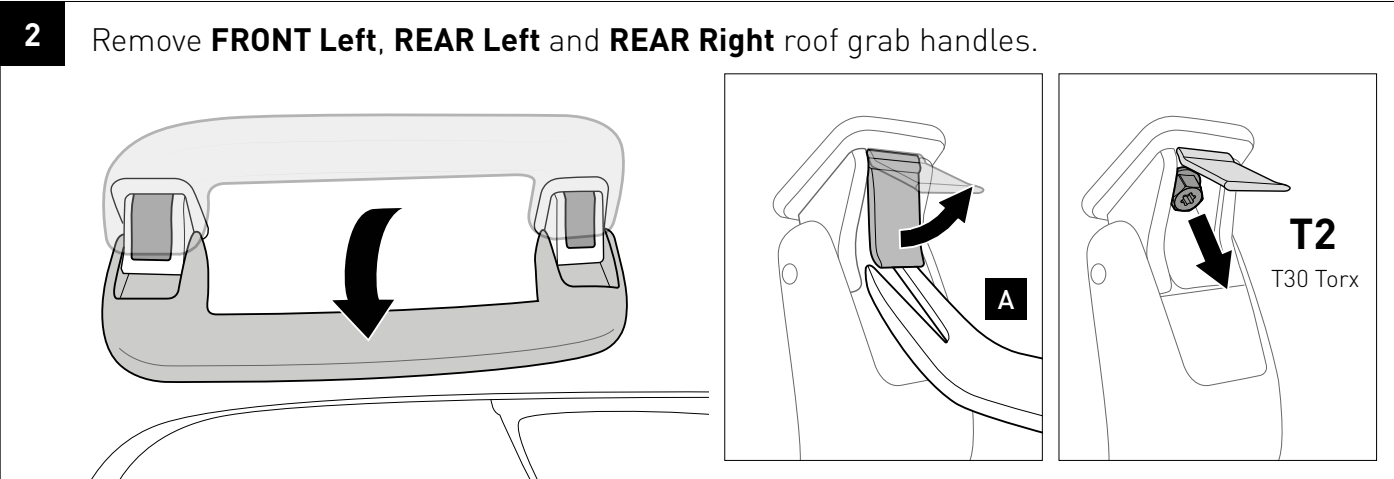
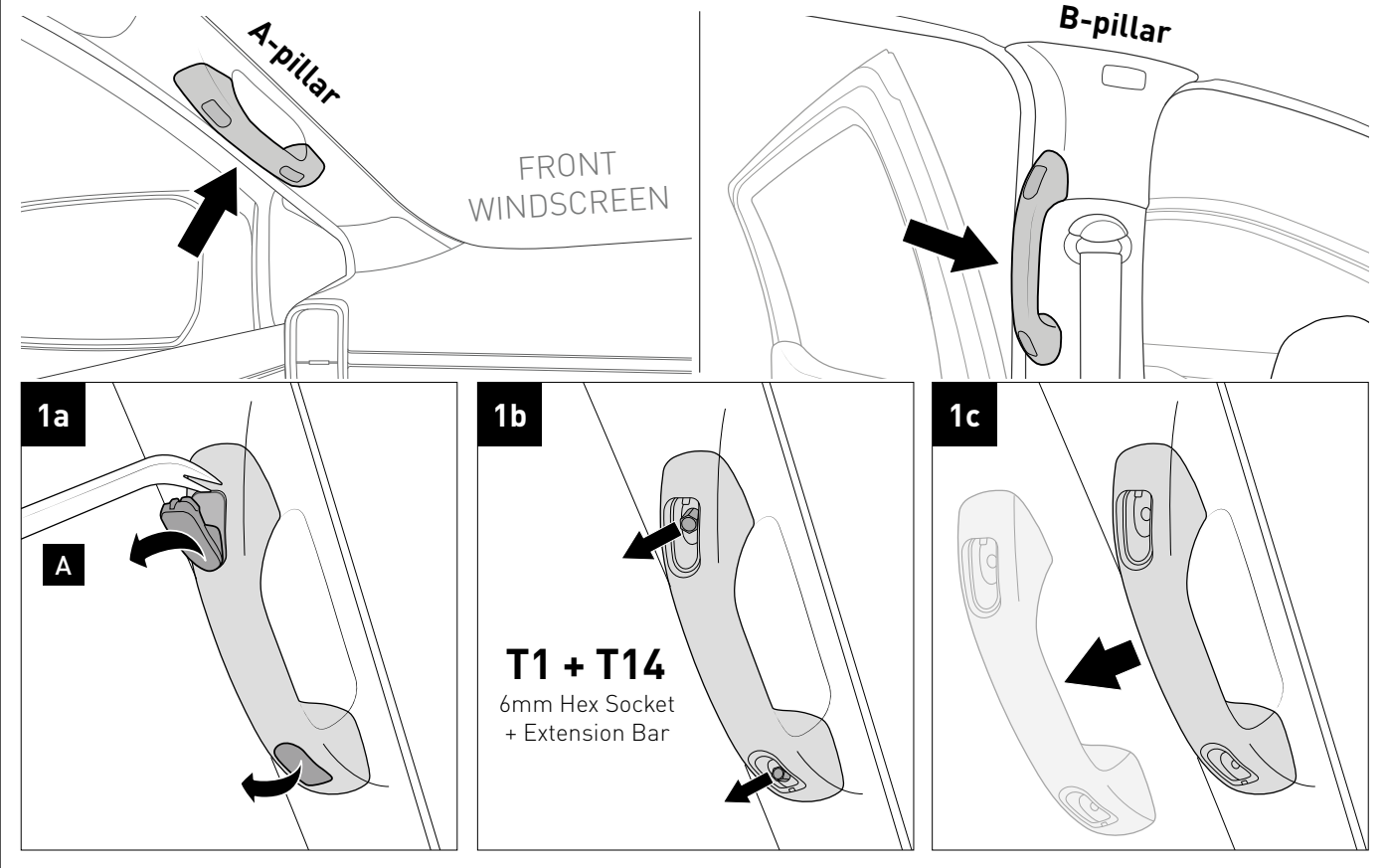

4 Remove **FRONT Left** and **FRONT Right** visor roof clips.

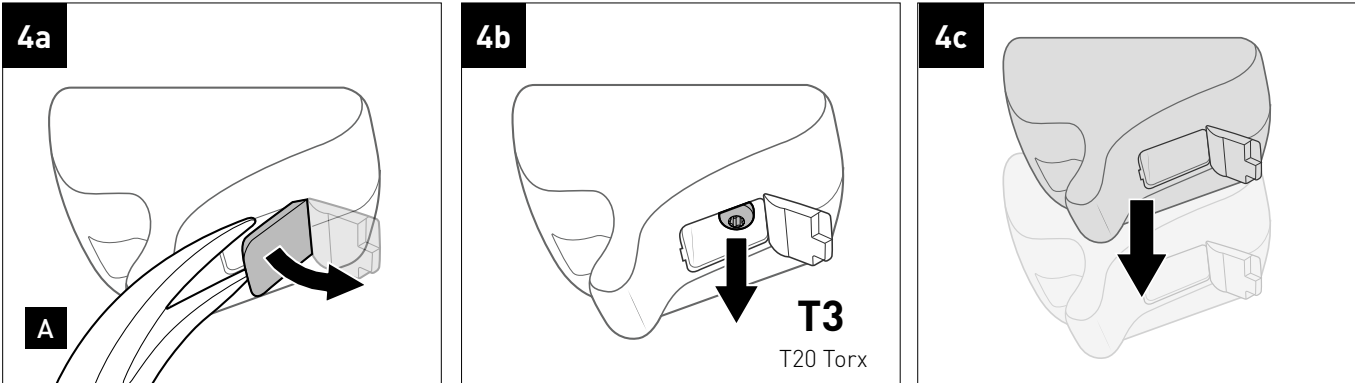

5 Remove **REAR** roof hooks.

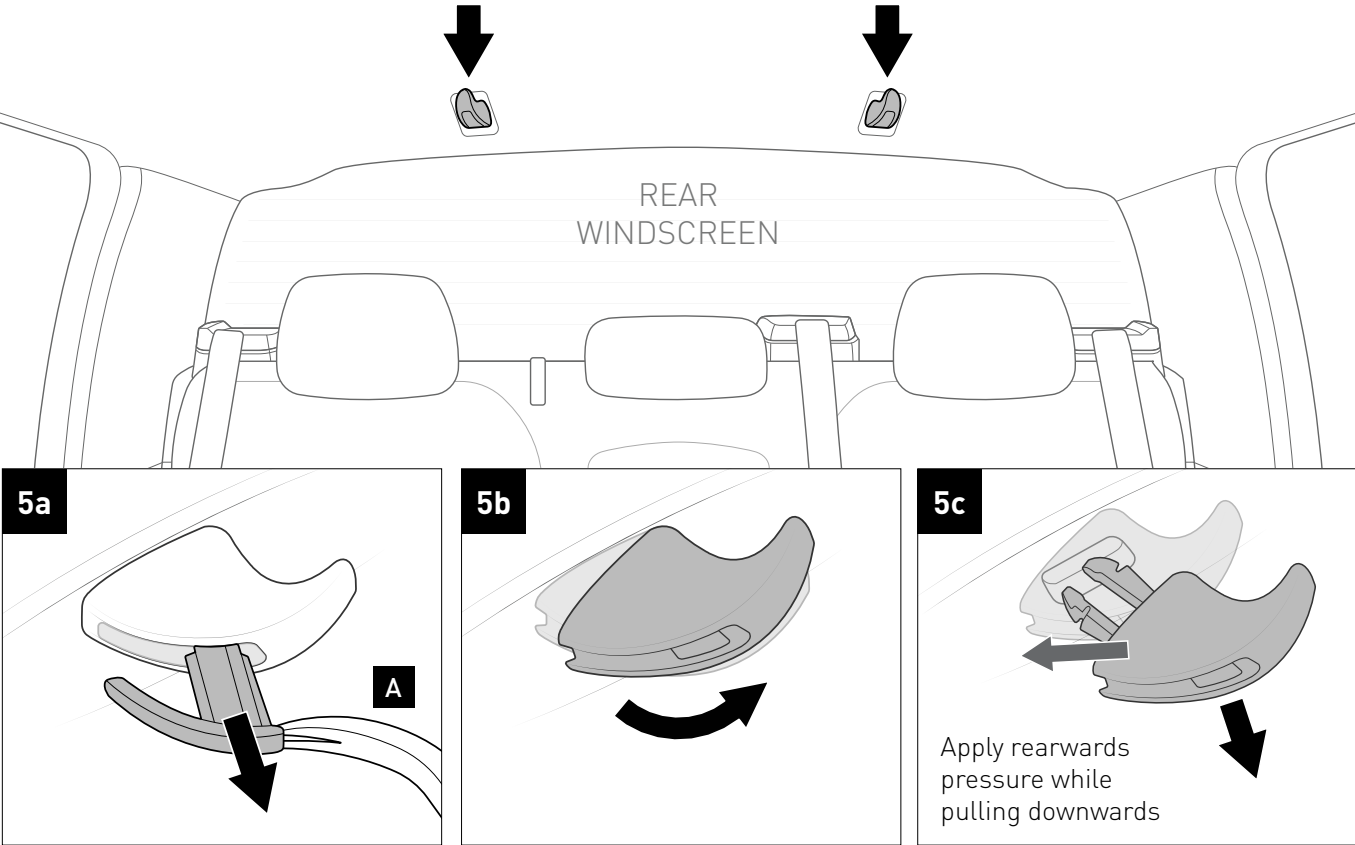

6 Remove **B-pillar** seatbelts.

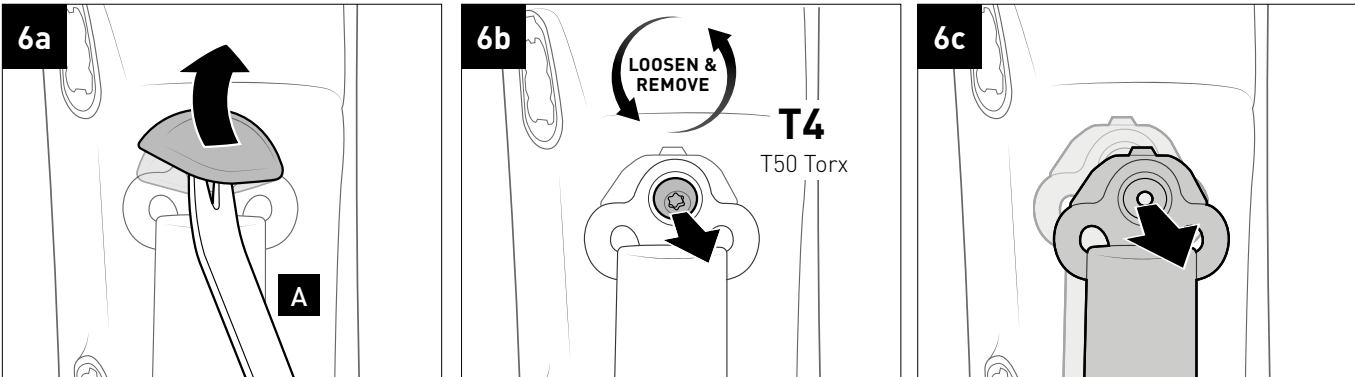

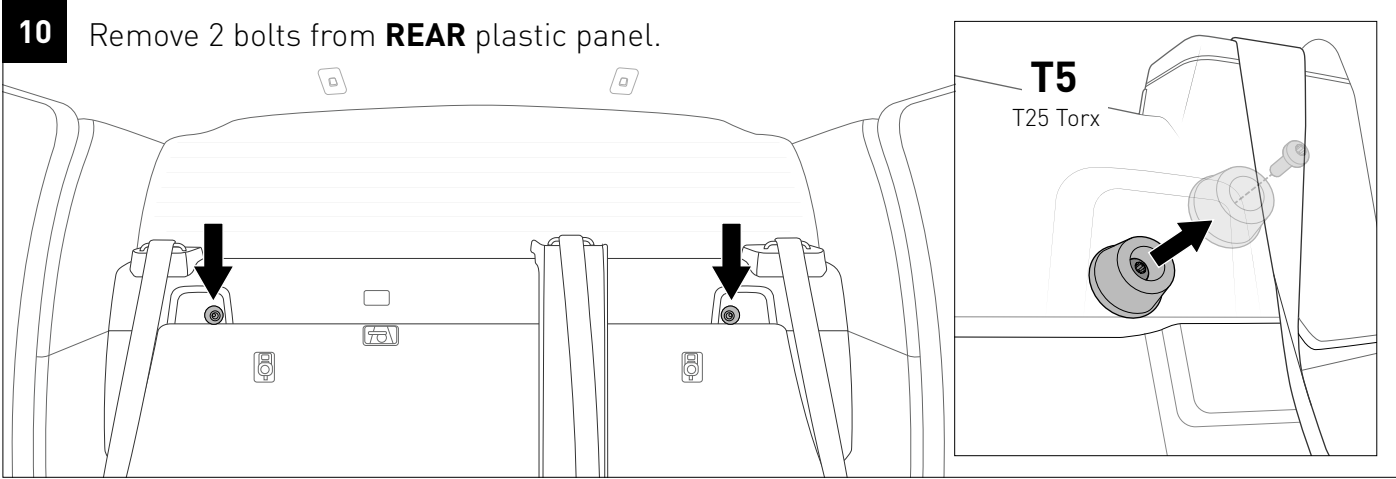
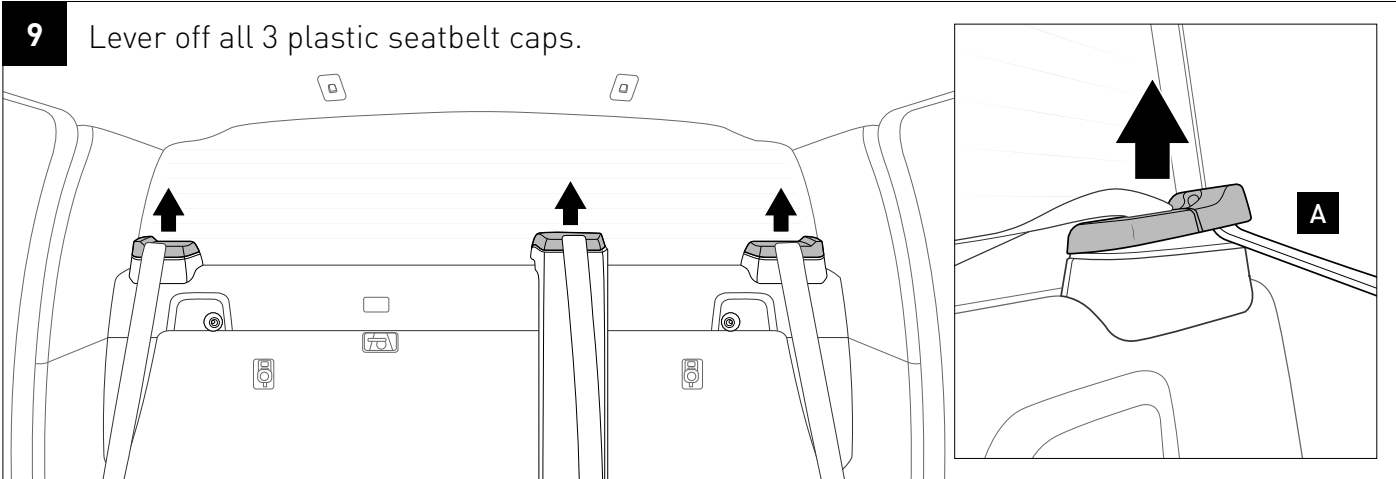
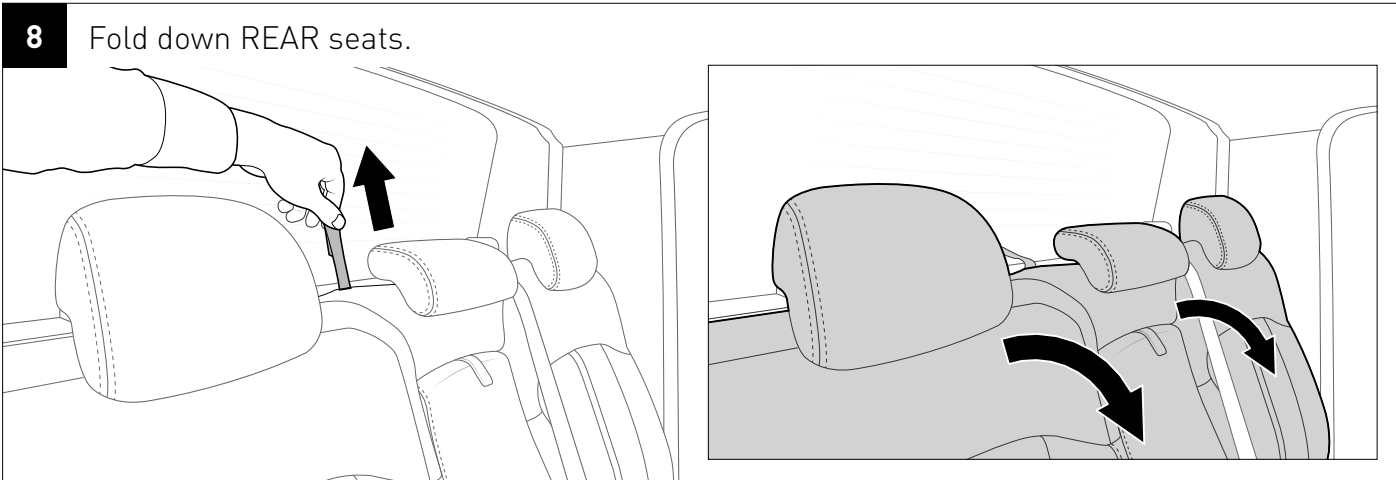
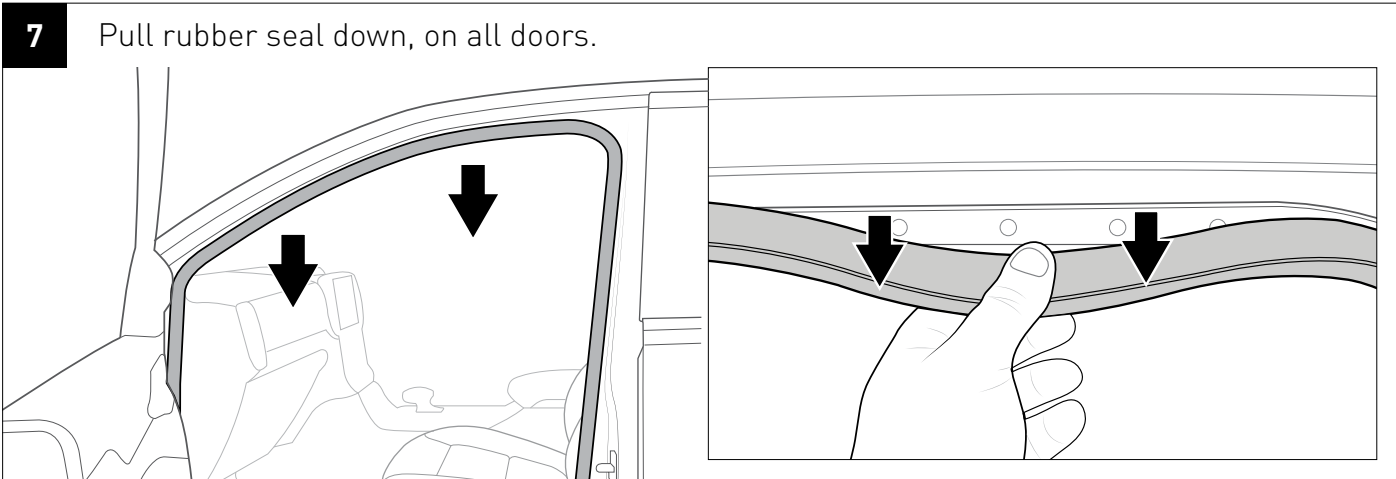

11 Remove **REAR** middle seatbelt pillar

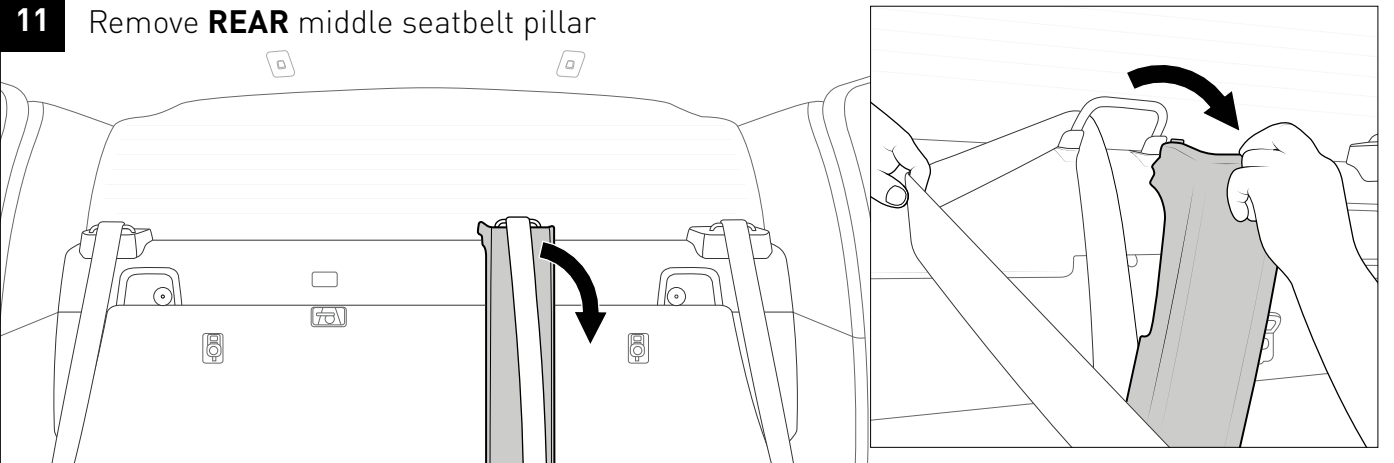

12 Remove **REAR** plastic panel from internal clip locations.

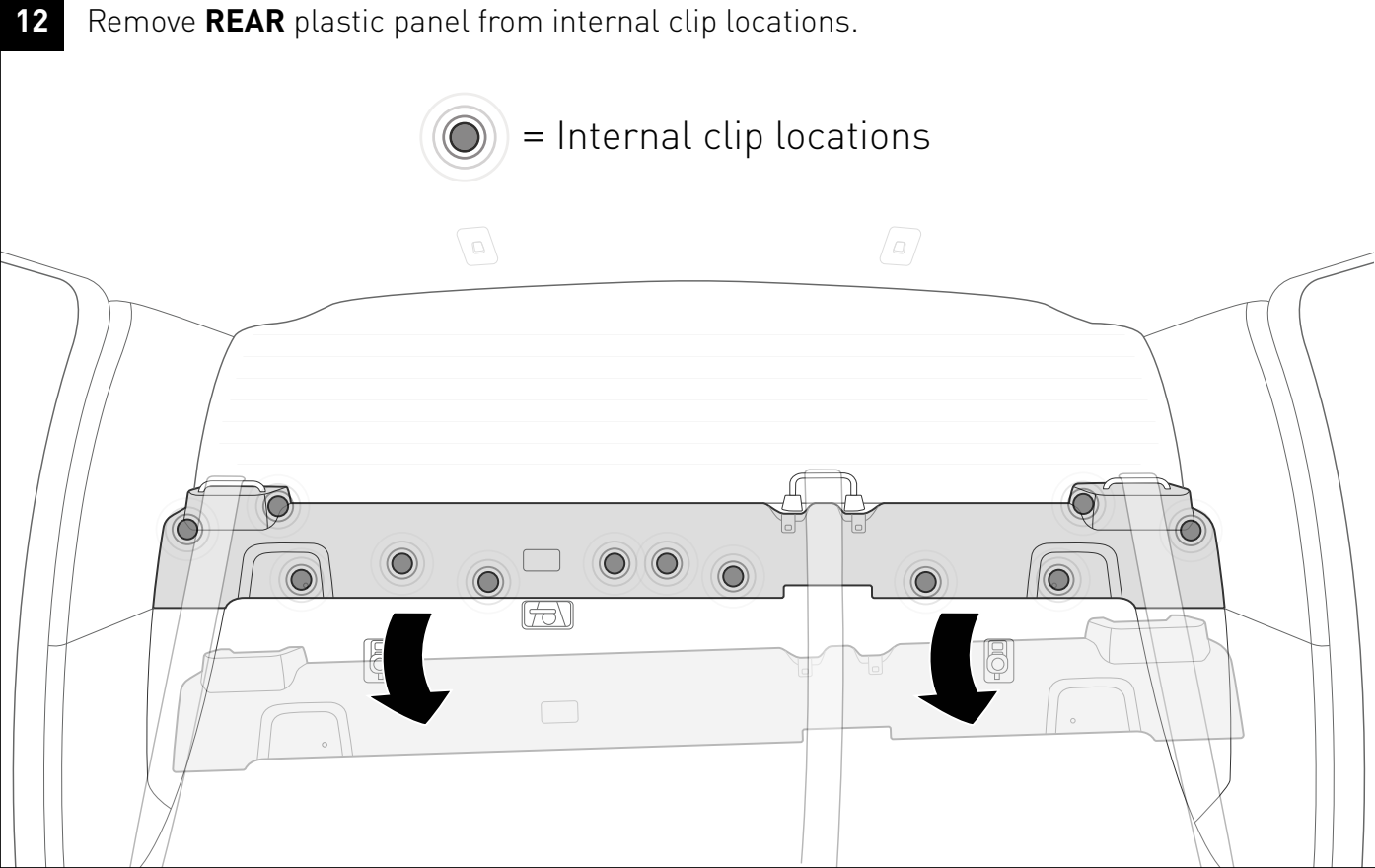

13 Release the top of the **lower C-Pillar** covers.

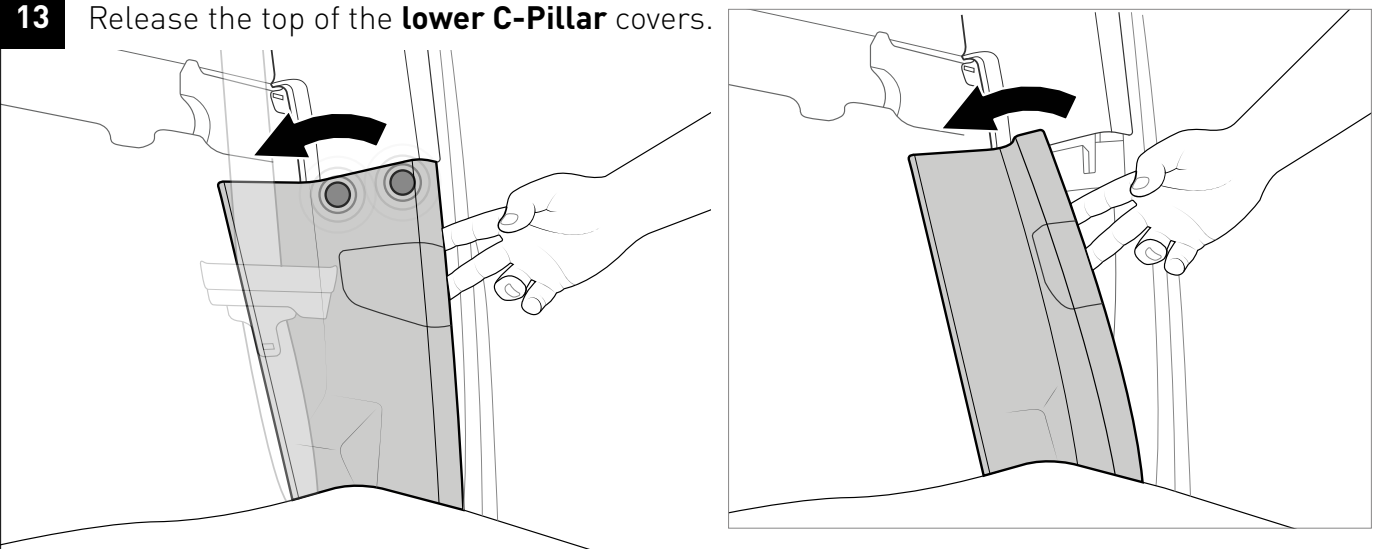

14a Remove **Upper C-pillar** covers.

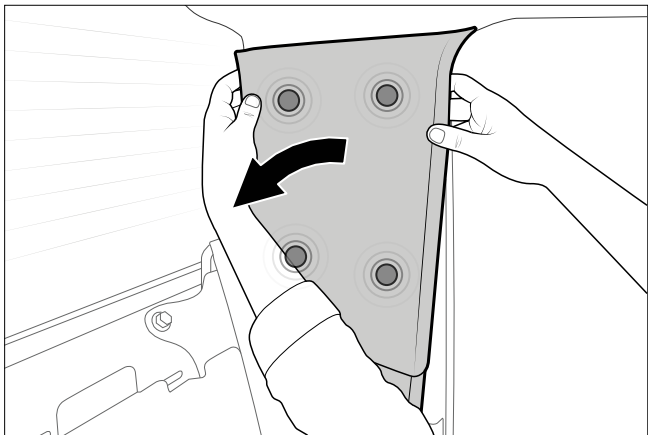
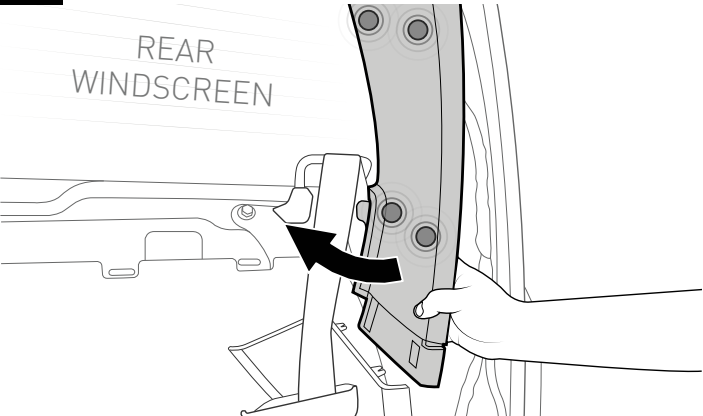

14b

NOTE:

If black metal clip retainers are left behind on the vehicle body, retrieve and reinsert onto the plastic covers.

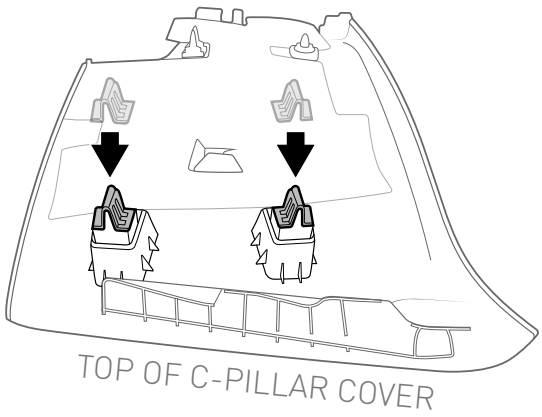
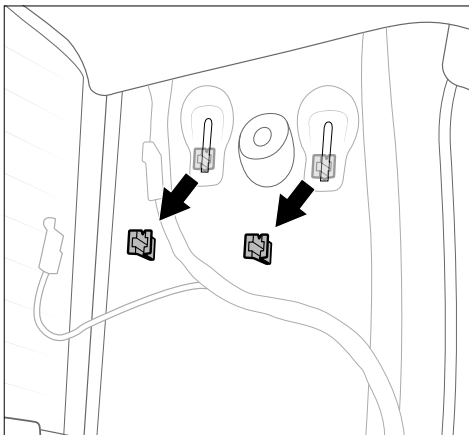

15 Unclip upper **B-pillar** cover first, then move hands down to unclip the middle clips.

15a

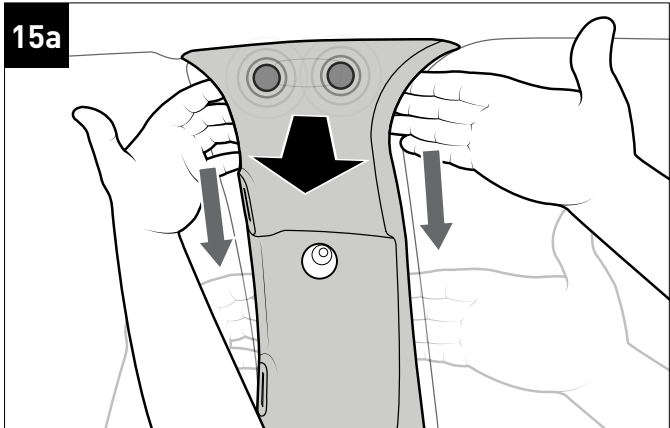

15b

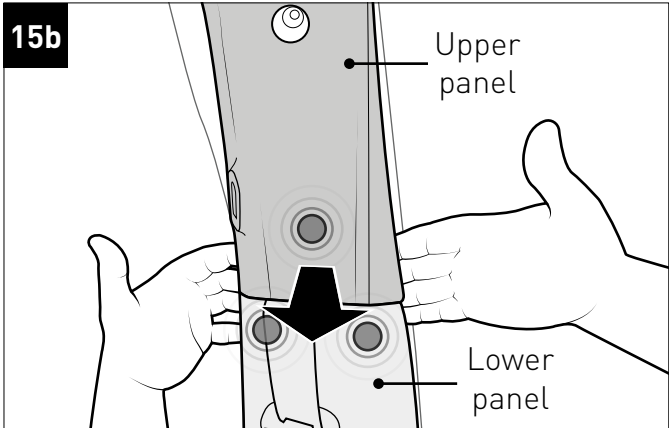

15c

Once top of lower cover has unclipped, the upper cover can then be removed from the lower cover.

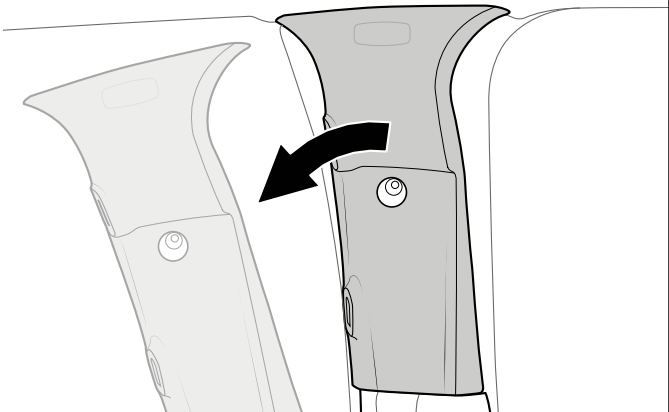

16 Unclip and remove **A-pillar** cover.

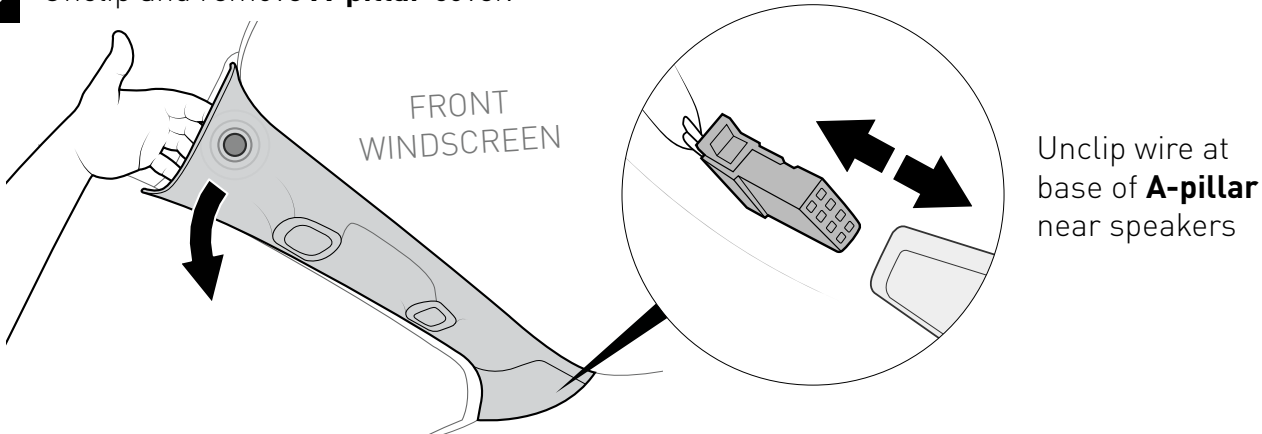

17 Add layers of tape to prevent scuffing when the headliner drops.

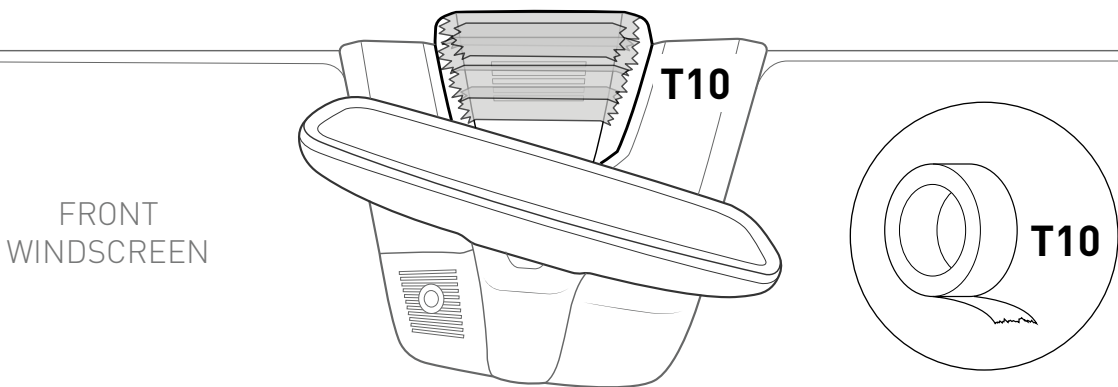

18 Open sunglasses compartment and pull rear of centre console down.

18a

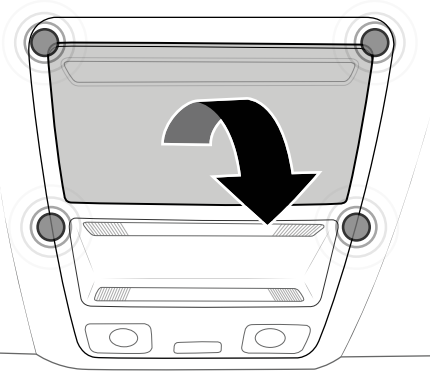

18b

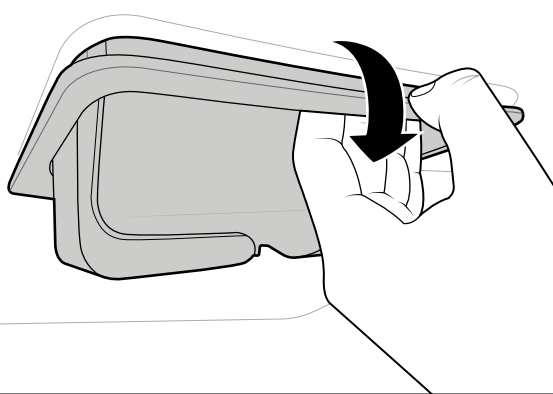

18c

Once rear is released, move hands forwards to centre of console and pull down again to release the centre clips.

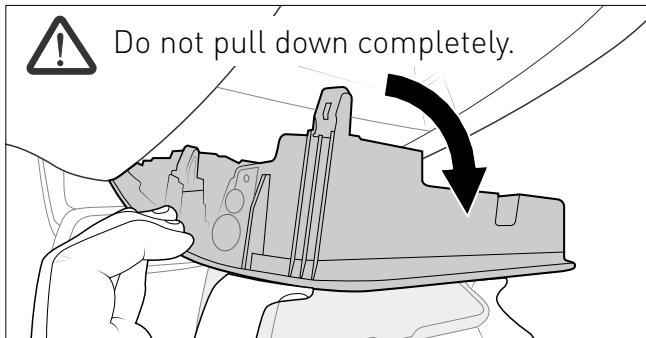
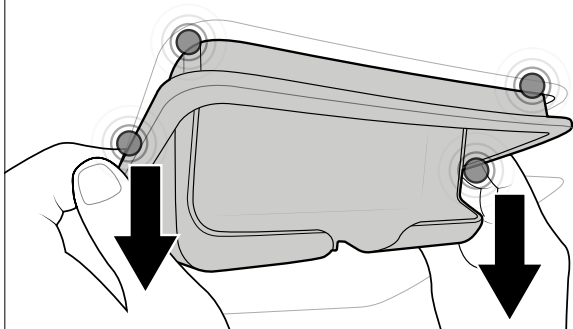

19 Once console is unclipped carefully lower to access **two** wiring connectors towards the front. Unclip **both** wiring connectors.

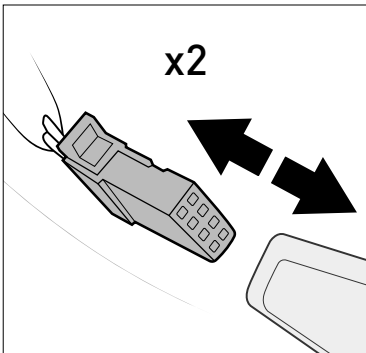
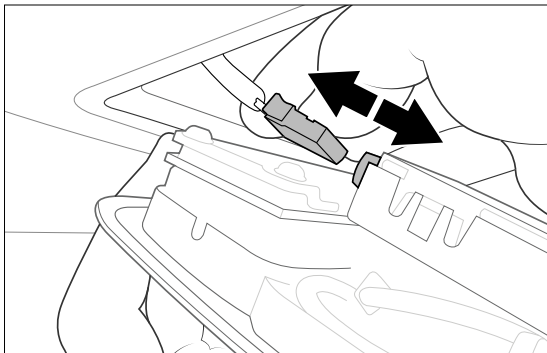

NOTE: RHS connector features release button

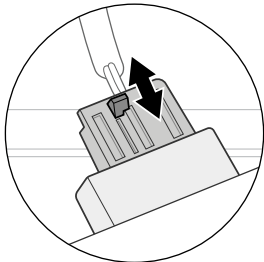

20

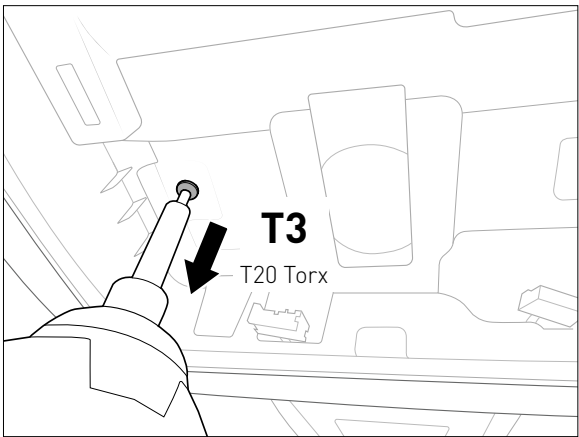
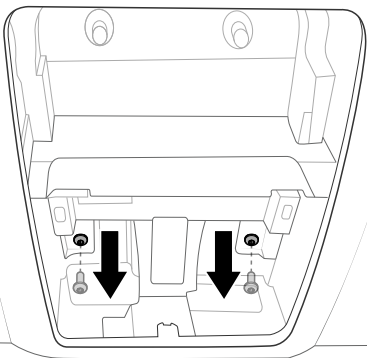

21 With one person standing on each side of the car, behind the **B-Pillar**, simultaneously pull the headliner down to release the magnet in the centre. Lower headliner as far as FRONT wiring allows.



NOTE: Front seats can be positioned/reclined so that the headliner rests on the top of front seat headrests

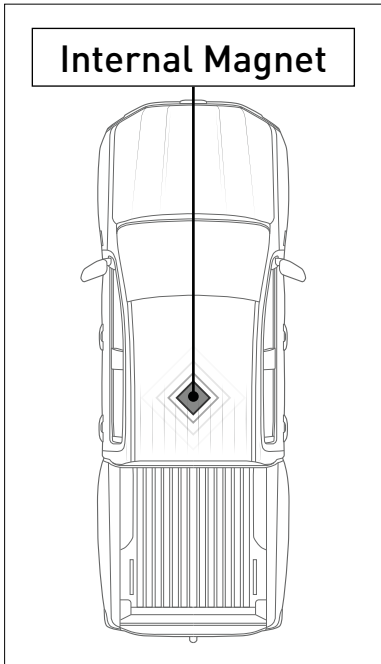

Internal Magnet

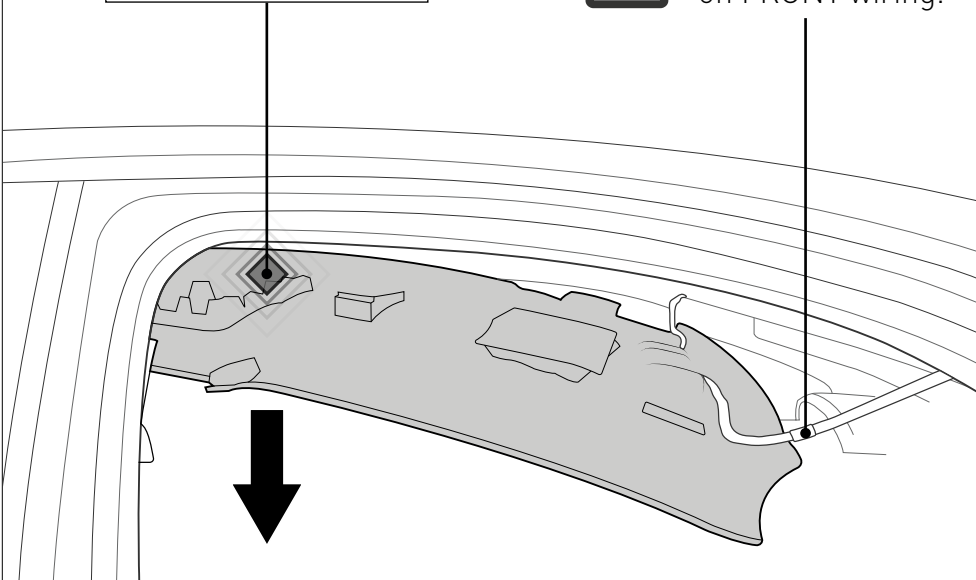

! Do **not** tug downwards on FRONT wiring.

FACTORY RAIL VARIANTS (For Bare Roof Variants, skip to Step 25)

22 Undo 4 roof rail connection points

CAUTION: Do not hit/dislodge airbags

LOOSEN & REMOVE

T6
15mm Hex Socket

23 Carefully separate the rail off the vehicle roof, starting from the **REAR**, then moving to the **FRONT** (gradually pry off adhesive tape along the centre of the rail).

23a **REAR**

Factory tape

23b **FRONT**

Factory tape

24 Completely remove rail in vertical motion, and store rail and hardware in a safe location.

Once completed Skip to Step **30**

BARE ROOF VARIANTS (For Factory Rail Variants, skip to Step 30)

25 Undo 4 roof ditch connection points

CAUTION: Do not hit/dislodge airbags

LOOSEN & REMOVE

T13
8mm Hex Socket

26 Peel ditch rubber upwards starting from the **REAR**

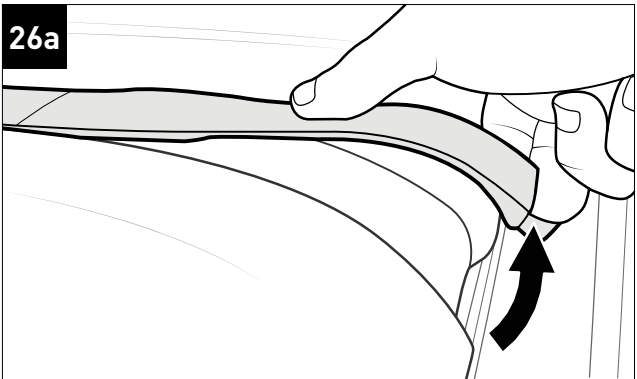

Once lifted, use scraper tool to assist removal.

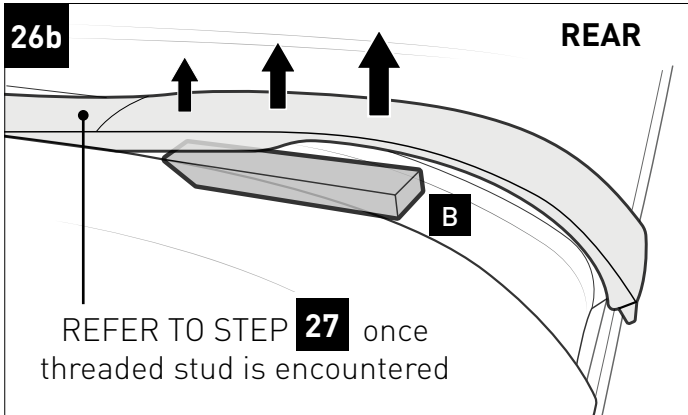

CAUTION: Do not use scraper to lever off the body. Only use scraper inside the roof ditch

27 Vertical lifting technique for threaded bolt connections:

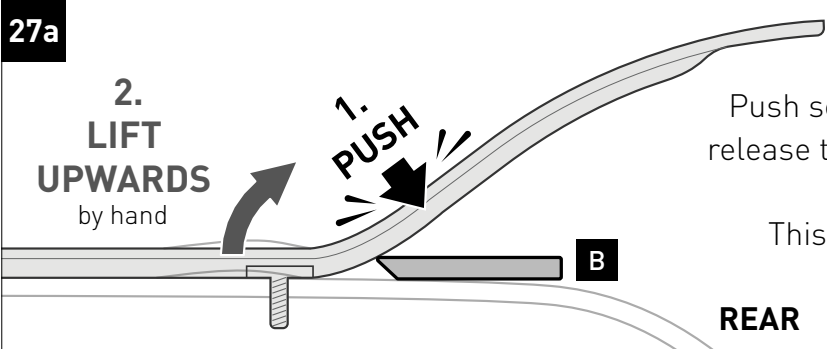

Push scraper, inside the ditch only, to help release the ditch rubber in front of the stud.
This will help separate the factory tape.

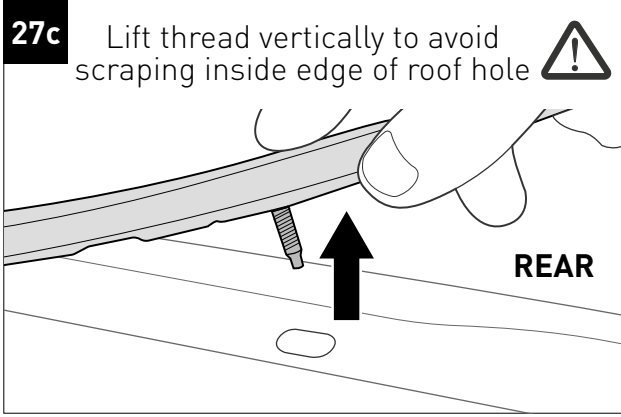
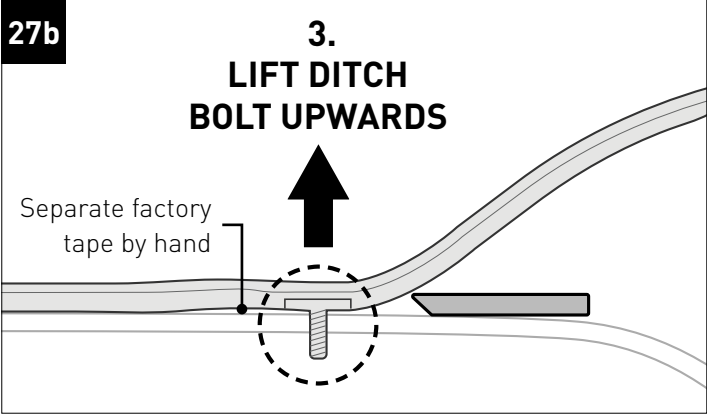

28 Continue lifting ditch rubber upwards towards the **FRONT** of the vehicle

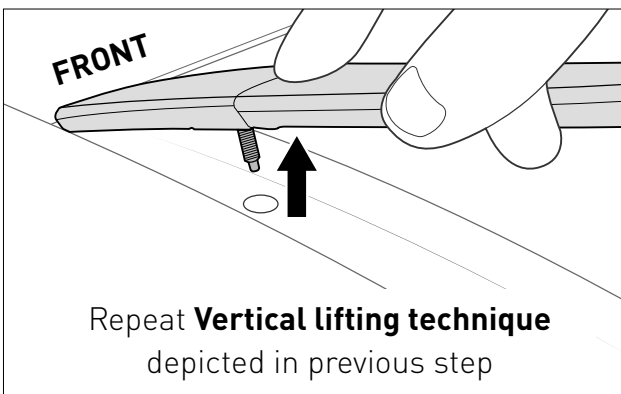
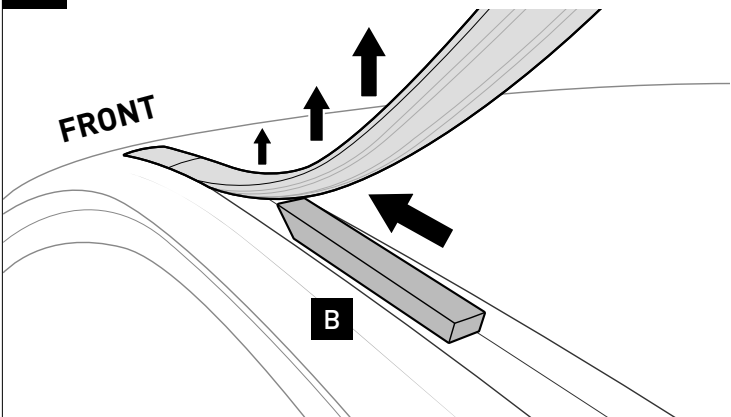

29 Remove and store.

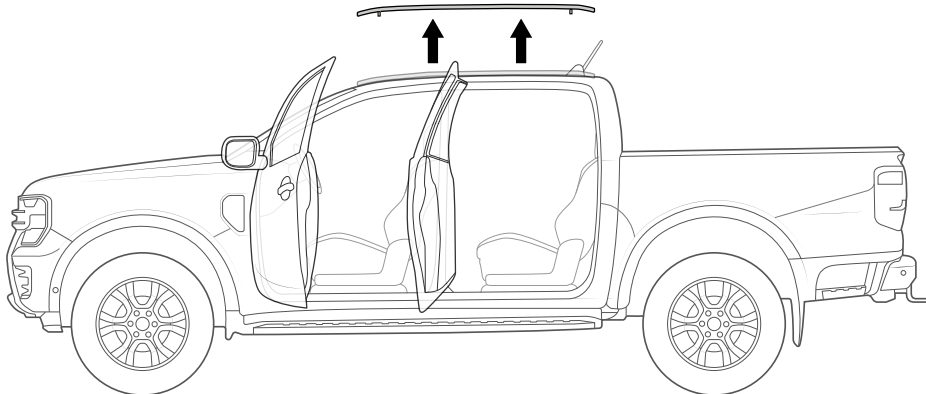

30 Remove any excess adhesive tape on the roof.

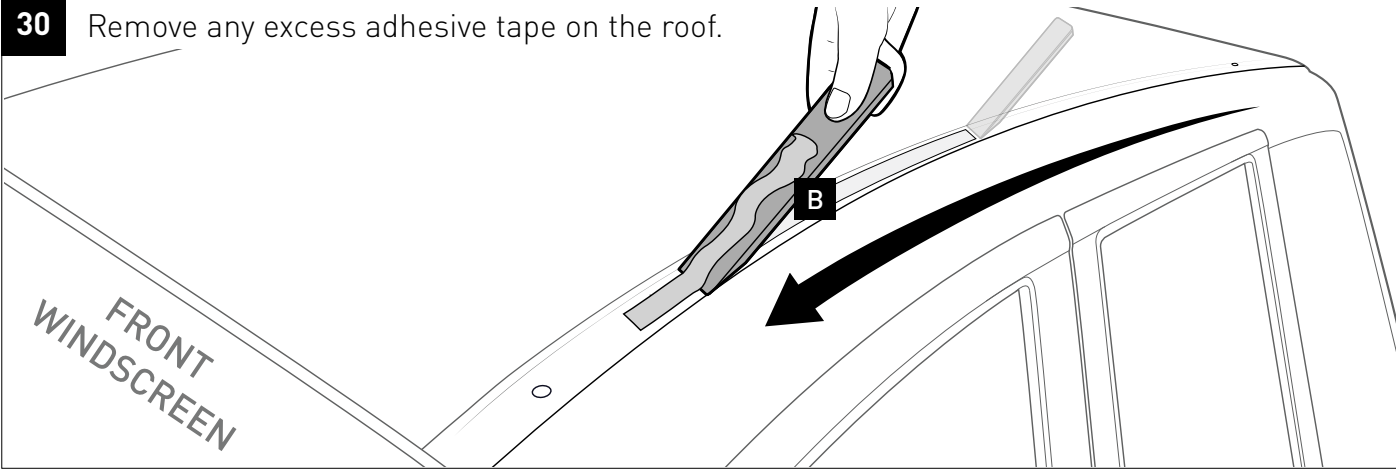

31 Clean ditch to remove all tape residue, dirt, grime and any oil residue.

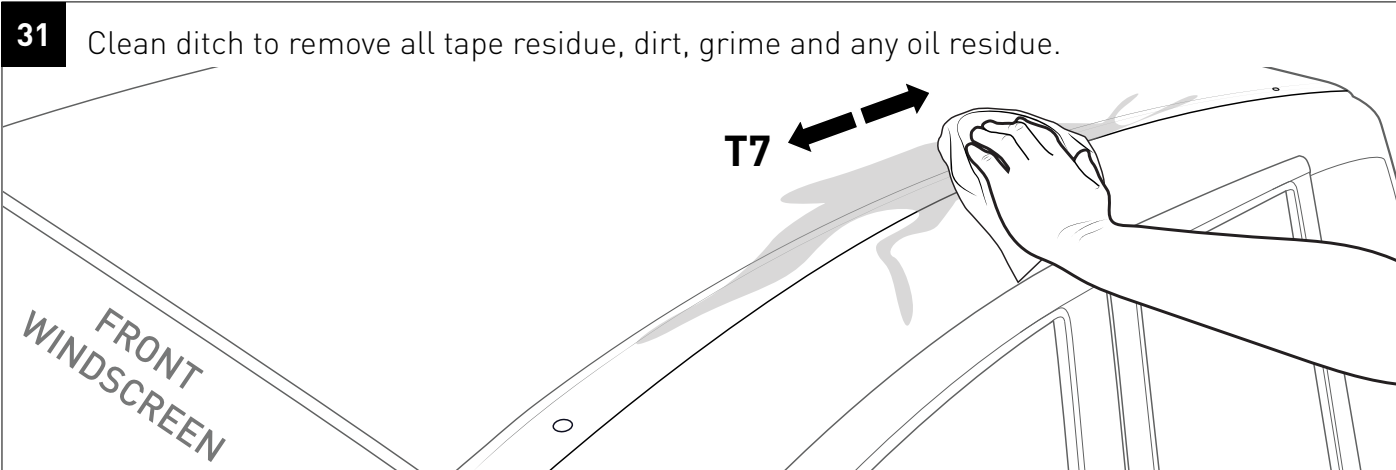

32 Measure from rear-most edge of FRONT mounting hole.

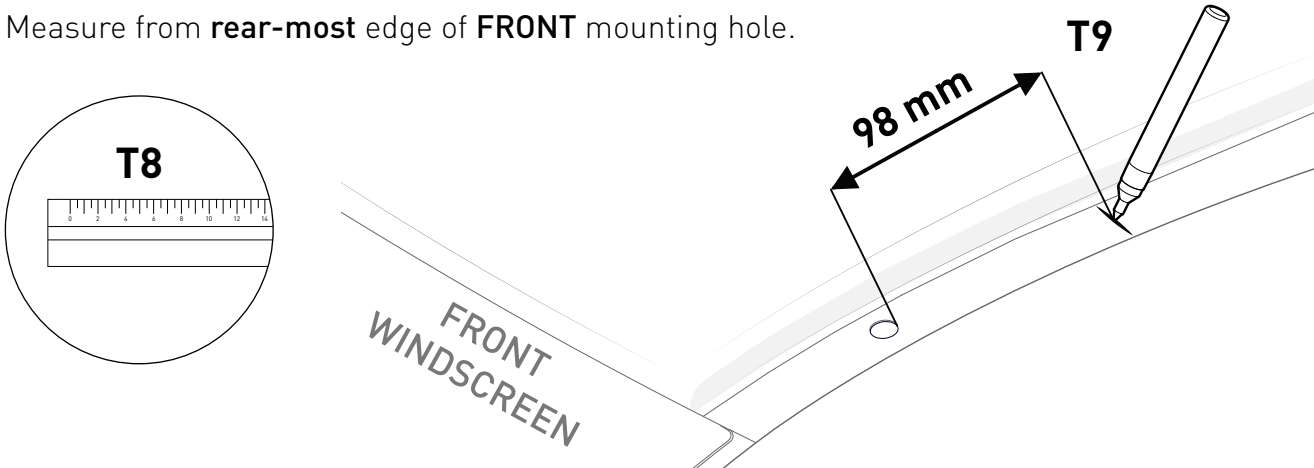

33 Apply to ditch starting at the **FRONT**.

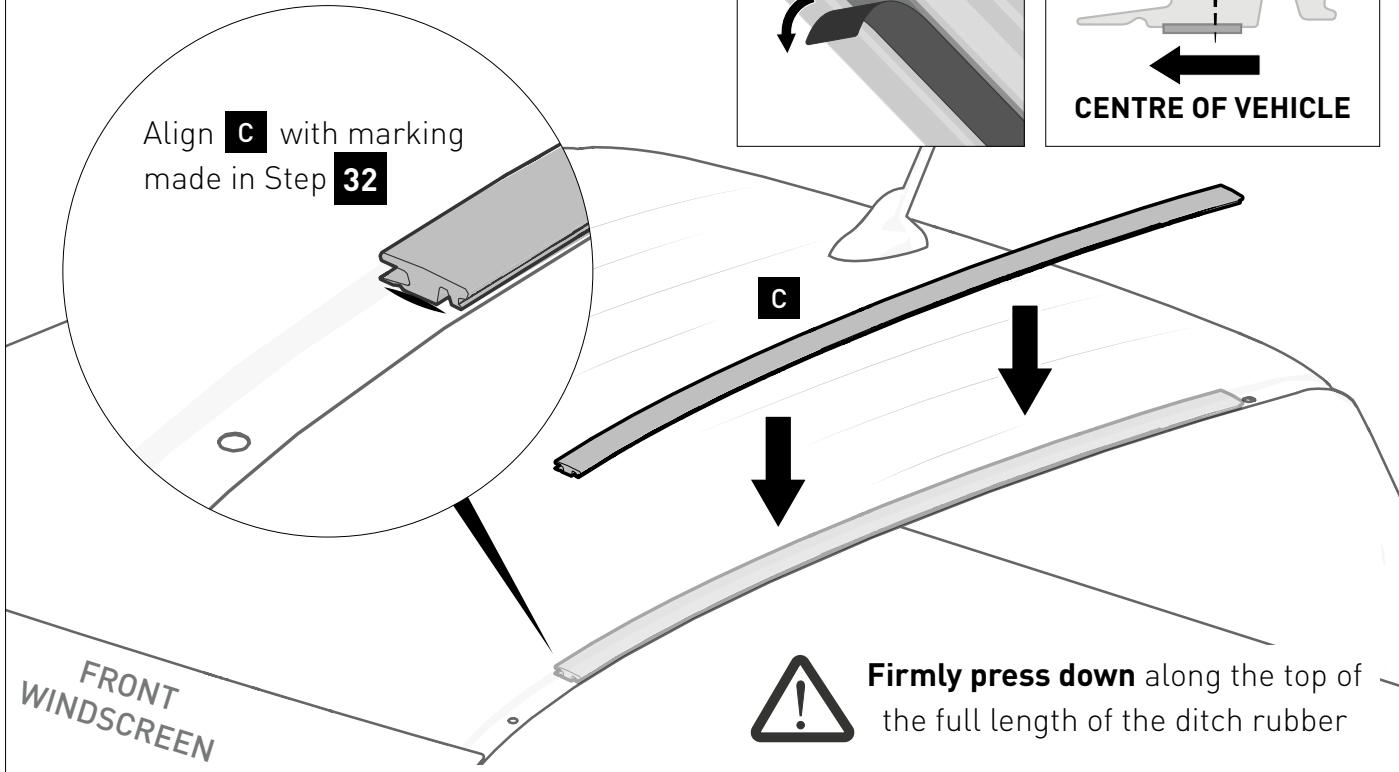

34 Place masking tape on vehicle paintwork around mounting points for protection.

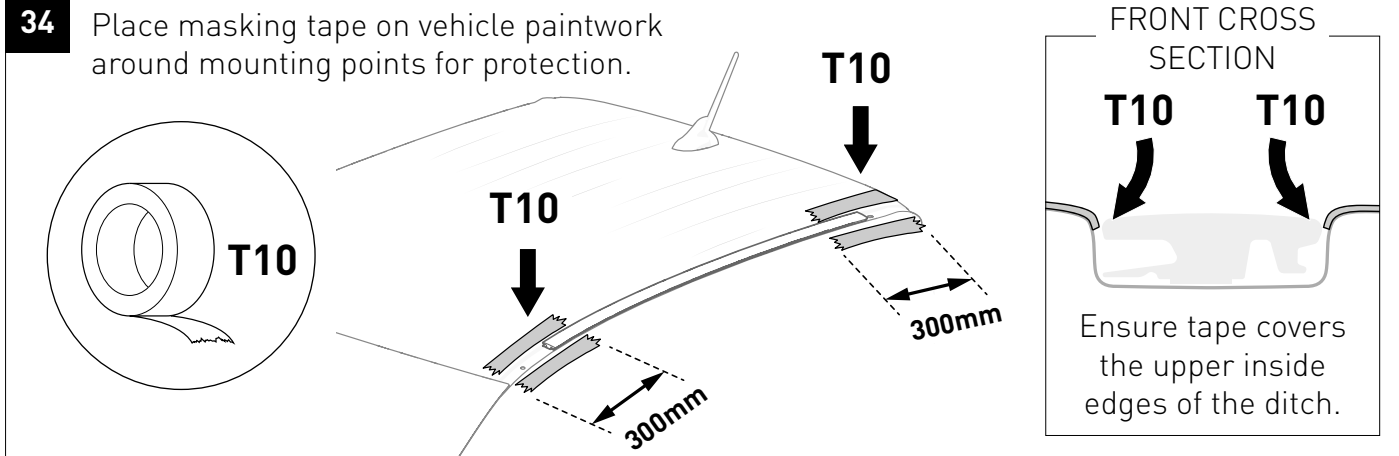

P2

35 **35a** Place **F** into both backbone legs. **35b** Carefully place backbone with bolts into roof mounting points, **FRONT** first, then **REAR**.

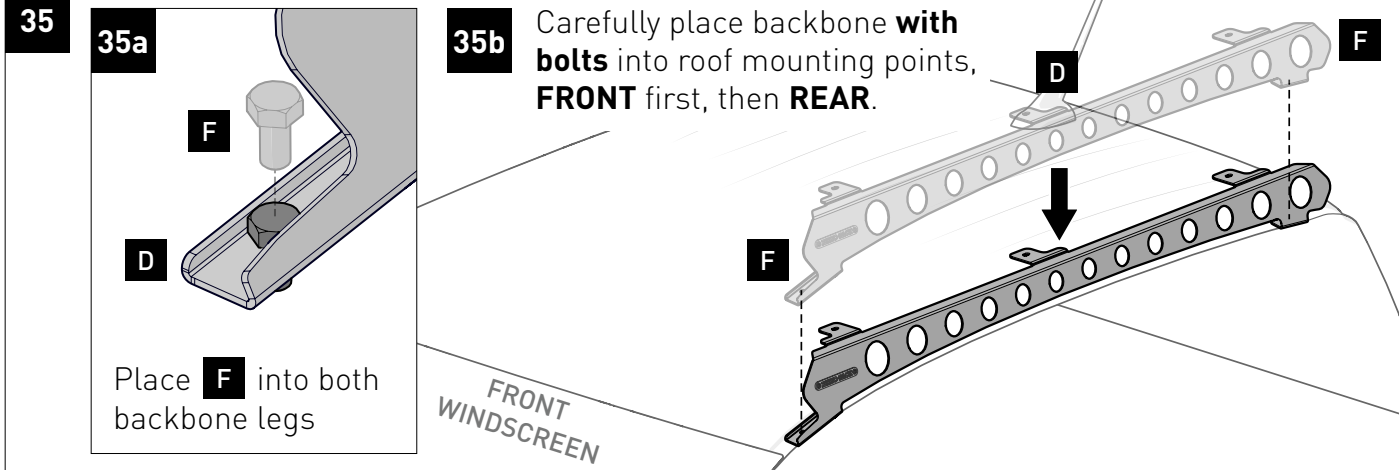

36 Finger tighten hardware onto **F** from underneath roof, completing **FRONT** first, carefully holding washer and nut at the same time.

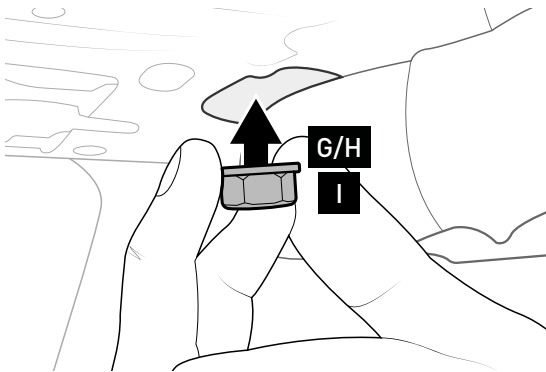
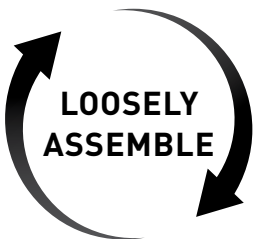

Be careful not to drop hardware into roof cavity.

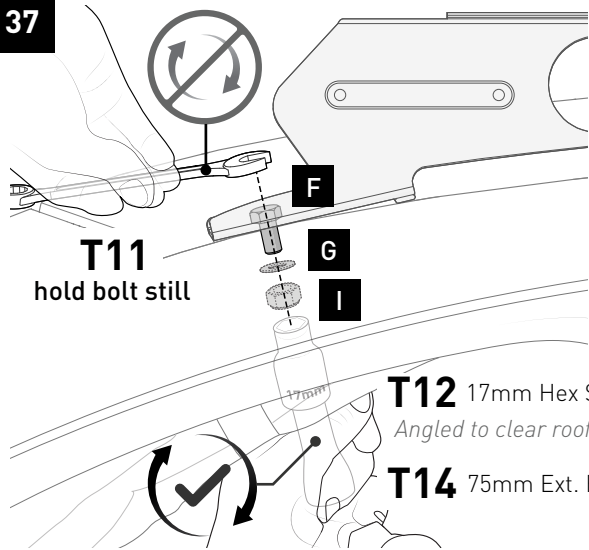
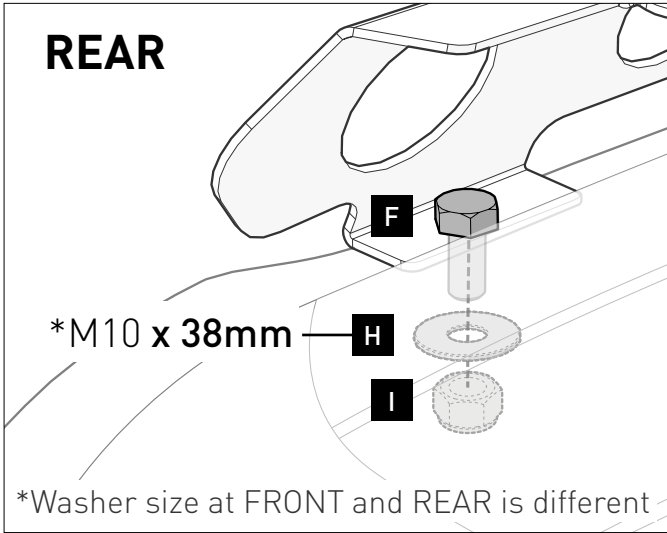
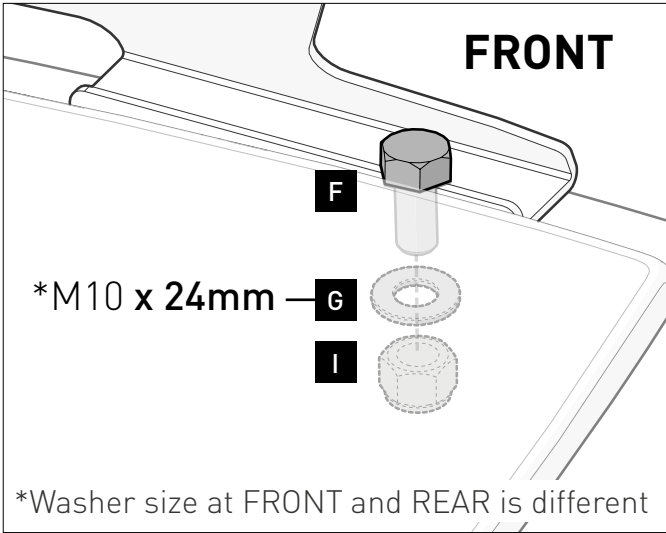
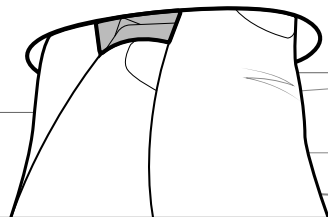

Use open end of **T11** Spanner, angled to clear roof, to hold bolt head stationary.
Do not rotate T11 spanner

- 1. Loosely tighten **FRONT**, then **REAR**, with **T12** 17mm Hex Socket.
- 2. Fully tighten **FRONT**, then **REAR** with **T15** Torque Wrench to finish.

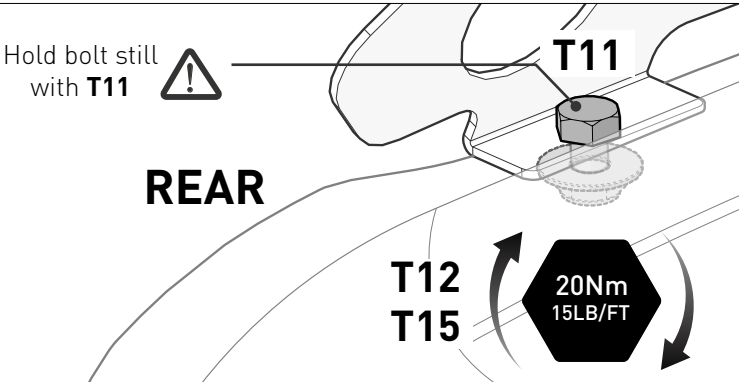
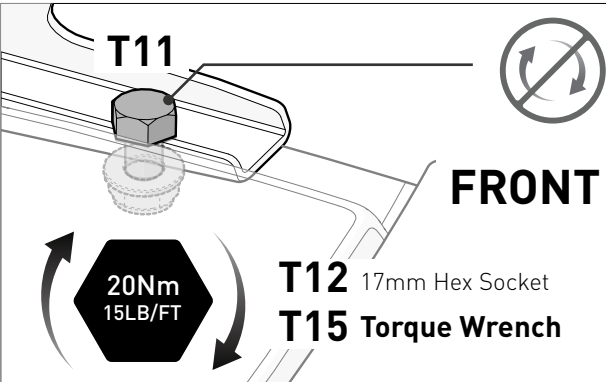

38 Peel off adhesive backing and insert covers into ditch gaps

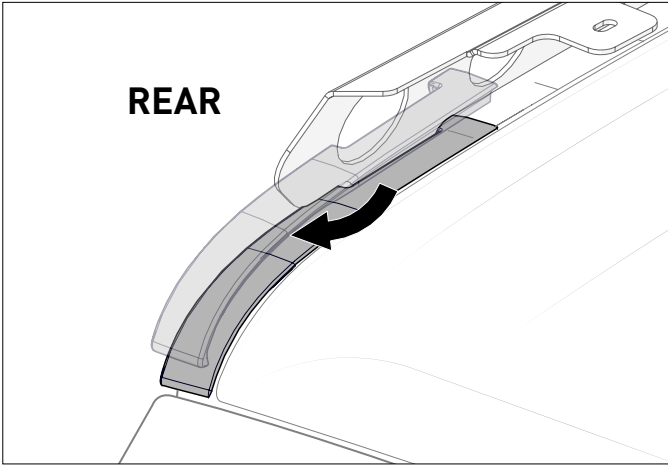
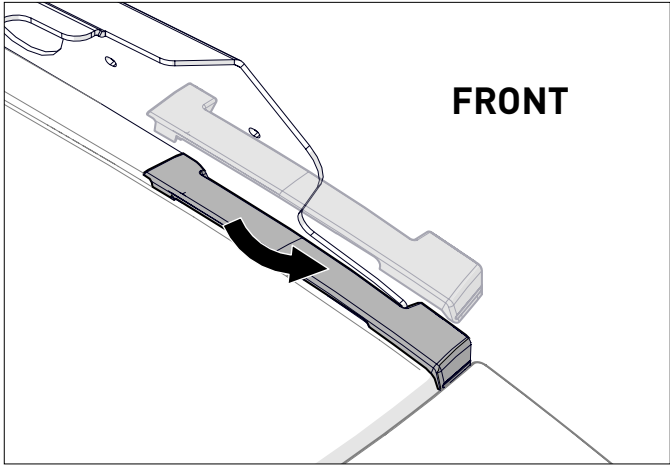
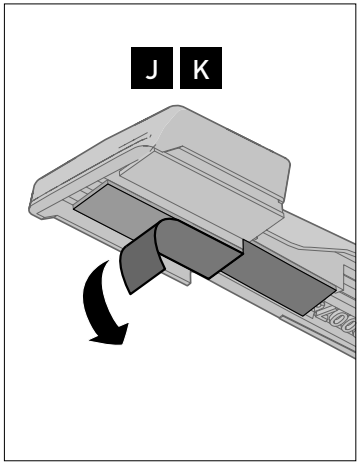
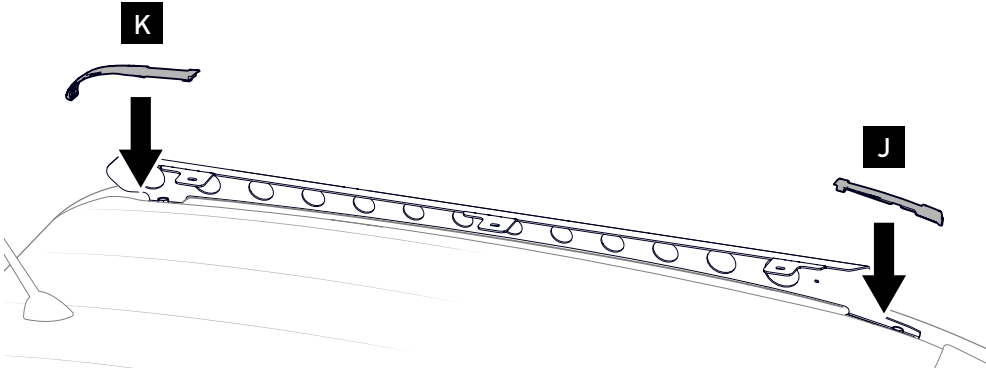

39 Repeat Steps **30** - **38** to opposite side of vehicle.

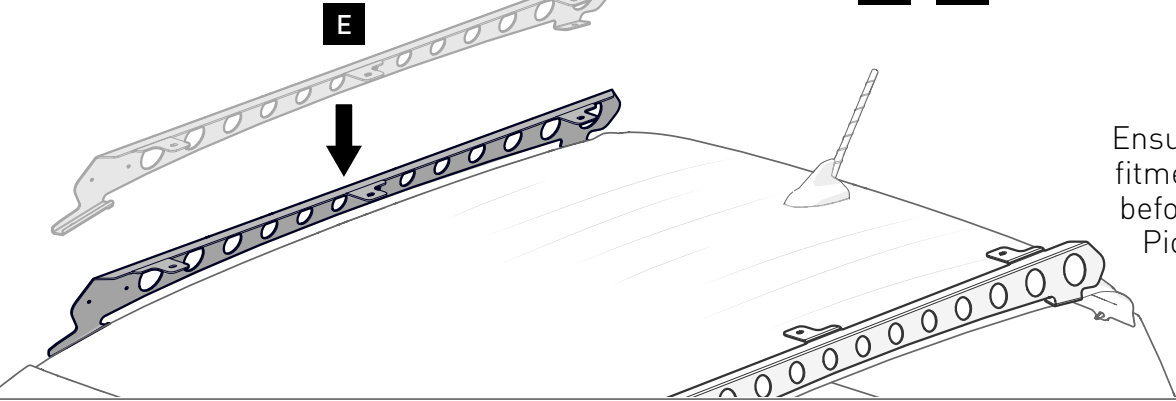

Ensure backbone fitment is secure before attaching Pioneer Tray.

ROOF LINING RE-INSTALLATION

40 Complete Steps **1** - **21** in reverse using notes on **Page 19-20** for re-installation guides.

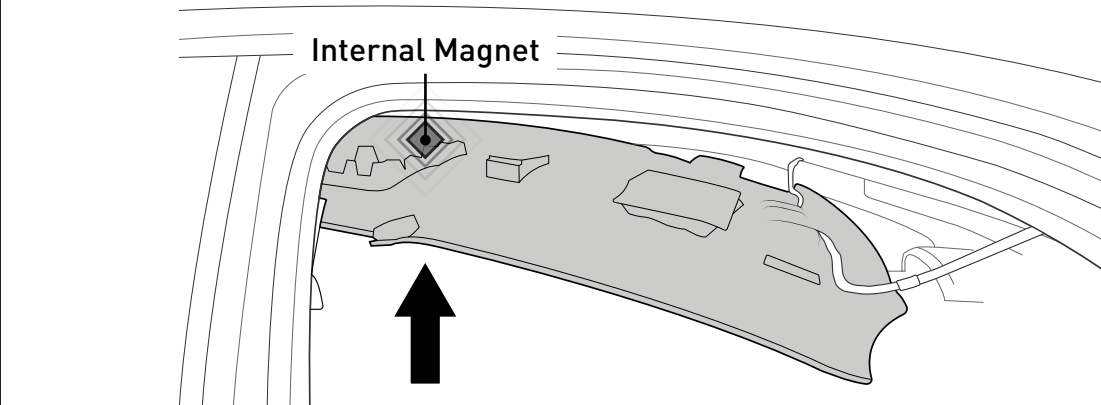

Re-clip **A-pillar**:

NOTE: Reclip wire at base near speakers

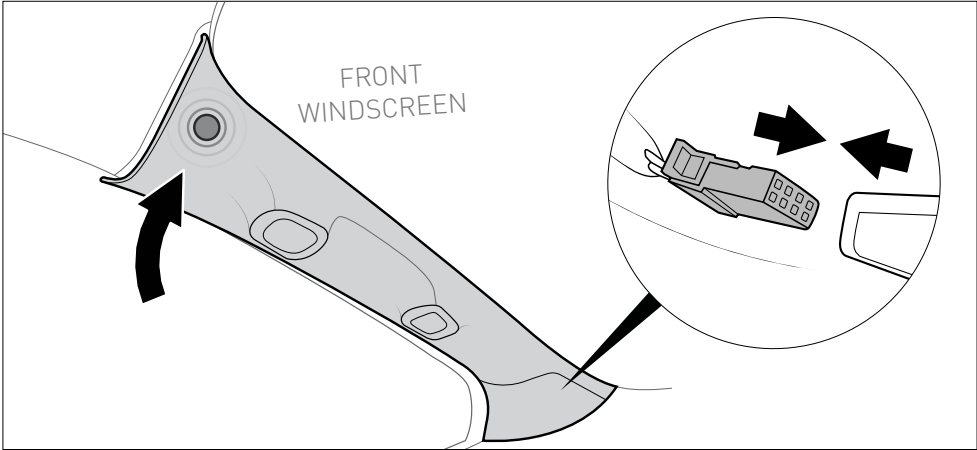

Re-clip **B-pillar**:

NOTE: Reconnect the upper cover to the lower cover. Then starting at the bottom, push both covers back into the body clips, working up towards the top.

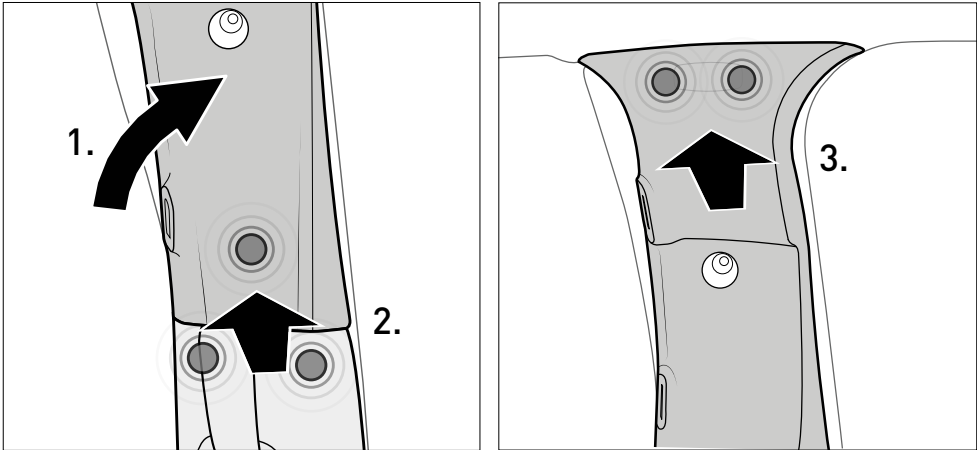

Re-clip **C-pillar**:

NOTE: Connect upper cover to top of lower cover, then push both back onto the vehicle body starting from the bottom and working up.

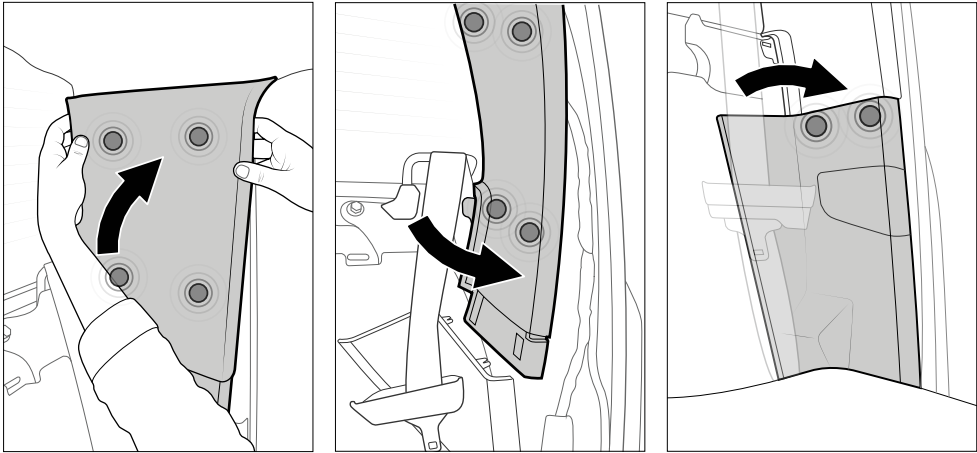

Re-attach **REAR** plastic panel:

NOTE: Ensure all 3 seat belts (left, centre and right) are pulled over the top of the rear plastic trim before clipping the trim back to the vehicle body.

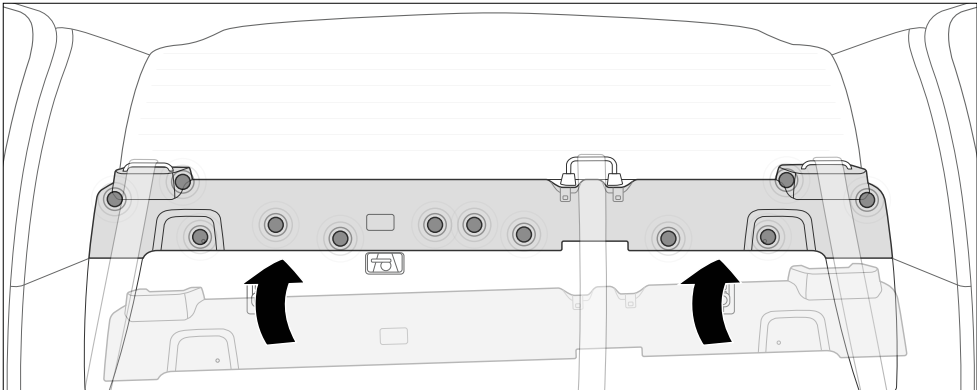

Re-attach **MIDDLE** seatbelt pillar cover:

NOTE: Ensure seatbelt sits on top of cover.

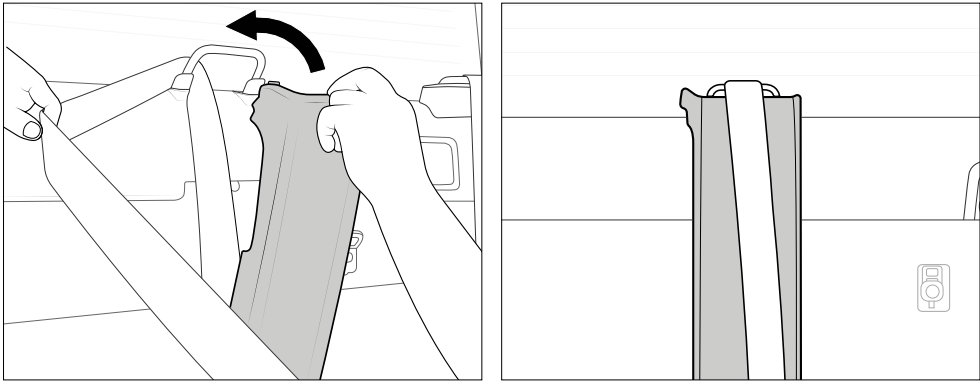

Re-torque **B-pillar** seatbelts:

NOTE: Ensure seatbelt bolts are re-torqued to 48Nm (35lb/ft).

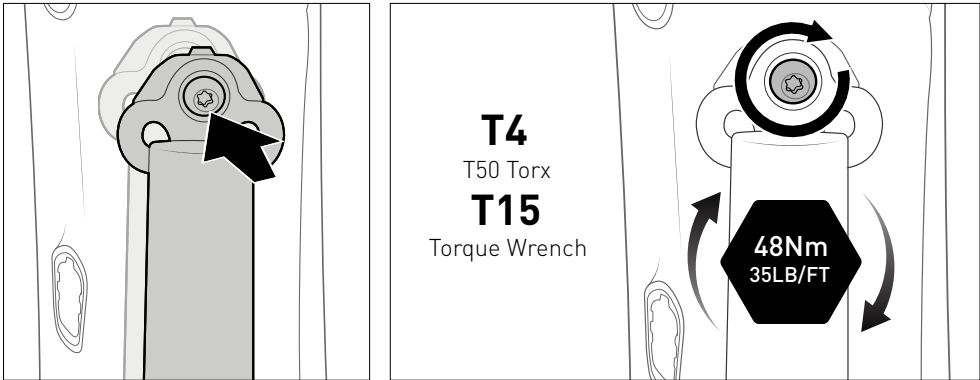

PLATFORM INSTALLATION

P3 41

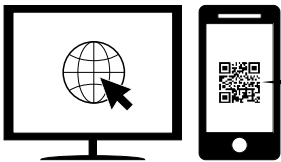

rhinorack.com/roof

1. Complete **Fit my vehicle** journey
2. Select your **Product Solution**
3. Scroll down to **'Product Details'**
4. Select the **'INSTRUCTIONS'** tab to View the Fitting Chart
5. Space your Underbars to the **A, B & C** dimensions provided.

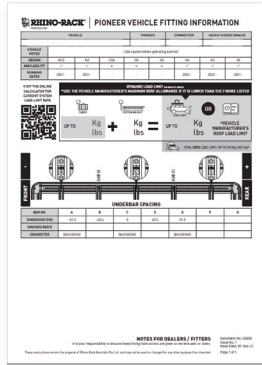

VIEW FITTING CHART
Example only

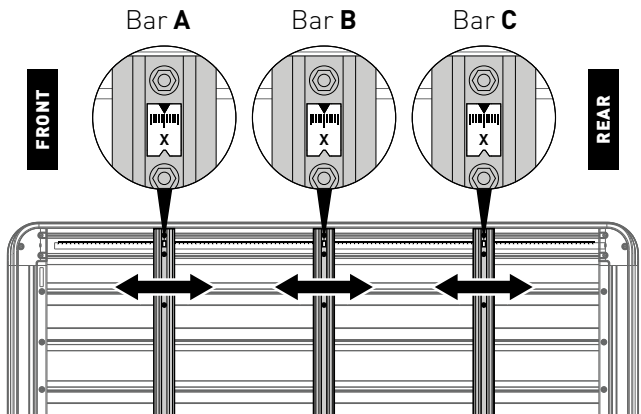
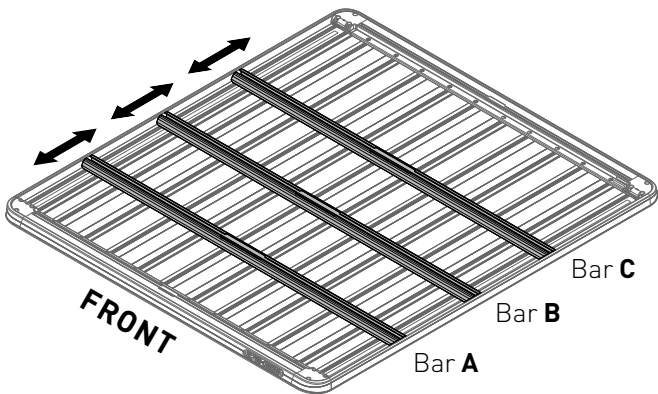

42

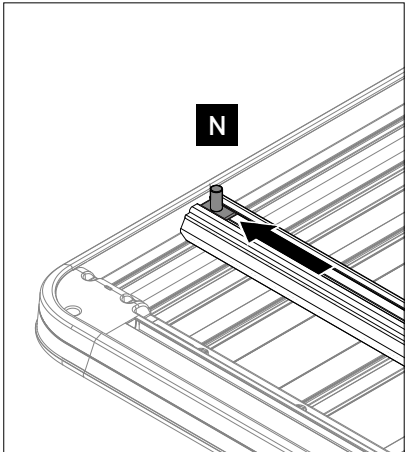
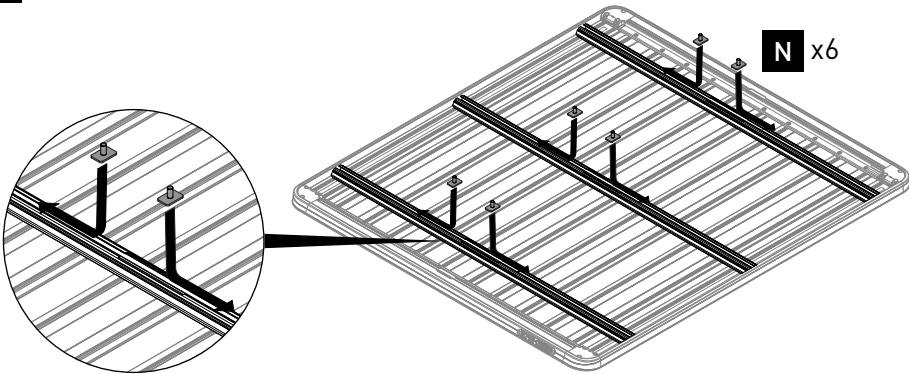

43

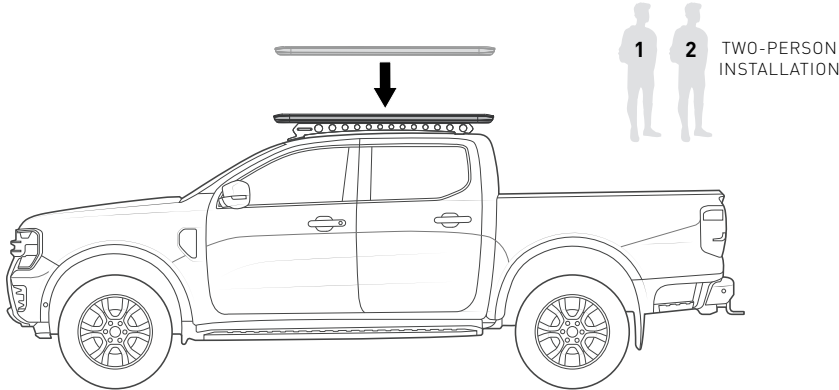

*Ensure washer **O** is used

