



CONTROLLED

RHINO-RACK

RCP28-BK NISSAN PATROL Y62

Important: Please read these instructions carefully prior to installation. Please refer to your fitting instruction to ensure that the roof racks are installed in the correct locations. Check the contents of kit before commencing fitment and report any discrepancies

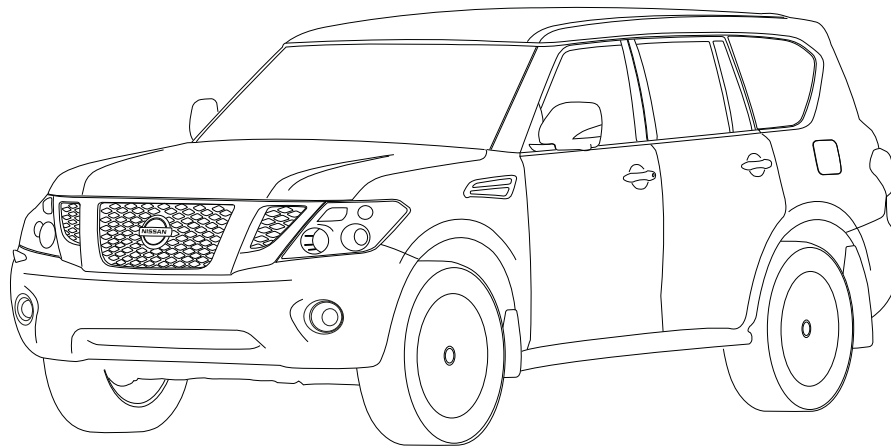

Note: Crossbars and legs sold as separate.

Important Information

1. Check Part No./Kit is correct
2. Read through instruction before installing
3. Fit roof rack accessory
4. Check and recheck all fasteners are secure

Maximum carrying capacity: 80kg evenly distributed over two crossbars. 90kg evenly distributed over three crossbars. Note: Be sure to check the Rhino-Rack website to see if you have the latest version of instructions before beginning installation.

Recommendations:

It is essential that all bolt connections be checked after driving a short distance when you first install your crossbars. Bolt connections should be checked & lubricated at regular intervals (probably once a week is enough, depending on road conditions, usage, loads and distances travelled). You should also check the crossbars each time they are refitted. Make sure to fasten your load securely. Please ensure that all loads are evenly distributed and that the centre of gravity is kept as low as possible.

Crossbars must be removed when putting vehicle through an automatic car wash.

Use only non-stretch fastening ropes or straps.

Caution: The handling characteristics of the vehicle changes when you transport a load on the roof. For safety reasons we recommend you exercise extreme care when transporting wind-resistant loads. Special consideration must be taken into account when cornering and braking.

Load Ratings:

Maximum permissible load is **80kg (176lbs)** for two crossbars and **90kg (198lbs)** for three crossbars, including the weight of the crossbars 5kg (11lbs). When crossbars are to be used in off-road conditions, please build a safety factor of 1.5 into this load limit for off-road use, two crossbars = **53kg (116lbs)**, three crossbars = **60kg (132lbs)**. Although the crossbars are tested and approved to AS1235-2000, Off-road conditions can be much more rigorous.

Note for Dealers and Fitters:

It is your responsibility to ensure instructions are given to the end user or client. Rhino-Rack

3 Pike Street, Rydalmere,
NSW 2116, Australia.
(Ph) (02) 9638 4744
(Fax) (02) 9638 4822

Document No: R1334
Prepared By: Kayle Everett
Authorised By: Chris Murty

Fit Time: 30min
Issue No: 01
Issue Date: 24/04/2017

These instructions remain the property of Rhino-Rack Australia Pty. Ltd. and may not be used or changed for any other purpose than intended.



RCP28-BK NISSAN PATROL Y62

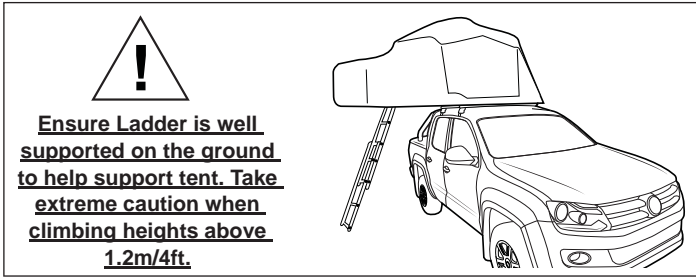
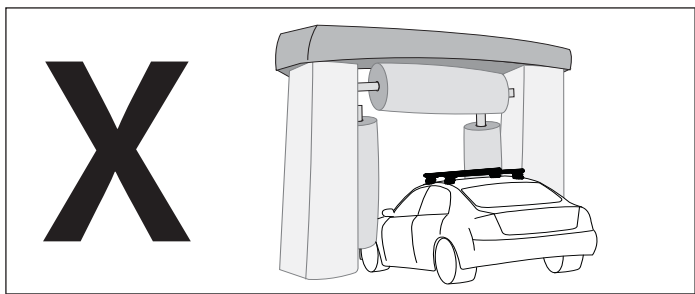
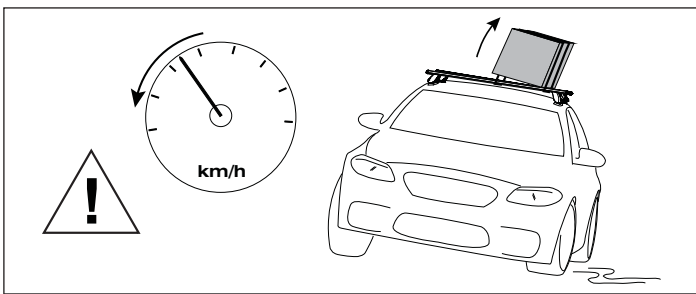
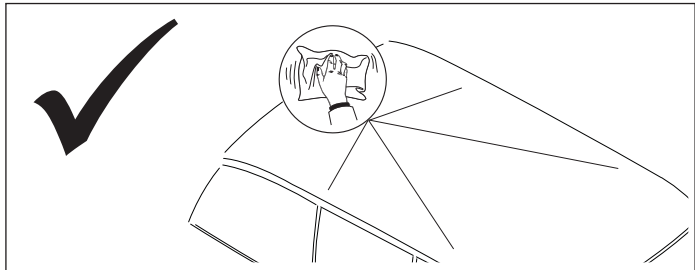
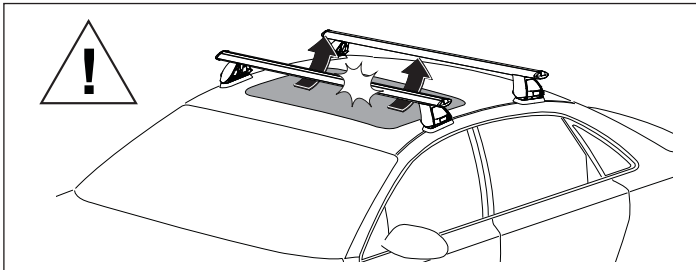
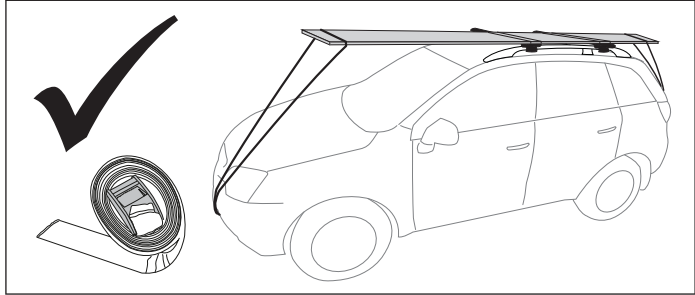
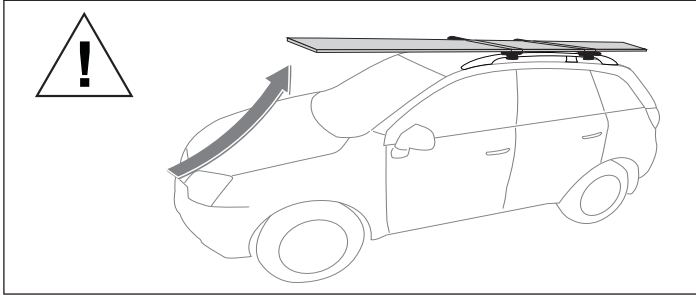

WARNING! Important Load Carrying Instructions

With utility vehicles, the cabin and the canopy move independently. Roof racks and vehicle can be damaged if the item transported is rigidly fixed at points on both the cabin and canopy. Instead, rigidly fix to either the cabin roof racks or the canopy roof racks.

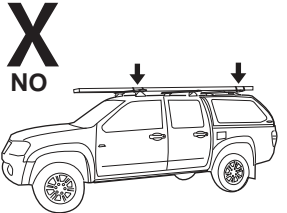
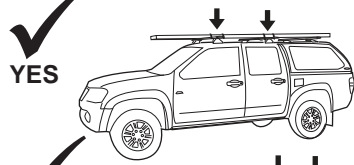
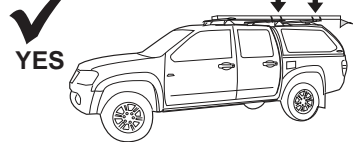
Paddle/ Surfboards should be fixed to the front of the vehicle.



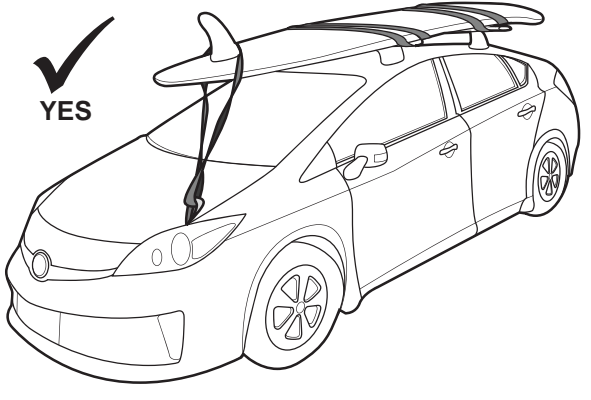

RCP28-BK NISSAN PATROL Y62

Parts List

| Item | RCP28-BK | Qty | Part No. |
|------|----------------------------------|-----|----------|
| 1 | Base pad FR (includes M6 Finloc) | 1 | M615 |
| 2 | Base pad FL (includes M6 Finloc) | 1 | M614 |
| 3 | Base pad MR (includes M6 Finloc) | 1 | M617 |
| 4 | Base pad ML (includes M6 Finloc) | 1 | M616 |
| 5 | Base pad RR (includes M6 Finloc) | 1 | M619 |
| 6 | Base pad RL (includes M6 Finloc) | 1 | M618 |
| 7 | Right skirt | 3 | M621 |
| 8 | Left skirt | 3 | M620 |
| 9 | M6 x 25mm Hex Setscrew | 6 | B001 |
| 10 | M6 Spring Washer | 6 | W004 |
| 11 | M6 x 16mm Flat Washer | 6 | W031 |
| 12 | M8 x 40mm Socket Head Screw | 4 | B162 |
| 13 | M8 x 50mm Socket Head Screw | 4 | B192 |
| 14 | M8 x 60mm Socket Head Screw | 4 | B198 |
| 15 | O-Ring | 12 | C299 |
| 16 | Sealing Plate | 12 | C588 |
| 17 | M8 x 19mm Flat Washer | 12 | W043 |
| 18 | M8 Spring Washer | 12 | W019 |
| 19 | Cover Plate | 6 | M126 |
| 20 | 6mm Allen Key | 1 | H009 |
| 21 | M6 Washer (used on cover plate) | 6 | W003 |
| 22 | Instructions | 1 | R1334 |

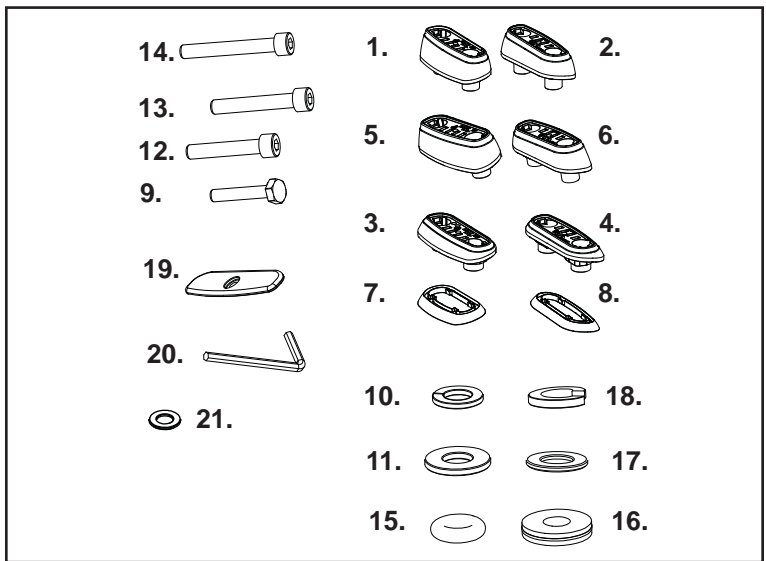

Tools required:

- Allen key (provided)
- Flat head screwdriver.
- 10mm socket wrench

Instructions

1 Note mount point positions

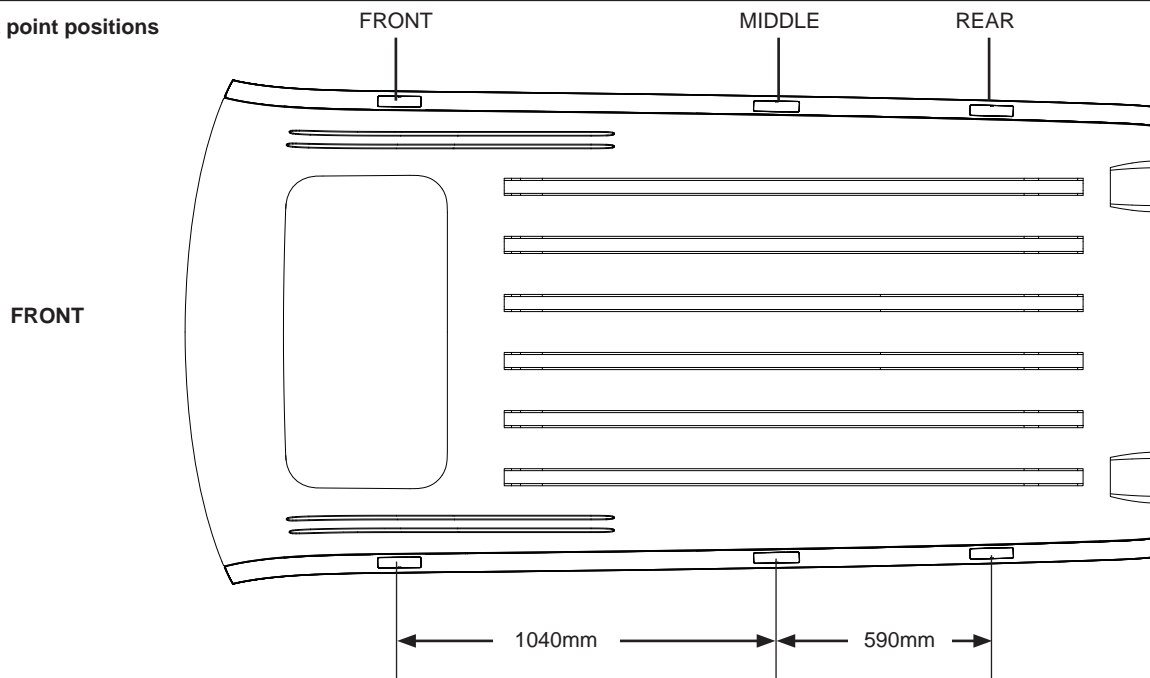

2 Use a flat head screwdriver to remove roof trim covers. Store the covers for future use if the base pads and racks are completely removed.

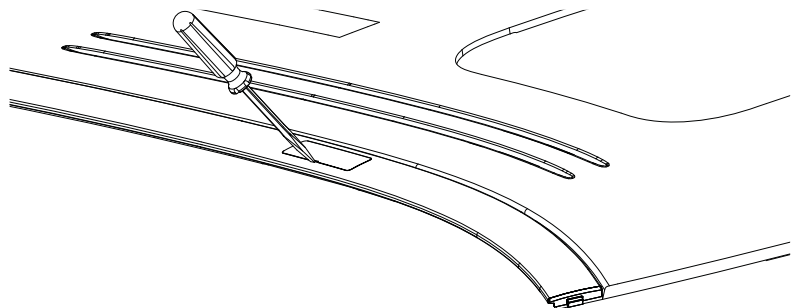



RCP28-BK NISSAN PATROL Y62

- 3** Use a Phillips head screwdriver to remove plastic plugs. Store the plugs for future use if the base pads and racks are completely removed.

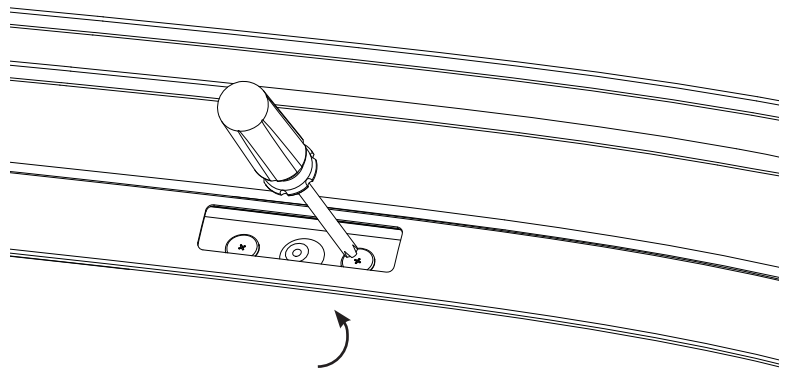

- 4** Clean all surfaces in and around where the base pads attach.

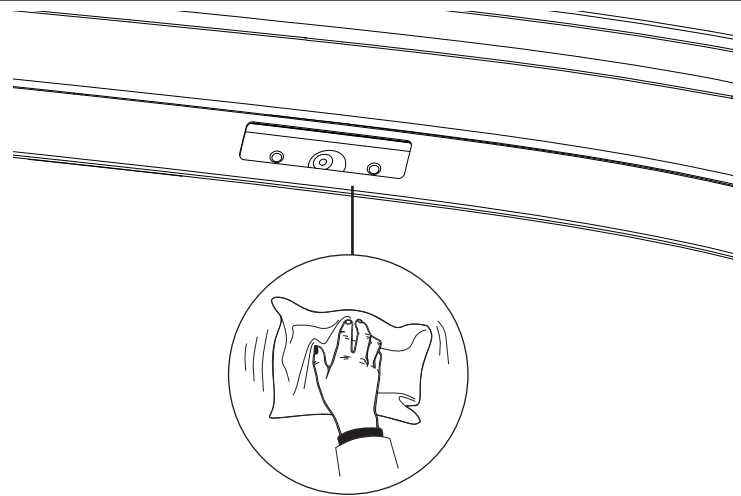

- 5** Attach left & right rubber skirts to the corresponding base

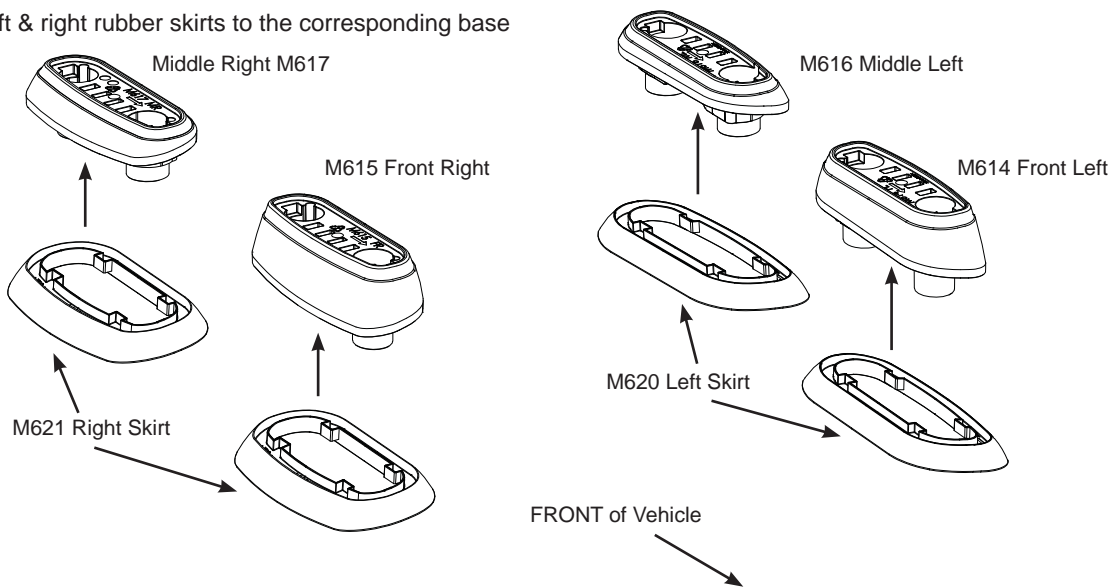

- 6** Attach rear left & right rubber skirts to the corresponding base pads.

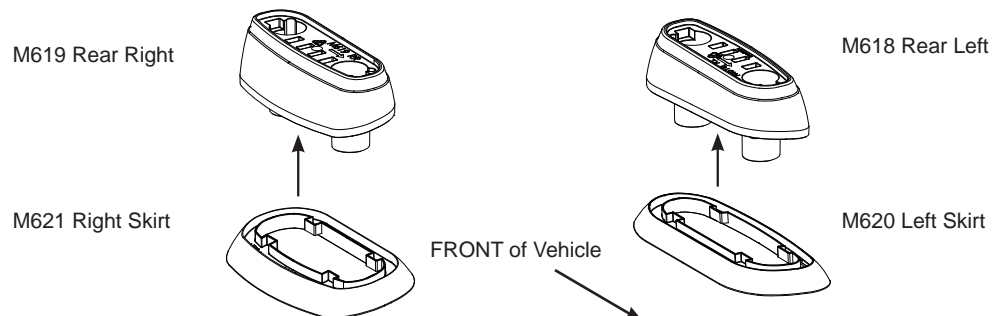



RCP28-BK NISSAN PATROL Y62

7 Attach M8 bolt assembly to Front base pads.

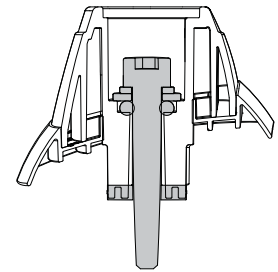
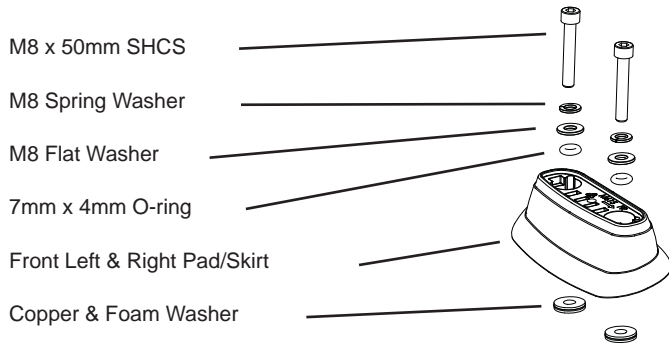

FRONT
Roof Pad & Bolt assembly

8 Attach M8 bolt assembly to Middle base pads.

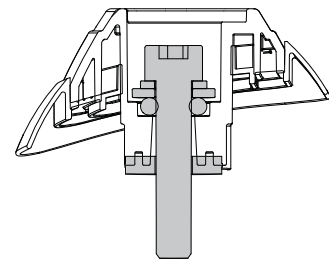
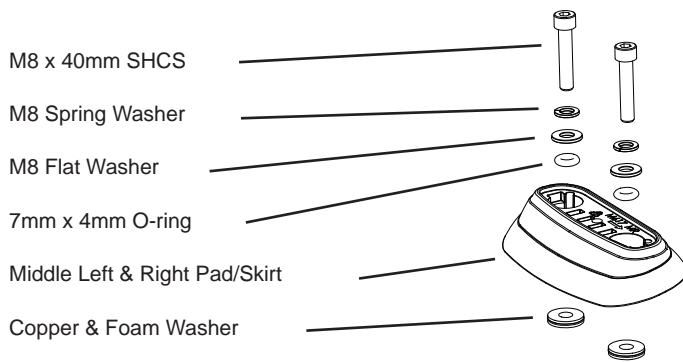

MIDDLE
Roof Pad & Bolt assembly

9 Attach M8 bolt assembly to Rear base pads.

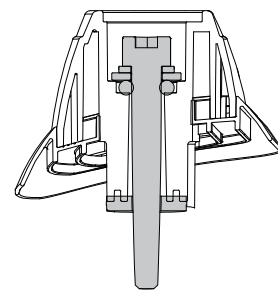
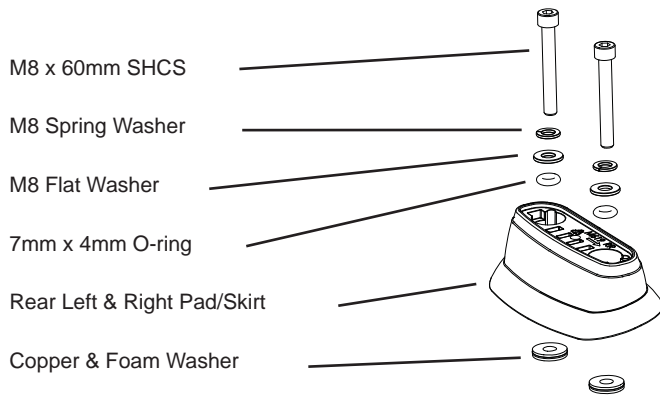

REAR
Roof Pad & Bolt assembly

10 Fit base pad assemblies to roof of vehicle. Make sure the rubber skirt does not fold under the base pad when fitted. Repeat for left side of vehicle.

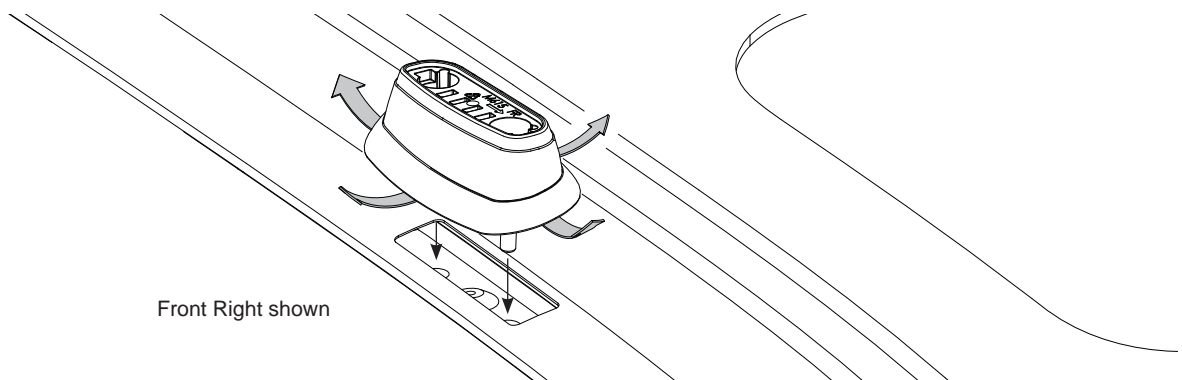



RCP28-BK NISSAN PATROL Y62

- 11** Fasten the M8 bolts of all base pads with the supplied 6mm allen key. Recommended torque 8-9 Nm (6-7 lb/ft).

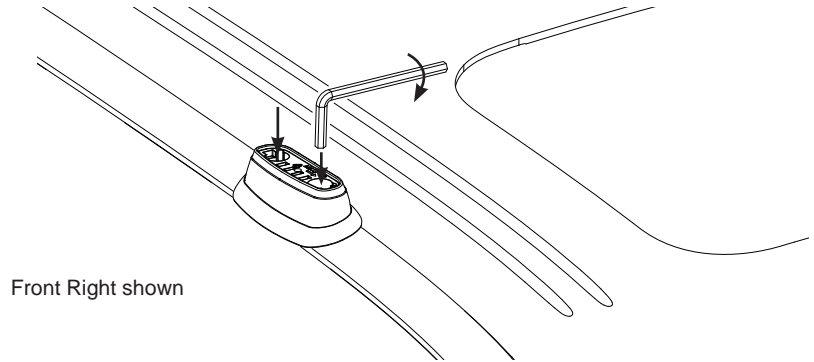

12 When Crossbars are removed

Removal of crossbars is the reverse of installation.

There is no need to remove the base pads. They should remain on the vehicle to maintain the sealing of the copper & foam washers.

Fit the base pad cover plates to prevent excessive amounts of dirt from contaminating.

Fasten screws 3-4 Nm (2-3 lb/ft).

