

Kit 1239

MITSUBISHI Lancer, 4-dr Sedan, 00-03, 04-07 / *02-07

MITSUBISHI Lancer, 5-dr Estate, 00-03, 04-07

MITSUBISHI Lancer Sportback, 5-dr Wagon, *04-05

MITSUBISHI Lancer Cedia, 4-dr Sedan, 01-03

MITSUBISHI Lancer EVO VII, 4-dr Sedan, 01-03

MITSUBISHI Lancer EVO, 4-dr Sedan, *02-07

*North America

480R
754

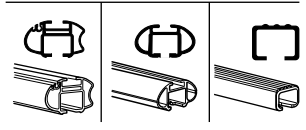
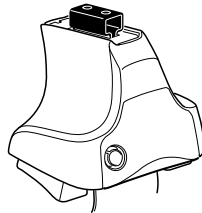

480

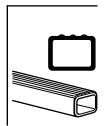
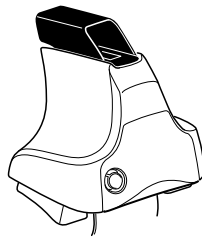

750

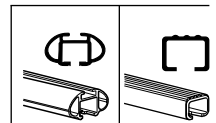
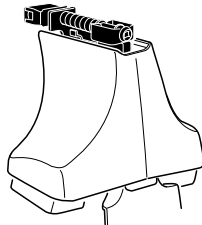

THULE[®]
SWEDEN

ISO 11154-E

xx kg
 xx lbs + 7 kg
 15,4 lbs = **Max. 60kg**
Max. 132 lbs

80 km/h 50 Mph
 130 km/h 80 Mph
 40 km/h 25 Mph
km/h Mph

THULE + **Kit XXXX**

x1 x4 x4 x4

480R/754

x1 x4 x4 x4

480

x1 x4 x4

750

x2	x2	x2	x2	x2
x2		x2	x2	
x2		x2	x2	
x4		x4	x4	

419 x 2
 420 x 2
 52 x 4
 x1

Kit

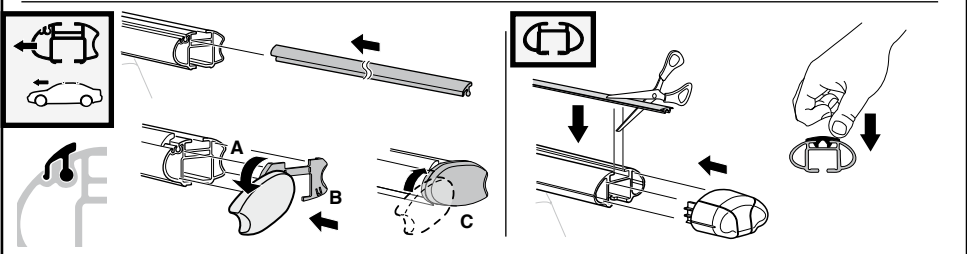
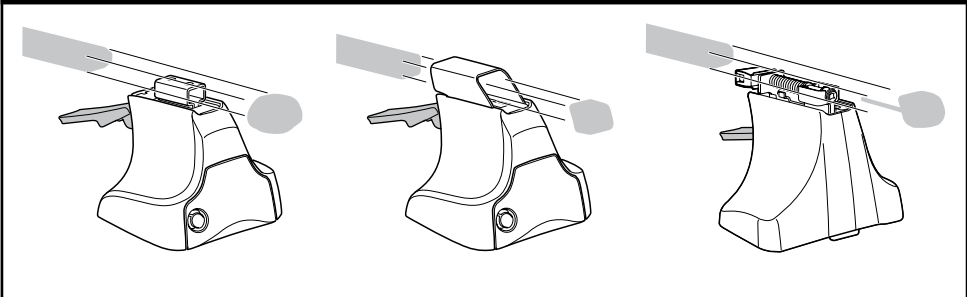

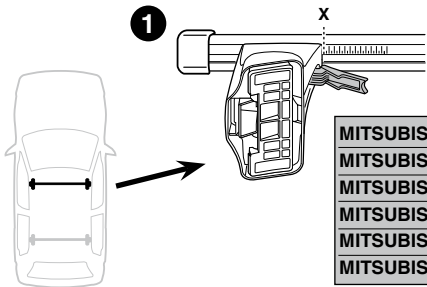
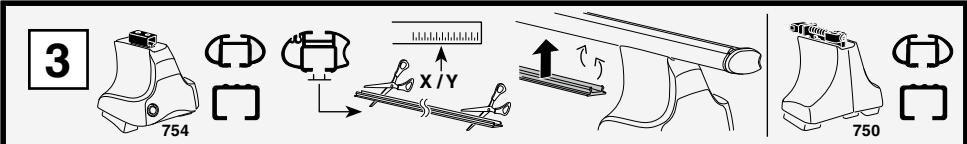

	X
MITSUBISHI Lancer , 4-dr Sedan, 00-03, 04-07 / *02-07	35,5
MITSUBISHI Lancer , 5-dr Estate, 00-03, 04-07	35,5
MITSUBISHI Lancer Sportback , 5-dr Wagon, *04-05	35,5
MITSUBISHI Lancer Cedia , 4-dr Sedan, 01-03	36,5
MITSUBISHI Lancer EVO VII , 4-dr Sedan, 01-03	36,5
MITSUBISHI Lancer EVO , 4-dr Sedan, *02-07	36,5

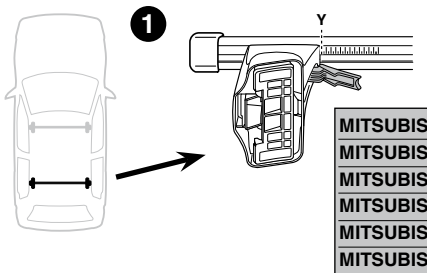

	Y
MITSUBISHI Lancer , 4-dr Sedan, 00-03, 04-07 / *02-07	30,5
MITSUBISHI Lancer , 5-dr Estate, 00-03, 04-07	32
MITSUBISHI Lancer Sportback , 5-dr Wagon, *04-05	32
MITSUBISHI Lancer Cedia , 4-dr Sedan, 01-03	31
MITSUBISHI Lancer EVO VII , 4-dr Sedan, 01-03	31
MITSUBISHI Lancer EVO , 4-dr Sedan, *02-07	31

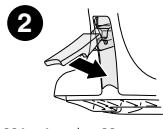
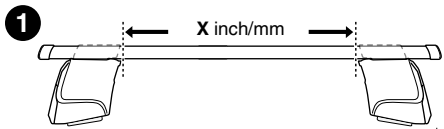
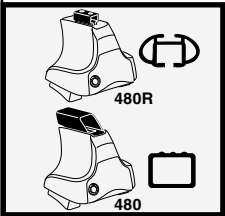

	X inch	X mm
MITSUBISHI Lancer , 4-dr Sedan, 00-03, 04-07 / *02-07	39 ⁵ / ₈ "	1006 mm
MITSUBISHI Lancer , 5-dr Estate, 00-03, 04-07	39 ⁵ / ₈ "	1006 mm
MITSUBISHI Lancer Sportback , 5-dr Wagon, *04-05	39 ⁵ / ₈ "	1006 mm
MITSUBISHI Lancer Cedia , 4-dr Sedan, 01-03	40 "	1016 mm
MITSUBISHI Lancer EVO VII , 4-dr Sedan, 01-03	40 "	1016 mm
MITSUBISHI Lancer EVO , 4-dr Sedan, *02-07	40 "	1016 mm

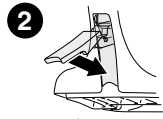
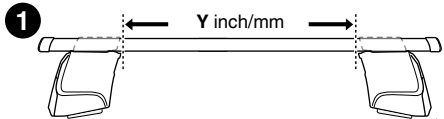

	Y inch	Y mm
MITSUBISHI Lancer , 4-dr Sedan, 00-03, 04-07 / *02-07	37 ⁵ / ₈ "	956 mm
MITSUBISHI Lancer , 5-dr Estate, 00-03, 04-07	38 ¹ / ₄ "	971 mm
MITSUBISHI Lancer Sportback , 5-dr Wagon, *04-05	38 ¹ / ₄ "	971 mm
MITSUBISHI Lancer Cedia , 4-dr Sedan, 01-03	37 ⁷ / ₈ "	961 mm
MITSUBISHI Lancer EVO VII , 4-dr Sedan, 01-03	37 ⁷ / ₈ "	961 mm
MITSUBISHI Lancer EVO , 4-dr Sedan, *02-07	37 ⁷ / ₈ "	961 mm

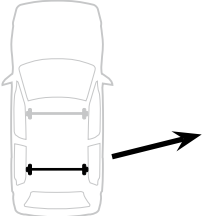

4**MITSUBISHI Lancer, 4-dr Sedan, 00-03, 04-07 / *02-07****MITSUBISHI Lancer, 5-dr Estate, 00-03, 04-07****MITSUBISHI Lancer Sportback, 5-dr Wagon, *04-05****MITSUBISHI Lancer Cedia, 4-dr Sedan, 01-03****MITSUBISHI Lancer EVO VII, 4-dr Sedan, 01-03****MITSUBISHI Lancer EVO, 4-dr Sedan, *02-07**

52

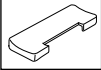

420

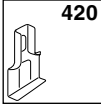

FL ↓



52

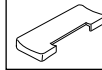

420

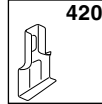

↓ FR



52

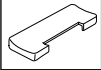

419

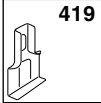

↓ RL



52

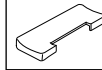

419

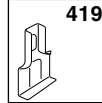

RR ↓



480R/754



480

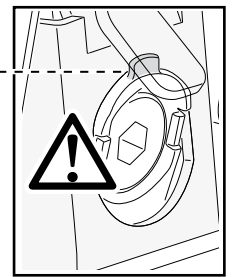
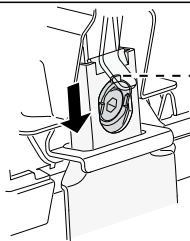
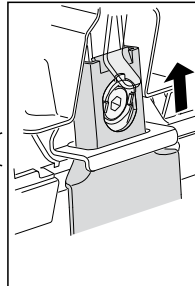
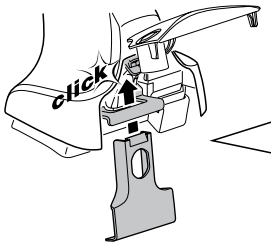
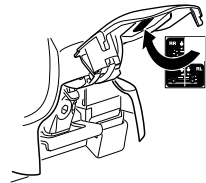
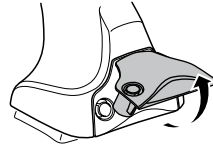
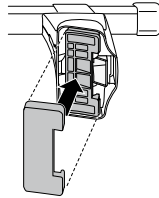

750

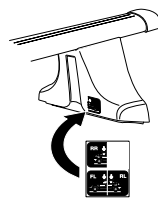
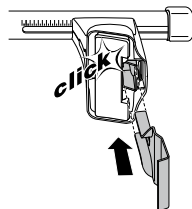
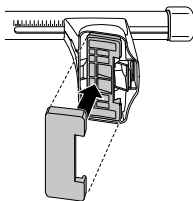

5

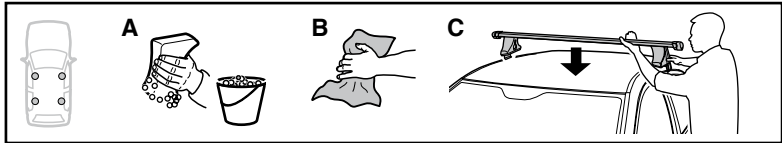

	X mm	Y mm	X inch	Y inch
MITSUBISHI Lancer , 4-dr Sedan, 00-03, 04-07 / *02-07	255 mm	650 mm	10"	25 ⁵ / ₈ "
MITSUBISHI Lancer , 5-dr Estate, 00-03, 04-07	300 mm	750 mm	11 ³ / ₄ "	29 ¹ / ₂ "
MITSUBISHI Lancer Sportback , 5-dr Wagon, *04-05	300 mm	750 mm	11 ³ / ₄ "	29 ¹ / ₂ "
MITSUBISHI Lancer Cedia , 4-dr Sedan, 01-03	255 mm	650 mm	10"	25 ⁵ / ₈ "
MITSUBISHI Lancer EVO VII , 4-dr Sedan, 01-03	255 mm	650 mm	10"	25 ⁵ / ₈ "
MITSUBISHI Lancer EVO , 4-dr Sedan, *02-07	255 mm	650 mm	10"	25 ⁵ / ₈ "

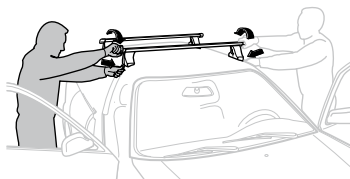
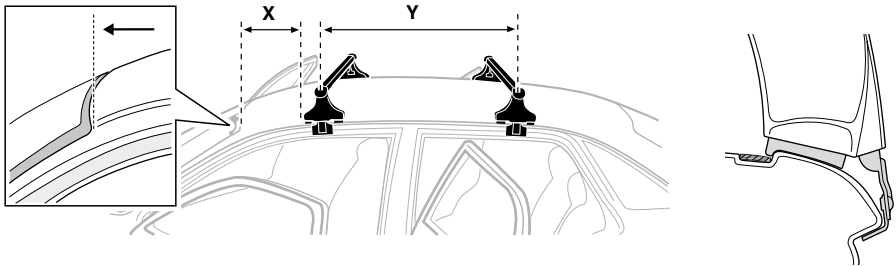

GB/US Tighten alternately

D Die Schrauben abwechselnd anziehen

F Serrer alternativement chaque côté

NL Afwisselend aan de linker- en de rechterkant aandraaien

I Alternare il serraggio delle viti

E Serrare alternativamente

PT Aperte alternadamente

S Dra åt växelvis

FIN Kierrä vuorotellen

EST Pinguldage vaheldumisi

LAT Pievelciet pamišus

LIT Užsukinėkite pakaitomis

PL Śruby dokręcaj naprzemiennie

RU Затягивайте попеременно

CZ Pokręťta bagażníka dokręcaj dokręcaj naprzemiennie.

SK Doťahujte striedavo

SLO Privijajte izmenično.

HR Naizmjenično zategnite

HU Egymástól függetlenül szorítandó

GR Σφιγγετε εναλλάξ

TR Dönüşümlü sıkın

中文 交替拧紧

한국어 번갈아 가며 조이십시오.

日本語 交互に締め付けてください。

ไทย ชันโนแบบสลับ

6

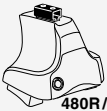

480R/754



480

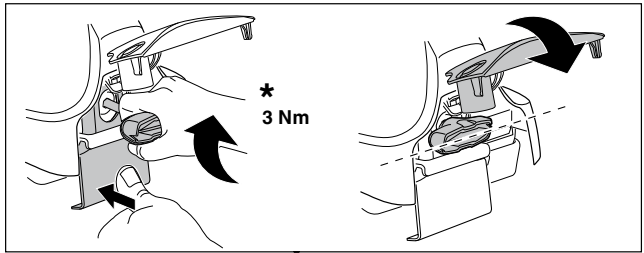
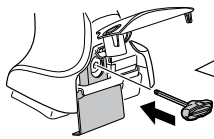

*
3 Nm



*



*
≈ 3 Nm

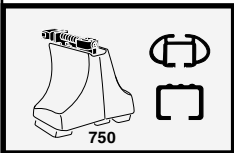
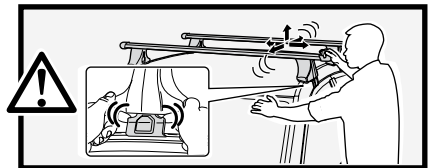

750

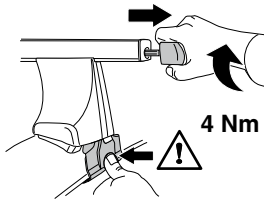

4 Nm

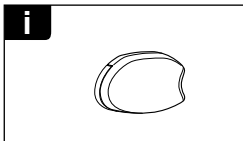
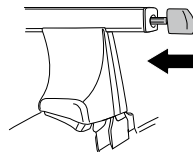

i

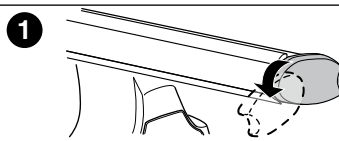

1

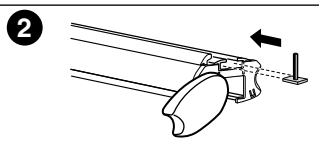

2

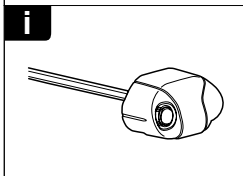

i

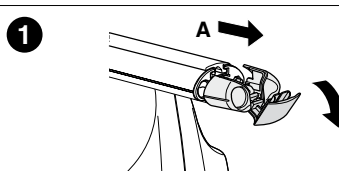

1

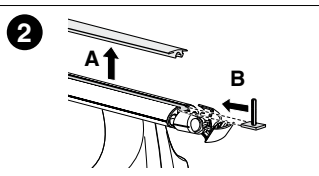

2

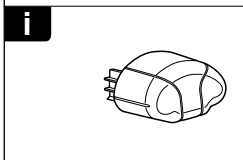

i

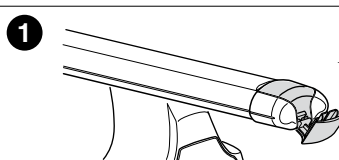

1

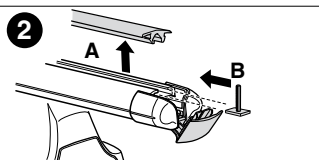

2



THULE
SWEDEN
**ONE
KEY
SYSTEM**



		(x4)
		(x6)
		(x8)
NA		(x10)
EUR		(x12)
ASIA		(x12)



WW ▶ Thule Sweden AB, Box 69, 330 33 Hillerstorp, SWEDEN
NA ▶ Thule Inc., 42 Silvermine Road, Seymour, Connecticut 06483, USA

info@thule.com
customer.service@thule.com

www.thule.com

503-1239-02