

# Kit 1058

SUBARU Legacy Wagon, 5-dr Estate, 94-02

480R  
754

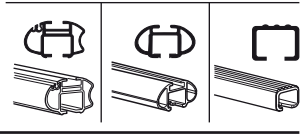
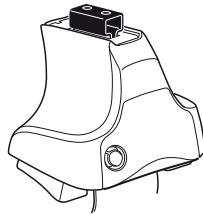

480

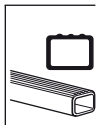
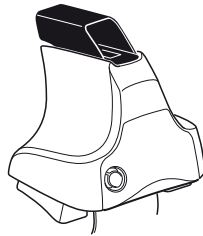

750

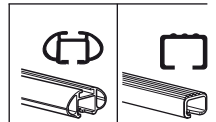
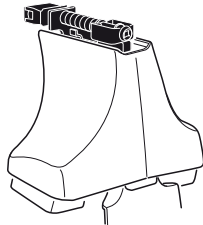

**THULE**<sup>®</sup>  
SWEDEN

ISO 11154-E

**Kit**



**3**

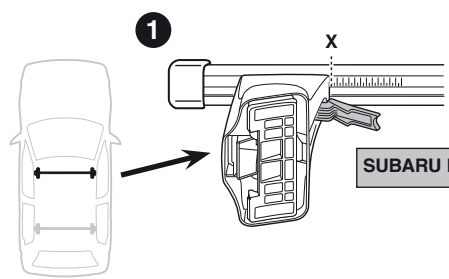
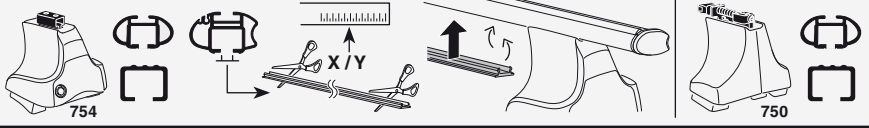

<b>1</b>	<b>X</b>
<b>SUBARU Legacy Wagon, 5-dr Estate, 94-02</b>	<b>24,5</b>

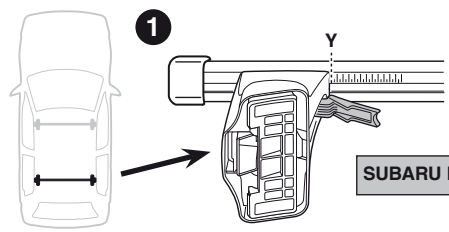
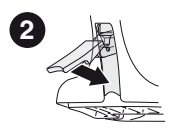

<b>1</b>	<b>Y</b>
<b>SUBARU Legacy Wagon, 5-dr Estate, 94-02</b>	<b>24</b>

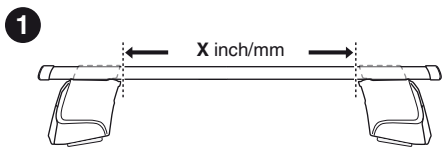
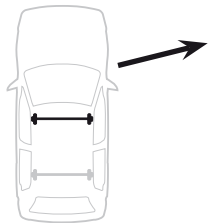
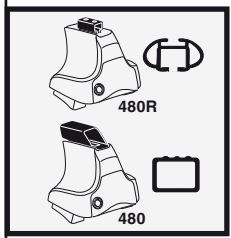
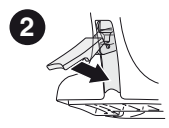

<b>1</b>	<b>X inch/mm</b>	<b>X inch</b>	<b>X mm</b>
<b>SUBARU Legacy Wagon, 5-dr Estate, 94-02</b>		<b>35 1/4"</b>	<b>896 mm</b>

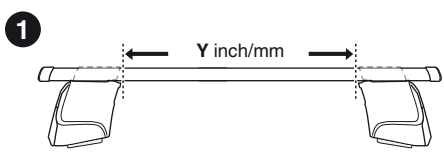
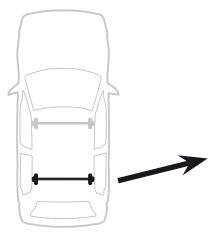
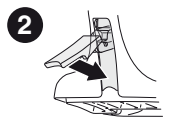

<b>1</b>	<b>Y inch/mm</b>	<b>Y inch</b>	<b>Y mm</b>
<b>SUBARU Legacy Wagon, 5-dr Estate, 94-02</b>		<b>35 1/8"</b>	<b>891 mm</b>

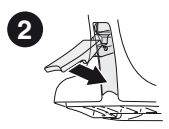

4

SUBARU Legacy Wagon, 5-dr Estate, 94-02

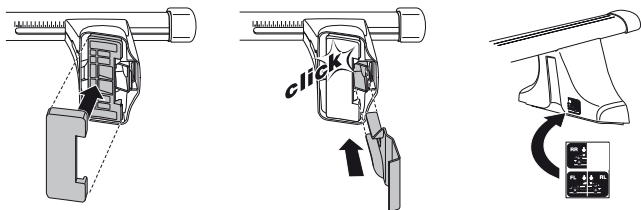
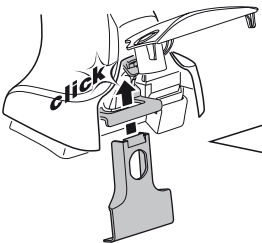
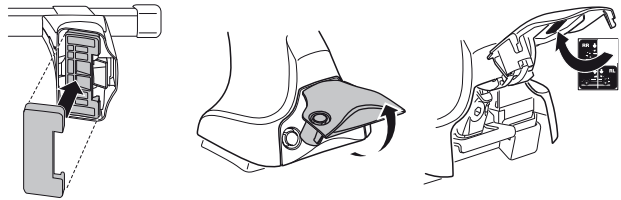
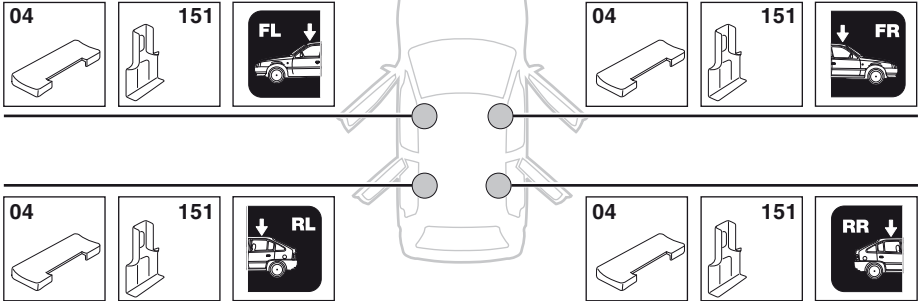

5



SUBARU Legacy Wagon, 5-dr Estate, 94-02

X mm

Y mm

X inch

Y inch

570 mm

700 mm

22 1/2"

27 1/2"

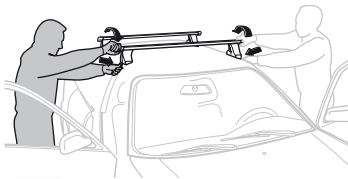
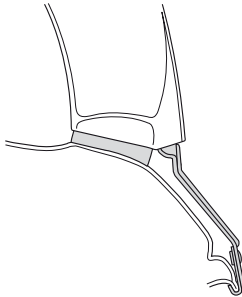
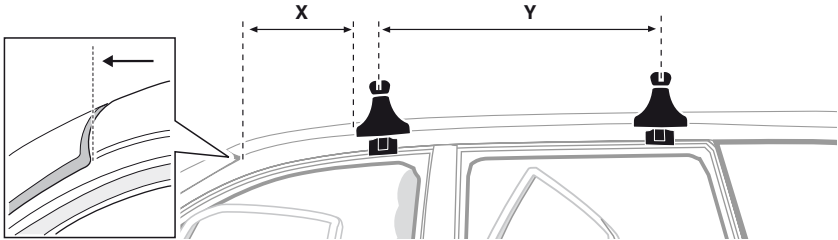

GB/US Tighten alternately

D Die Schrauben abwechselnd anziehen

F Serrer alternativement chaque côté

NL Afwisselend aan de linker- en de rechterkant aandraaien

I Alternare il serraggio delle viti

E Apertar alternativamente

PT Aperte alternadamente

S Dra åt växelvis

FIN Kierrä vuorotellen

EST Pinguldage vaheldumisi

LAT Pievelciēt pamīšus

LIT Užsukinėkite pakaitomis

PL Śruby dokręcaj naprzemiennie

RU Затягивайте попеременно

CZ Pokręťta багаžníka dokręcaj dokręcaj naprzemiennie.

SK Doťahujte striedavo

SLO Privijajte izmenično.

HR Naizmjenično zategnite

HU Egymástól függetlenül szorítandó

GR Σφιγγετε εναλλάξ

TR Dönüşümlü sıkın

中文 交替拧紧

한국어 번갈아 가며 조이십시오.

日本語 交互に締め付けてください。

ไทย ชันในแบบสลับ

6



480R/754



480

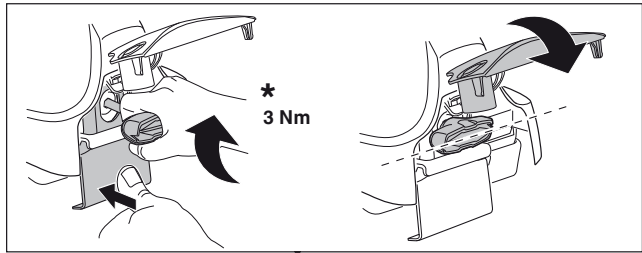
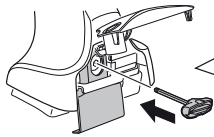

\*  
3 Nm

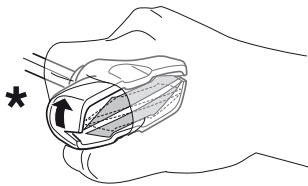

\*

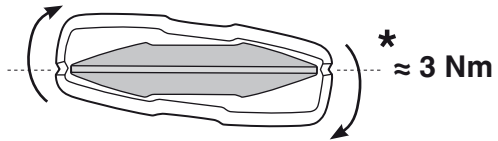

\*  
≈ 3 Nm

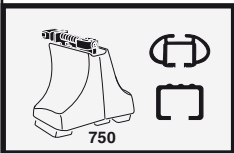
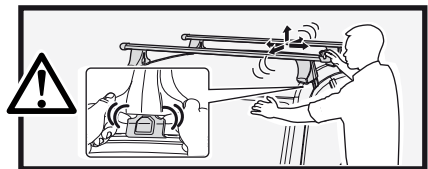

750

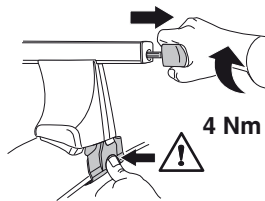

4 Nm

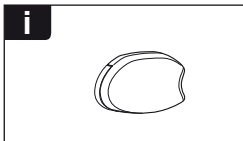
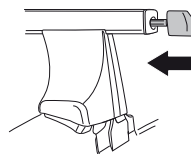

i

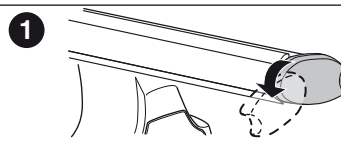

1

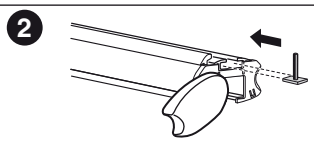

2

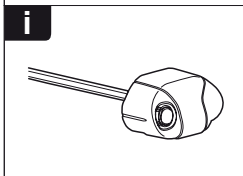

i

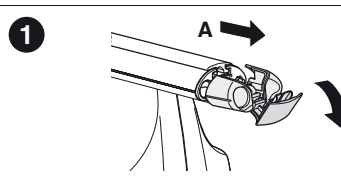

1

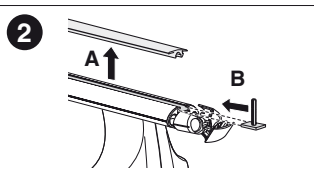

2

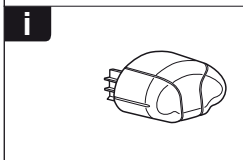

i

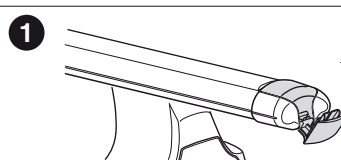

1

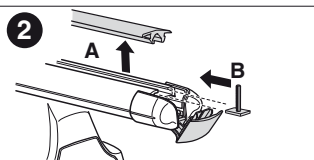

2

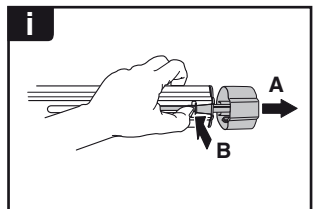
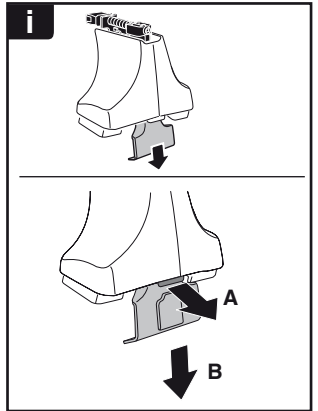

**THULE**  
SWEDEN  
**ONE  
KEY  
SYSTEM**



		(x4)
		(x6)
		(x8)
NA		(x10)
EUR		(x12)
ASIA		(x12)



WW ▶ Thule Sweden AB, Box 69, 330 33 Hillerstorp, SWEDEN  
NA ▶ Thule Inc., 42 Silvermine Road, Seymour, Connecticut 06483, USA

info@thule.com  
customer.service@thule.com

www.thule.com