

# Kit 1007

RENAULT Laguna I, 5-dr Hatchback, 94-00

480R  
754

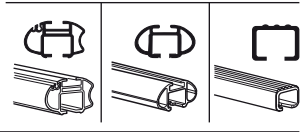
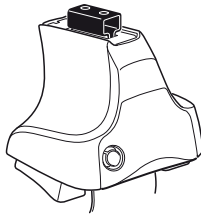

480

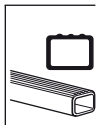
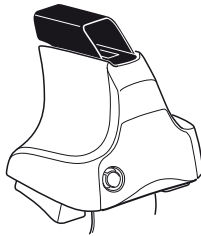

750

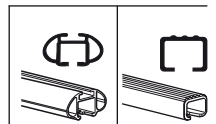
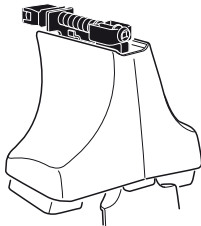

**Kit**



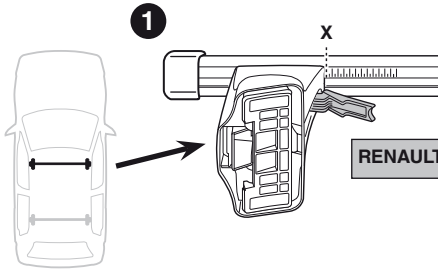

X
RENAULT Laguna I, 5-dr Hatchback, 94-00
33

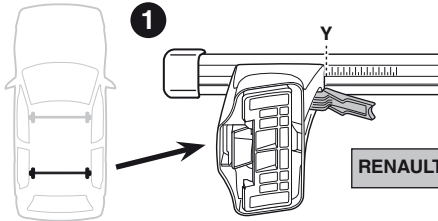

Y
RENAULT Laguna I, 5-dr Hatchback, 94-00
30,5

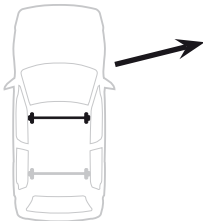
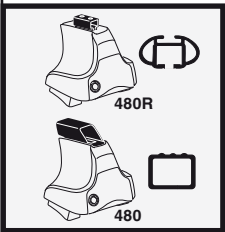

X inch/mm	X inch	X mm
RENAULT Laguna I, 5-dr Hatchback, 94-00	38 <sup>5</sup> / <sub>8</sub> "	981 mm

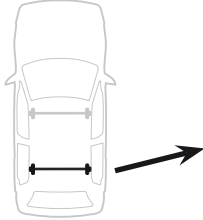

Y inch/mm	Y inch	Y mm
RENAULT Laguna I, 5-dr Hatchback, 94-00	37 <sup>5</sup> / <sub>8</sub> "	956 mm



4

RENAULT Laguna I, 5-dr Hatchback, 94-00

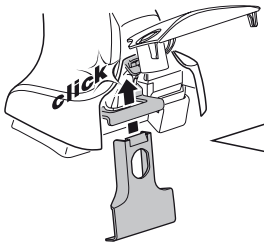
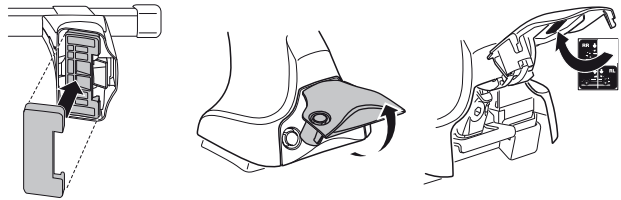
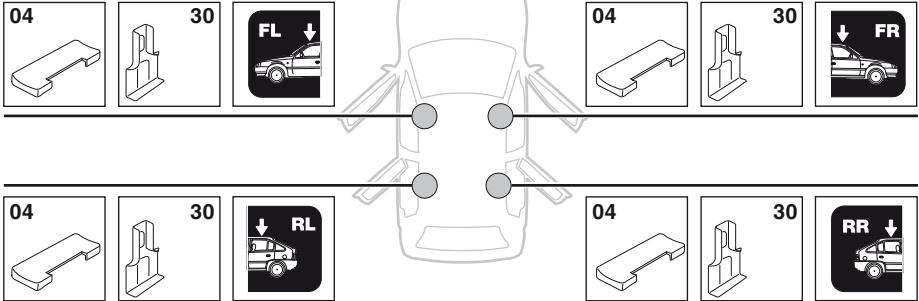

5

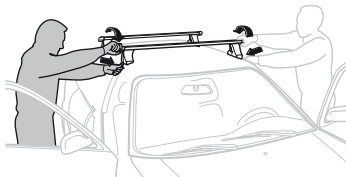
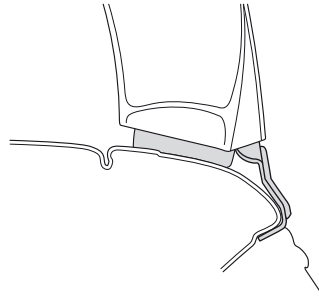
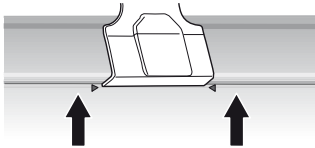
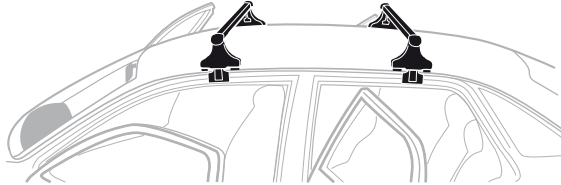

**GB/US** Tighten alternately

**D** Die Schrauben abwechselnd anziehen

**F** Serrer alternativement chaque côté

**NL** Afwisselend aan de linker- en de rechterkant aandraaien

**I** Alternare il serraggio delle viti

**E** Apretar alternativamente

**PT** Aperte alternadamente

**S** Dra åt växelvis

**FIN** Kierrä vuorotellen

**EST** Pinguldage vaheldumisi

**LAT** Pielieciet pamišus

**LIT** Užsukinėkite pakaitomis

**PL** Śruby dokręcaj naprzemiennie

**RU** Затягивайте попеременно

**CZ** Pokręťta багаžníka dokręcaj dokręcaj naprzemiennie.

**SK** Doťahujte striedavo

**SLO** Privijajte izmenično.

**HR** Naizmjenično zategnite

**HU** Egymástól függetlenül szorítandó

**GR** Σφιγγετε εναλλάξ

**TR** Dönüşümlü sıkın

**中文** 交替拧紧

**한국어** 번갈아 가며 조이십시오.

**日本語** 交互に締め付けてください。

**ไทย** ชันโนแบบสลับ

6



480R/754



480

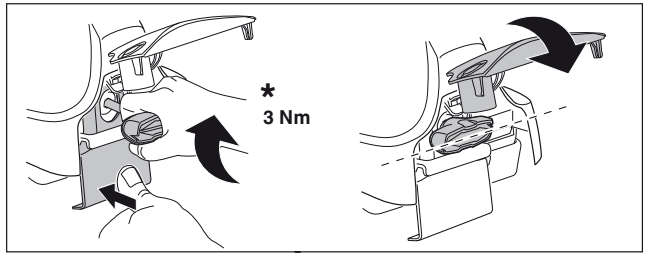
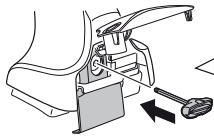

\*  
3 Nm



\*

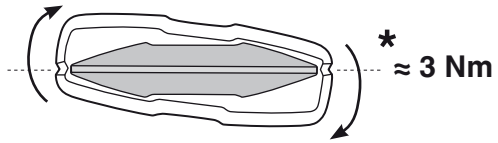

\*  
≈ 3 Nm

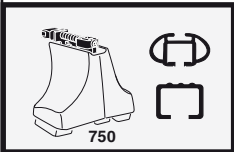
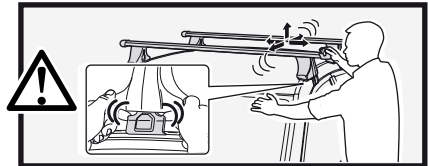

750

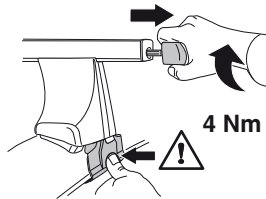

4 Nm

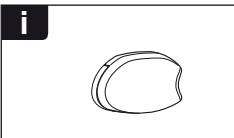
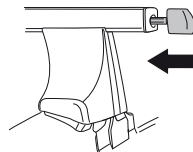

i

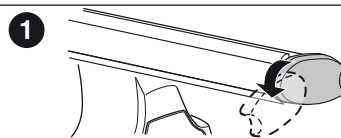

1

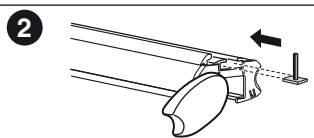

2

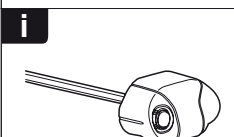

i

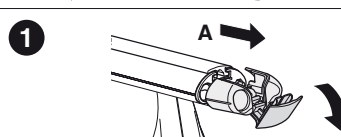

1

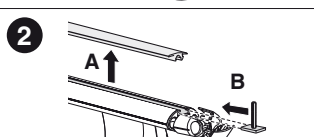

2

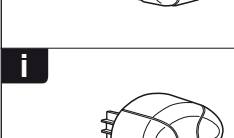

i

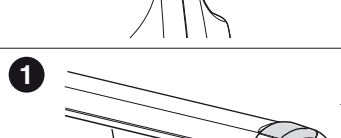

1

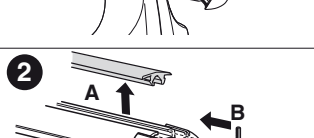

2

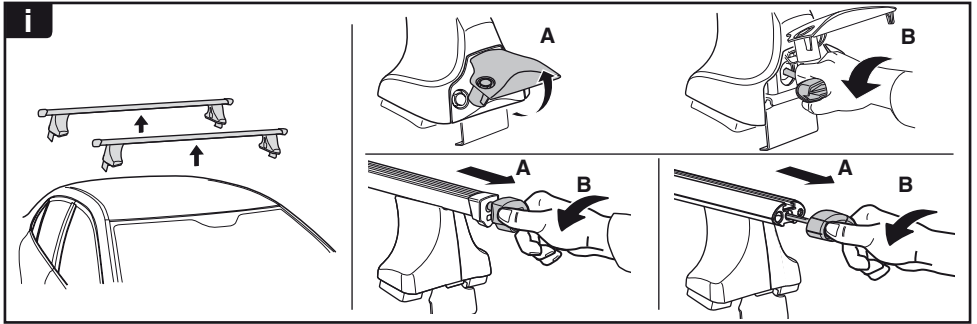

**THULE**  
SWEDEN  
**ONE  
KEY  
SYSTEM**



- 544 (x4)
- 596 (x6)
- 588 (x8)
- NA 510 (x10)
- EUR 452 (x12)
- ASIA

