

**HAYMAN REESE**  
PART No: 03202RW  
**GREAT WALL STEED NBP CL4**

**INSTALLATION INSTRUCTIONS**

PLEASE ENSURE THAT INSTRUCTIONS ARE UNDERSTOOD PRIOR TO FITMENT  
PLACE THESE INSTRUCTIONS IN THE VEHICLE'S GLOVEBOX AFTER INSTALLATION IS COMPLETED



Installation Time: Approx **120** Mins

**Towbar Installation Instructions**

**Towbar capacity**

**GREAT WALL STEED NBP CL4**

Part Number **03202RW**

Max Towing Braked **2000** kg

Max Towing Unbraked **750** kg

Max Static Ball Load **200** kg

Tail Harness Length Required: 04936

Hayman Reese (Cequent)  
PO Box 4050, Dandenong South VIC 3164  
Phone 1800 812 017 Email [info@haymanreese.com.au](mailto:info@haymanreese.com.au)

[www.haymanreese.com.au](http://www.haymanreese.com.au)



**HAYMAN REESE**  
**PART No: 03202RW**  
**GREAT WALL STEED NBP CL4**

# INSTALLATION INSTRUCTIONS

PLEASE ENSURE THAT INSTRUCTIONS ARE UNDERSTOOD PRIOR TO FITMENT  
PLACE THESE INSTRUCTIONS IN THE VEHICLE'S GLOVEBOX AFTER INSTALLATION IS COMPLETED

## Warning:

1. Do not, drill, cut, weld or otherwise modify the towbar.
2. If you are using electric welding on a motor vehicle, **always** check that the vehicle is not equipped with electronic engine or instrument management equipment. Failure to do so could **destroy** any on board computers. If in doubt, check with the vehicle's manufacturer.
3. If TBM is used in inverted position tow ball may make contact with rear tailgate when lowered, which could cause damage.

## General:

1. Ensure all hardware items have been included refer to assembly diagram.
2. It is recommended that the instructions are read through and completely understood before making any attempt to fit this product.
3. Be wary of any changes to vehicle designs or other accessories that may conflict with the installation of this product.
4. Before drilling ensure that the area is clear of fuel, electrical & other components.
5. All holes drilled into the body panels shall have all burrs & swarf removed then coated with a suitable rust preventative paint.
6. The high tensile fasteners supplied with this product were used to achieve the specified rating. If replacement is required ensure that fasteners of the same rating & quality are used. Contact an authorised **Hayman Reese** dealer if further information is required.
7. Ensure that all hardware is fastened to torque list below check fasteners on regular basis.
8. Towbar load rating sticker provided with this product shall be conspicuously located on inside rear end of the driver's door. **(See diagram below).**
9. Hayman Reese recommends that you check your tow ball to ensure that it complies with the Australian standards **AS 4177.2**.
10. **PLEASE NOTE:** It is advised to remove your LUG or TBM when not actually towing so as to produce a clear view of the vehicles registration plate if obscured, and to also provide maximum available departure angle.

## Tow bar Maintenance and Care.

Hayman Reese recommends that bolt torque's, as listed below, are routinely and regularly inspected and checked for correct tension. Replace any worn or defective parts.

We recommended to remove Tow Ball Mounts (TBM's, tongues or lugs) when not being used for any considerable length of time. So as to avoid injury, when not towing it is suggested that the tongue, Pull Pin and R-clip are removed then stored in a safe, clean and dry place, away from excessive moisture.

Hitch Pull Pins and spring "R" clips are regularly checked for proper installation. Replace any worn or defective parts.

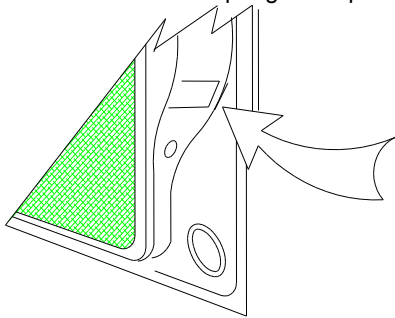

Place load rating sticker  
inside driver's door here

### RECOMMENDED ASSEMBLY TORQUE LISTING

#### Diameter Grade 8.8 Bolt

M6	9.5 Nm
M8	21.7 Nm
M10	43.4 Nm
M12	77.3 Nm
M14	146 Nm
M16	189.8 Nm

### FOR TOWING PURPOSES ONLY

For towing capacity details please refer to vehicle owner's manual or to the manufacturer. Overloading can void your warranties.

Hayman Reese (Cequent)  
PO Box 4050, Dandenong South VIC 3164  
Phone 1800 812 017 Email [info@haymanreese.com.au](mailto:info@haymanreese.com.au)

[www.haymanreese.com.au](http://www.haymanreese.com.au)



**HAYMAN REESE**  
**PART No: 03202RW**  
**GREAT WALL STEED NBP CL4**

## INSTALLATION INSTRUCTIONS

PLEASE ENSURE THAT INSTRUCTIONS ARE UNDERSTOOD PRIOR TO FITMENT  
 PLACE THESE INSTRUCTIONS IN THE VEHICLE'S GLOVEBOX AFTER INSTALLATION IS COMPLETED

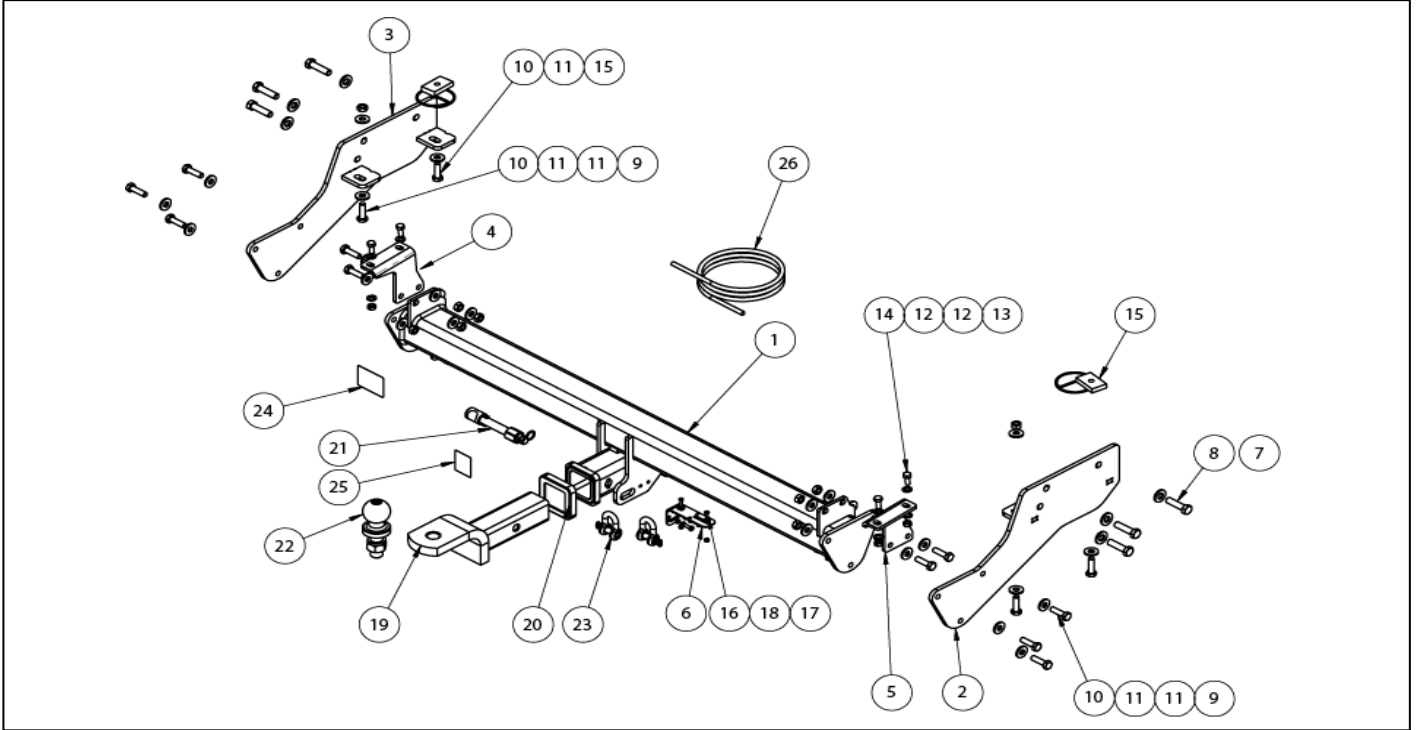

ITEM	DESCRIPTION	QTY	ITEM	DESCRIPTION	QTY
1	WELDED ASSEMBLY	1	14	SET SCREW HX HD M8x20x1.25P G8.8	4
2	SIDE ARM ASSY RH	1	15	FITTING PLATE M10 TAP 300MM WIRE	2
3	SIDE ARM ASSY LH	1	16	SCREW PAN HD M4x16x0.7P G4.6	2
4	STEP BRACKET LH	1	17	NUT NYLON LOCK HEX HD M4x0.7P G8	2
5	STEP BRACKET RH	1	18	WASHER PLAIN 3/6x1/2x20G	2
6	UNIVERSAL PLUG BRACKET KIT	1	19	TRAILER BALL MOUNT	1
7	WASHER PLAIN 1/2x1-1/8x16G	6	20	HITCH BOX COLLAR COVER	1
8	SET SCREW HEX HD M12x45x1.25P	6	21	SMART PIN ASSY CLASS 4 – GOLD	1
9	NUT HX M10-1.25Z/P	12	22	TOWBALL 50MM FLAT CHROME 3500KG HR	1
10	SET SCREW HEX HD M10x35x1.25P	14	23	“D” SHACKLE 10MM	2
11	WASHER FT M10x25.4x3	26	24	ACRYLIC COMPLIANCE LABEL	1
12	WASHER FT M8x17x1.20Z/P	8	25	HAYMAN REESE LOGO STICKER	1
13	NUT M8-1.25	4	26	WIRING LOOM	1

Hayman Reese (Cequent)  
 PO Box 4050, Dandenong South VIC 3164  
 Phone 1800 812 017 Email [info@haymanreese.com.au](mailto:info@haymanreese.com.au)

[www.haymanreese.com.au](http://www.haymanreese.com.au)



**HAYMAN REESE**  
PART No: 03202RW  
GREAT WALL STEED NBP CL4

## INSTALLATION INSTRUCTIONS

PLEASE ENSURE THAT INSTRUCTIONS ARE UNDERSTOOD PRIOR TO FITMENT  
PLACE THESE INSTRUCTIONS IN THE VEHICLE'S GLOVEBOX AFTER INSTALLATION IS COMPLETED

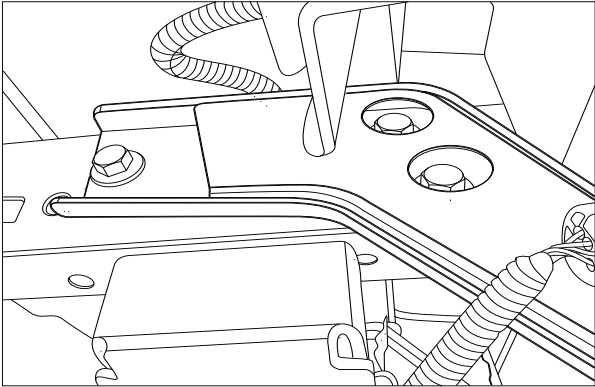
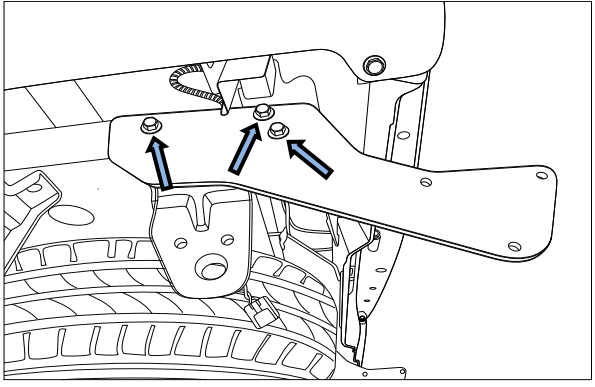
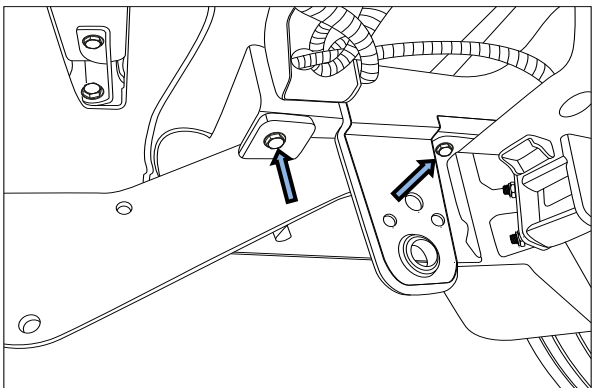
<p>1. Remove rear step by removing 3 x M12 bolts per side. Ensure to disconnect wiring harness.</p> <p>Retain rear step for re-fitment.</p>	
<p>2. Loosely secure side arm to the chassis side rail with 3 x M12 x 1.25P bolts complete with 1 x washer per bolt.</p> <p>Repeat for opposite side.</p>	
<p>3. Loosely secure the front arm support with 1x M10 x 1.25P x 35 bolt complete with 1 x washer and 1 x M10 nut on wire.</p> <p>4. Loosely secure the rear arm support with 1 x M10 x 1.25P x 35 bolt complete with 2 x washers and 1 x M10 nut.</p> <p>5. Repeat steps 3 and 4 for opposite side.</p>	

Hayman Reese (Cequent)  
PO Box 4050, Dandenong South VIC 3164  
Phone 1800 812 017 Email [info@haymanreese.com.au](mailto:info@haymanreese.com.au)

[www.haymanreese.com.au](http://www.haymanreese.com.au)



**HAYMAN REESE**  
PART No: 03202RW  
GREAT WALL STEED NBP CL4

## INSTALLATION INSTRUCTIONS

PLEASE ENSURE THAT INSTRUCTIONS ARE UNDERSTOOD PRIOR TO FITMENT  
PLACE THESE INSTRUCTIONS IN THE VEHICLE'S GLOVEBOX AFTER INSTALLATION IS COMPLETED

6. Lift crosstube to side arms and secure each side with 3 x M10 x 1.25P x 35 bolts complete with 2 x washers and 1 x nut per bolt.

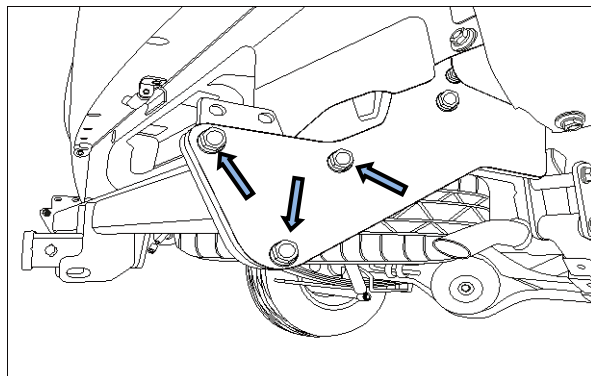

7. Secure LH Step Bracket to the assembly using 2 x M10 x 1.25P x 35 bolts complete with 2 x washers and 1 x nut per bolt.

**NOTE:** Bracket must be on the outside face of the assembly with the bend facing outwards.

Repeat for opposite side.

**Torque all fasteners accordingly:**

**M12: 125Nm**

**M10: 48Nm**

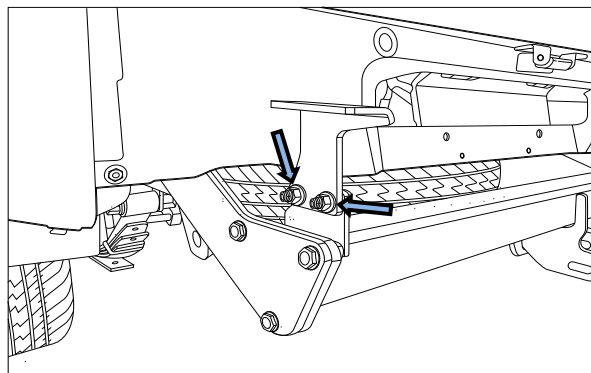

8. On the rear step assembly remove the plastic cover from the step support as follows:

- Unclip the step covers.
- Remove 12 x M6 countersunk bolts (top) and the 6 x Hex bolts on underside edge.
- Disconnect the wiring loom

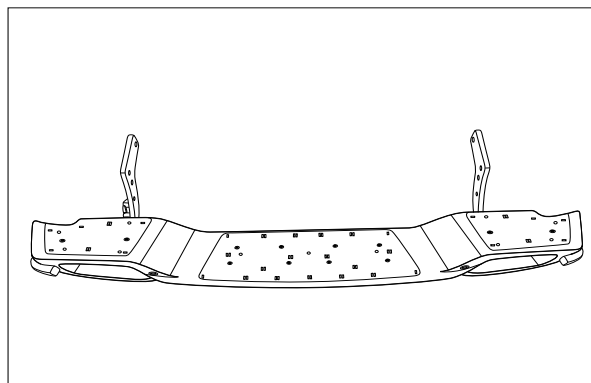

Hayman Reese (Cequent)  
PO Box 4050, Dandenong South VIC 3164  
Phone 1800 812 017 Email [info@haymanreese.com.au](mailto:info@haymanreese.com.au)

[www.haymanreese.com.au](http://www.haymanreese.com.au)



**HAYMAN REESE**  
PART No: 03202RW  
GREAT WALL STEED NBP CL4

**INSTALLATION INSTRUCTIONS**

PLEASE ENSURE THAT INSTRUCTIONS ARE UNDERSTOOD PRIOR TO FITMENT  
PLACE THESE INSTRUCTIONS IN THE VEHICLE'S GLOVEBOX AFTER INSTALLATION IS COMPLETED

9. On the steel step support, remove the 4 x M10 bolts (2 per side) and discard the side arm brackets.

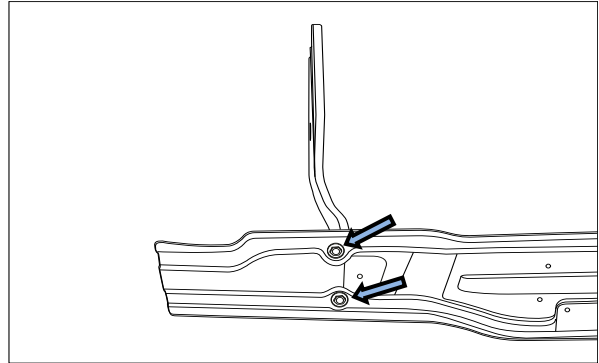

10. Re-attach the rear step support to the towbar assembly and secure with 4 x M8 x 1.25P bolts complete with 2 x washers and 1 x M8 nut per bolt.

**Torque M8 fasteners to 20Nm**

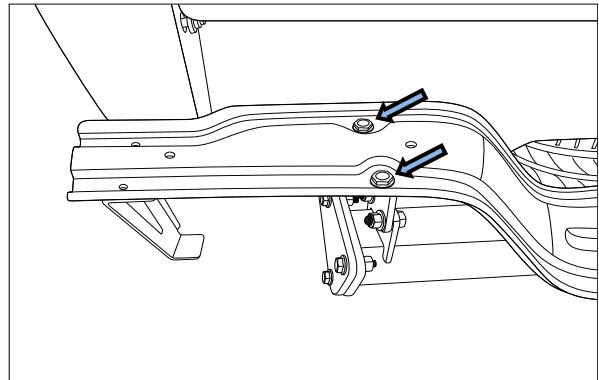

11. Re-attach rear step plastic covers by completing step 8 in reverse.

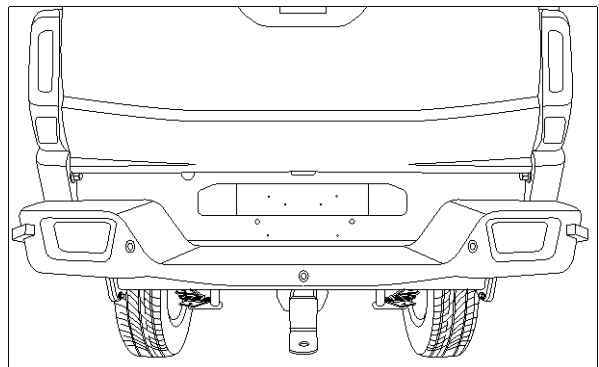

Hayman Reese (Cequent)  
PO Box 4050, Dandenong South VIC 3164  
Phone 1800 812 017 Email [info@haymanreese.com.au](mailto:info@haymanreese.com.au)

[www.haymanreese.com.au](http://www.haymanreese.com.au)



**HAYMAN REESE**  
PART No: 03202RW  
GREAT WALL STEED NBP CL4

## INSTALLATION INSTRUCTIONS

PLEASE ENSURE THAT INSTRUCTIONS ARE UNDERSTOOD PRIOR TO FITMENT  
PLACE THESE INSTRUCTIONS IN THE VEHICLE'S GLOVEBOX AFTER INSTALLATION IS COMPLETED

12. Open bonnet exposing vehicles engine bay (1).
13. In the engine bay, disconnect the negative battery terminal.

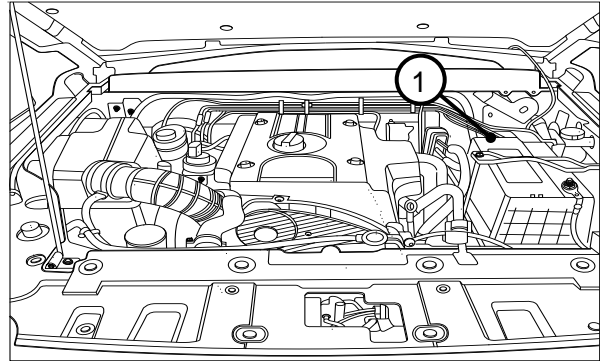

14. Route the Power Lead up to the battery, following the existing vehicle harness.
15. Connect the Power Lead Ring Terminal (1) to the positive battery terminal.
16. Secure the Power Lead to the existing vehicle harnesses with the supplied cable ties.

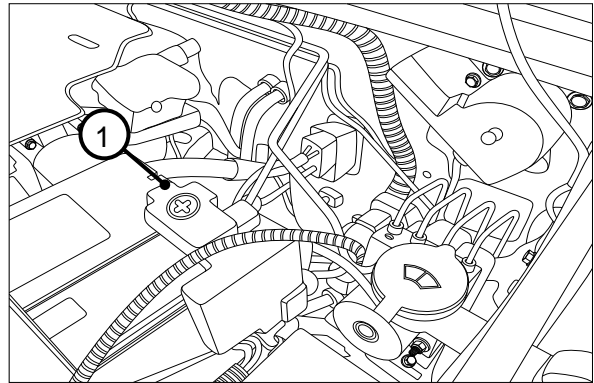

17. Route the harness from the battery (1) under the vehicle towards the rear underside of the vehicle (to the location of the ECU)(2).

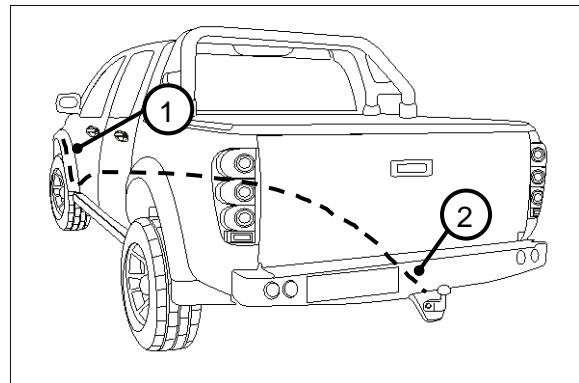

Hayman Reese (Cequent)  
PO Box 4050, Dandenong South VIC 3164  
Phone 1800 812 017 Email [info@haymanreese.com.au](mailto:info@haymanreese.com.au)

[www.haymanreese.com.au](http://www.haymanreese.com.au)



**HAYMAN REESE**  
PART No: 03202RW  
GREAT WALL STEED NBP CL4

## INSTALLATION INSTRUCTIONS

PLEASE ENSURE THAT INSTRUCTIONS ARE UNDERSTOOD PRIOR TO FITMENT  
PLACE THESE INSTRUCTIONS IN THE VEHICLE'S GLOVEBOX AFTER INSTALLATION IS COMPLETED

18. On the LHS of the tray, remove the two bolts (1) before removing the tray door catch (2).
19. Remove the bolt (3) located next to the tray door catch (2) and the bolt (4) beneath the tray door arm.  
**Repeat for RHS.**

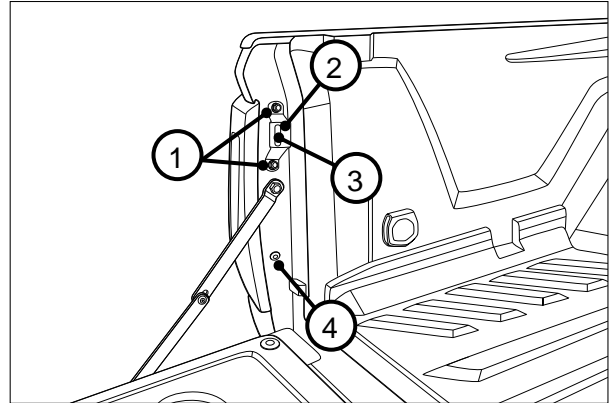

20. Dislodge the LHS tail lamp (1).
21. Disconnect the LHS tail lamp connector before removing the LHS tail lamp. **Repeat for RHS.**

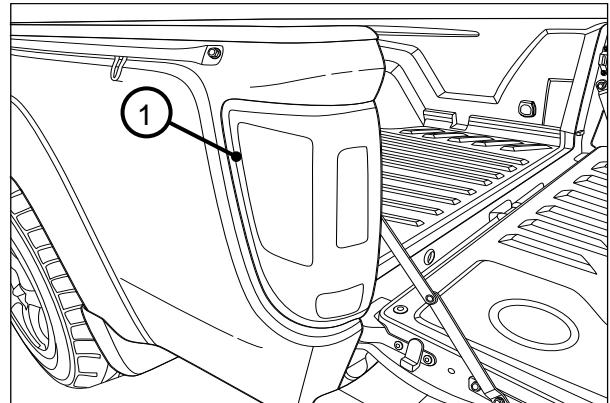

22. In the front Passenger wheel arch area, remove the vehicle sway bar bracket bolt (1) as shown.
23. Remove the upper cover fastener (2) and fold back the upper cover.

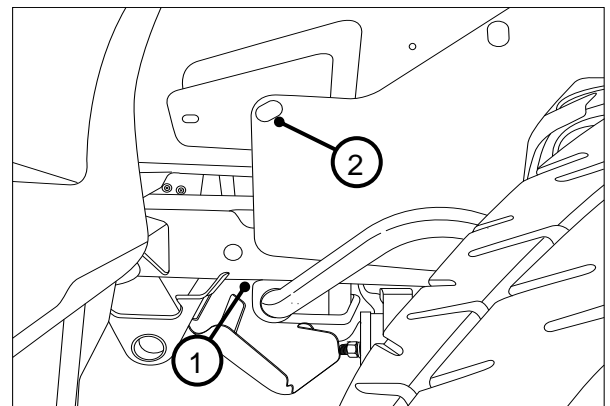

Hayman Reese (Cequent)  
PO Box 4050, Dandenong South VIC 3164  
Phone 1800 812 017 Email [info@haymanreese.com.au](mailto:info@haymanreese.com.au)

[www.haymanreese.com.au](http://www.haymanreese.com.au)





**HAYMAN REESE**  
PART No: 03202RW  
GREAT WALL STEED NBP CL4

## INSTALLATION INSTRUCTIONS

PLEASE ENSURE THAT INSTRUCTIONS ARE UNDERSTOOD PRIOR TO FITMENT  
PLACE THESE INSTRUCTIONS IN THE VEHICLE'S GLOVEBOX AFTER INSTALLATION IS COMPLETED

24. Feed the supplied M6 Flat Washer (1) into the M6 Bolt (2). Push the bolt through the hole located behind the upper cover.
25. On the other side the chassis feed an M6 Star Washer (3) and the 6mm end of the Ground Patch (4) into the Bolt (2).
26. Secure assembly using an M6 Nyloc Nut (5).
27. Route the Ground Patch (6) down behind the chassis rail towards the vehicle sway bar bracket.
28. Secure the 8mm end of the Ground Patch (7) to the vehicle sway bar bracket using the previously removed bolt (8).

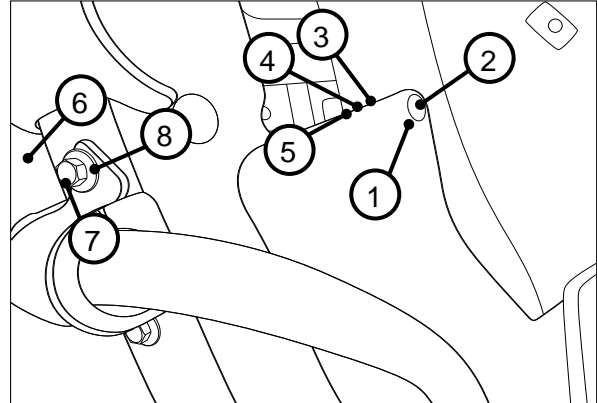

29. At the rear of the vehicle, route the RHS of the Trailer Wiring Harness (1) up the RHS of the vehicle and out into the RHS tail lamp cavity.
30. Connect the Trailer Wiring Harness (1) to the tail lamp connector (2).

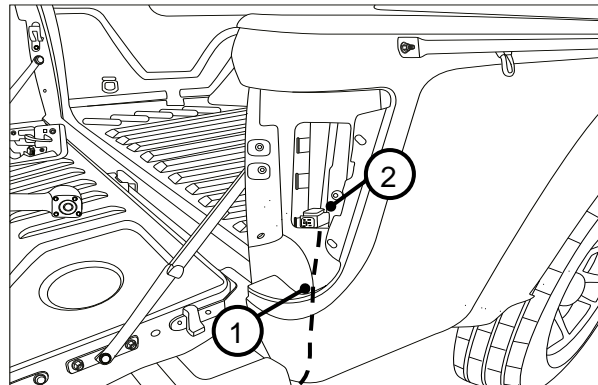

31. Route the Trailer wiring Harness (1) towards the LHS of the vehicle as shown and secure using cable ties (not supplied).
32. Route the LHS of the Trailer Wiring Harness (1) up the LHS of the vehicle and out into the LHS tail lamp cavity.
33. Connect the Trailer Wiring Harness (1) to the tail lamp connector (2).

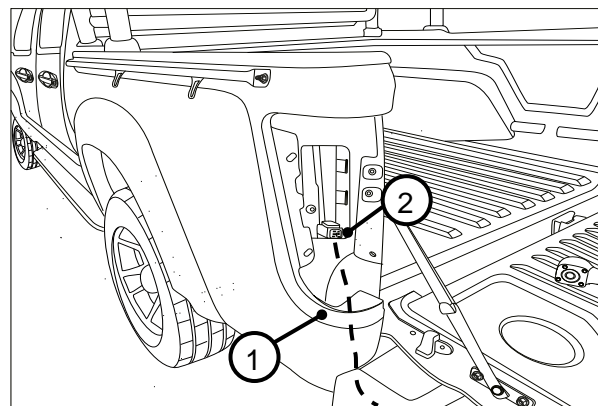

Hayman Reese (Cequent)  
PO Box 4050, Dandenong South VIC 3164  
Phone 1800 812 017 Email [info@haymanreese.com.au](mailto:info@haymanreese.com.au)

[www.haymanreese.com.au](http://www.haymanreese.com.au)



**HAYMAN REESE**  
PART No: 03202RW  
GREAT WALL STEED NBP CL4

**INSTALLATION INSTRUCTIONS**

PLEASE ENSURE THAT INSTRUCTIONS ARE UNDERSTOOD PRIOR TO FITMENT  
PLACE THESE INSTRUCTIONS IN THE VEHICLE'S GLOVEBOX AFTER INSTALLATION IS COMPLETED

34. Clean the inside of the LHS tail lamp (1) and the underside of the ECU Module (2) with a Cleaning Pad as shown (not supplied).
35. Secure ECU behind LHS tail as shown (3).  
**Important: Ensure ECU cable and connector are facing down.**
36. Attach ring terminal to grounding point (4).
37. Connect the power line to trailer wire harness.

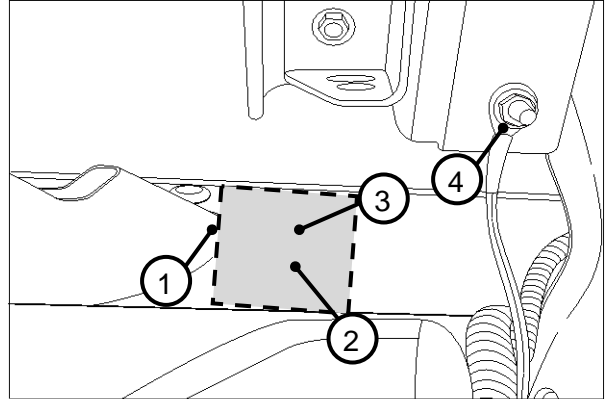

38. Under the LHS of the vehicle, locate the vehicle 6-way rear connectors (1).
39. Disconnect the 6-way connectors (1) and patch in the mating connectors from the Trailer Harness(2).

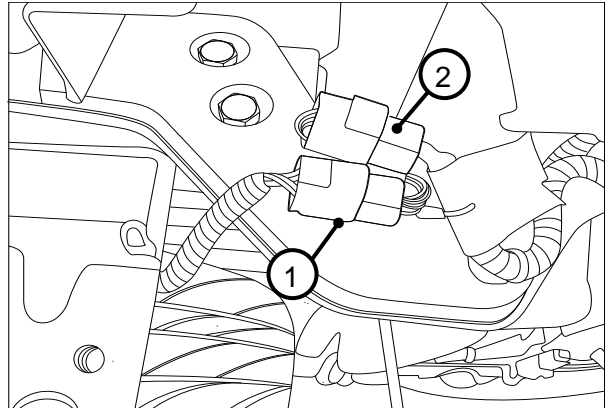

40. Connect the tail harness 8-way connector (1) to the trailer patch 8-way mating connector (2).
41. To enable RPA cut-off, crimp the tail harness GREY and GREY/BLACK wires (3) to the trailer patch matching GREY and GREY/BLACK wires (4).
42. Apply silicone grease (5) to waterproof connector.

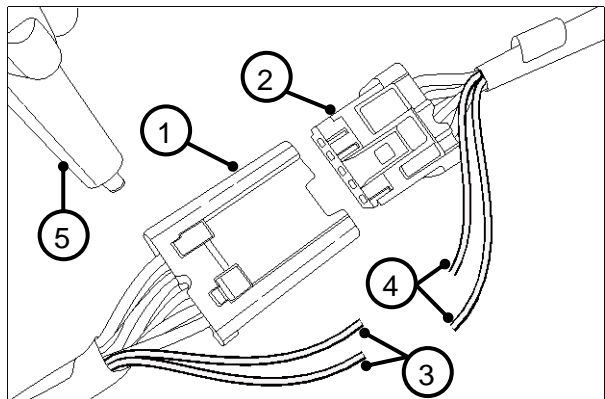

Hayman Reese (Cequent)  
PO Box 4050, Dandenong South VIC 3164  
Phone 1800 812 017 Email [info@haymanreese.com.au](mailto:info@haymanreese.com.au)

[www.haymanreese.com.au](http://www.haymanreese.com.au)



**HAYMAN REESE**  
**PART No: 03202RW**  
**GREAT WALL STEED NBP CL4**

**INSTALLATION INSTRUCTIONS**

PLEASE ENSURE THAT INSTRUCTIONS ARE UNDERSTOOD PRIOR TO FITMENT  
PLACE THESE INSTRUCTIONS IN THE VEHICLE'S GLOVEBOX AFTER INSTALLATION IS COMPLETED

- |   |  |
|---|--|
| <ul style="list-style-type: none"><li>43. Re-connect negative battery terminal.</li><li>44. Test the trailer patch function using a light board or multi-meter.</li><li>45. Secure all harnesses using cable ties (not supplied).</li><li>46. Re-fit all removed parts and secure all fasteners, ensuring there are no squeaks or rattles.</li><li>47. Place the fitting instructions in the glove box after fitment.</li></ul> |  |
|---|--|

Hayman Reese (Cequent)  
PO Box 4050, Dandenong South VIC 3164  
Phone 1800 812 017 Email [info@haymanreese.com.au](mailto:info@haymanreese.com.au)

[www.haymanreese.com.au](http://www.haymanreese.com.au)





# FITTING INSTRUCTIONS

## Smart Pin (55070BL)

• These fitting instructions are supplied to ensure understanding of how the SMART PIN should be fitted and used correctly.

• Once installed, we recommend **ALL** instructions are kept and placed in the vehicle glove box.

**NOTE: Routine maintenance and inspection of the towbar & SMART PIN is required. Regularly inspect for wear and check the tightness of the SMART PIN NUT. Follow instructions below to retighten the nut when necessary.**

**\*Do not tow with your vehicle if the R CLIP or the SMART PIN NUT is loose or missing. Replacement parts are available from your Hayman Reese Distributor.**

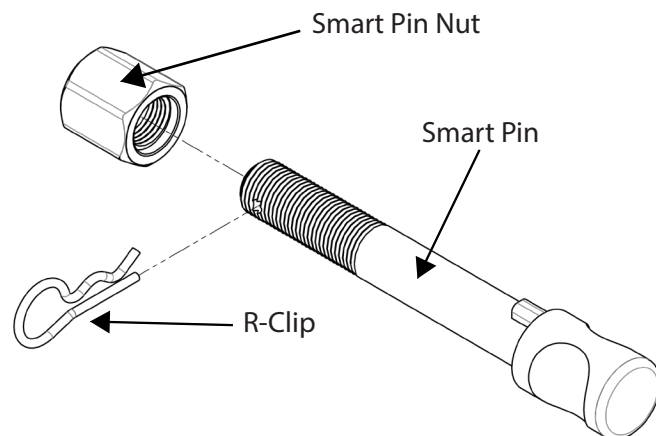
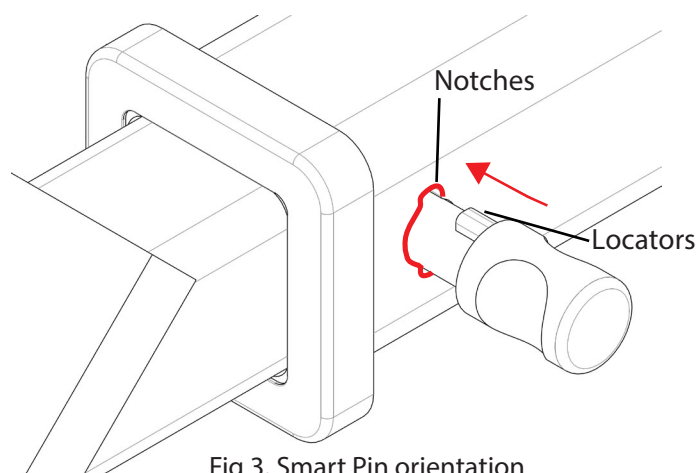
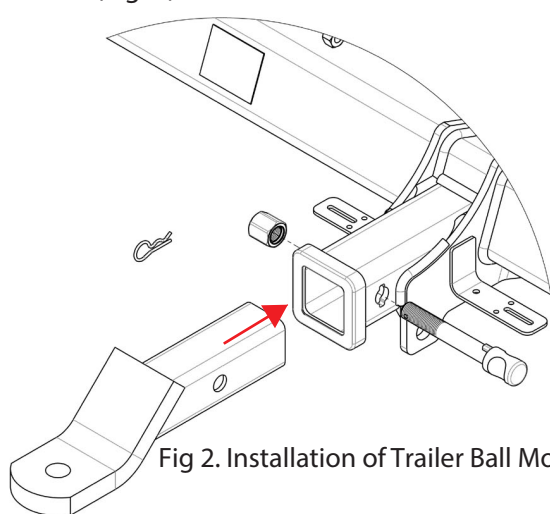

Fig 1. Smart Pin assembly

**STEP 1** Insert Trailer Ball Mount (TBM) into towbar HITCHBOX, aligning hole in TBM SHANK with hole in HITCHBOX (Fig. 2).



**STEP 2** Insert SMART PIN through hole in HITCHBOX and hole in TBM SHANK; ensure the LOCATORS are inserted into the NOTCHES in the HITCHBOX (Fig. 3).

**STEP 3** Screw SMART PIN NUT onto SMART PIN; tighten SMART PIN NUT until finger tight, ensuring TBM is restrained from movement.

**STEP 4** Tighten SMART PIN NUT by turning nut a further 1/8th of a turn in the clockwise direction using a 24mm spanner (Fig 4).

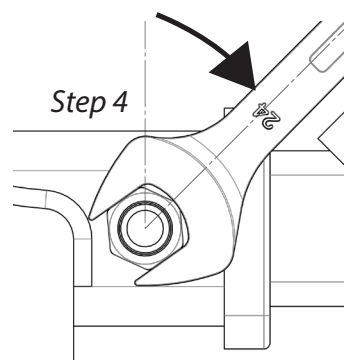

**STEP 5** Install SMART PIN R CLIP through the hole on the SMART PIN (Fig. 1).

