

HAYMAN REESE
PART No: 03160RW
HOLDEN CAPTIVA 5 CG SERIES
INSTALLATION INSTRUCTIONS

PLEASE ENSURE THAT INSTRUCTIONS ARE UNDERSTOOD PRIOR TO FITMENT
PLACE THESE INSTRUCTIONS IN THE VEHICLE'S GLOVEBOX AFTER INSTALLATION IS COMPLETED



Installation Time: Approx 90 Mins

Towbar Installation Instructions

Towbar capacity

HOLDEN CAPTIVA 5 CG SERIES

Part Number 03160RW

Max Towing Braked 1700 kg

Max Towing Unbraked 750 kg

Max Static Ball Load 158 kg

Hayman Reese (Cequent)
PO Box 4050, Dandenong South VIC 3164
Phone 1800 812 017 Email info@haymanreese.com.au

www.haymanreese.com.au



HAYMAN REESE

PART No: 03160RW

HOLDEN CAPTIVA 5 CG SERIES

INSTALLATION INSTRUCTIONS

PLEASE ENSURE THAT INSTRUCTIONS ARE UNDERSTOOD PRIOR TO FITMENT
PLACE THESE INSTRUCTIONS IN THE VEHICLE'S GLOVEBOX AFTER INSTALLATION IS COMPLETED

Warning:

1. Do not, drill, cut, weld or otherwise modify the towbar.
2. If you are using electric welding on a motor vehicle, **always** check that the vehicle is not equipped with electronic engine or instrument management equipment. Failure to do so could **destroy** any on board computers. If in doubt, check with the vehicle's manufacturer.
3. If TBM is used in inverted position tow ball may make contact with rear tailgate when lowered, which could cause damage.

General:

1. Ensure all hardware items have been included refer to assembly diagram.
2. It is recommended that the instructions are read through and completely understood before making any attempt to fit this product.
3. Be wary of any changes to vehicle designs or other accessories that may conflict with the installation of this product.
4. Before drilling ensure that the area is clear of fuel, electrical & other components.
5. All holes drilled into the body panels shall have all burrs & swarf removed then coated with a suitable rust preventative paint.
6. The high tensile fasteners supplied with this product were used to achieve the specified rating. If replacement is required ensure that fasteners of the same rating & quality are used. Contact an authorised **Hayman Reese** dealer if further information is required.
7. Ensure that all hardware is fastened to torque list below check fasteners on regular basis.
8. Towbar load rating sticker provided with this product shall be conspicuously located on inside rear end of the driver's door. **(See diagram below).**
9. Hayman Reese recommends that you check your tow ball to ensure that it complies with the Australian standards **AS 4177.2**.
10. **PLEASE NOTE:** It is advised to remove your LUG or TBM when not actually towing so as to produce a clear view of the vehicles registration plate if obscured, and to also provide maximum available departure angle.

Tow bar Maintenance and Care.

Hayman Reese recommends that bolt torque's, as listed below, are routinely and regularly inspected and checked for correct tension. Replace any worn or defective parts.

We recommended to remove Tow Ball Mounts (TBM's, tongues or lugs) when not being used for any considerable length of time.

So as to avoid injury, when not towing it is suggested that the tongue, Pull Pin and R-clip are removed then stored in a safe, clean and dry place, away from excessive moisture.

Hitch Pull Pins and spring "R" clips are regularly checked for proper installation. Replace any worn or defective parts.

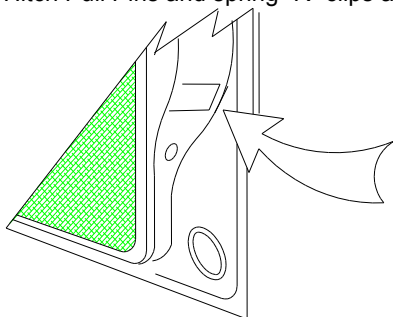

Place load rating sticker
inside driver's door here

RECOMMENDED ASSEMBLY TORQUE LISTING

Diameter Grade 8.8 Bolt

M6	9.5 Nm
M8	21.7 Nm
M10	43.4 Nm
M12	77.3 Nm
M14	146 Nm
M16	189.8 Nm

FOR TOWING PURPOSES ONLY

For towing capacity details please refer to vehicle owner's manual or to the manufacturer. Overloading can void your warranties.

Hayman Reese (Cequent)
PO Box 4050, Dandenong South VIC 3164
Phone 1800 812 017 Email info@haymanreese.com.au

www.haymanreese.com.au



HAYMAN REESE

PART No: 03160RW

HOLDEN CAPTIVA 5 CG SERIES

INSTALLATION INSTRUCTIONS

PLEASE ENSURE THAT INSTRUCTIONS ARE UNDERSTOOD PRIOR TO FITMENT
PLACE THESE INSTRUCTIONS IN THE VEHICLE'S GLOVEBOX AFTER INSTALLATION IS COMPLETED

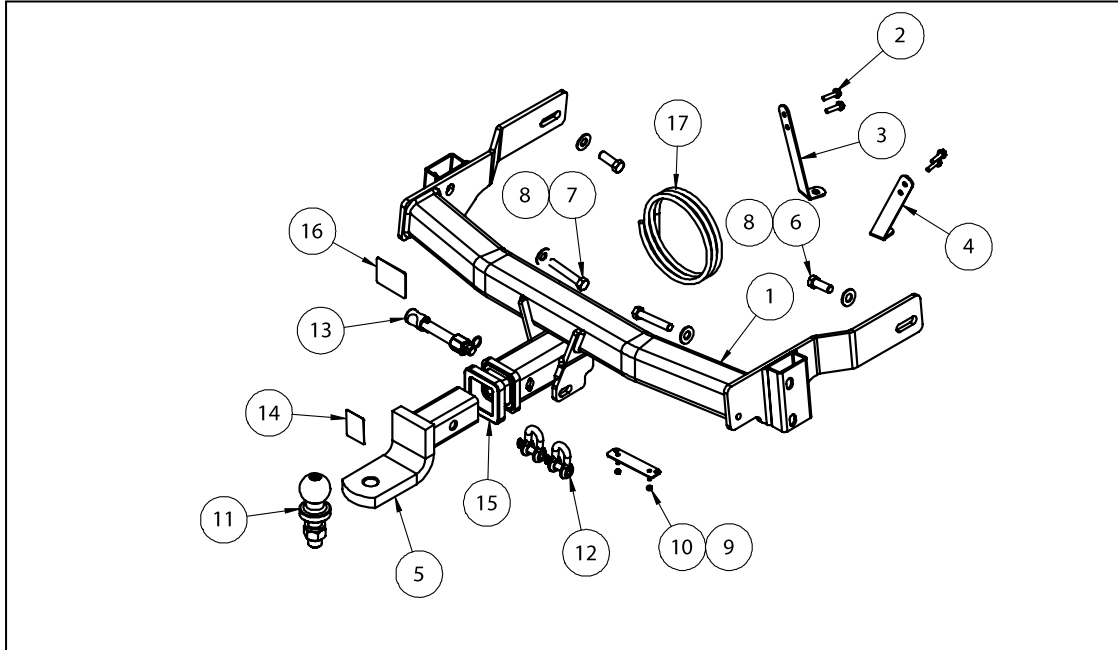

ITEM	DESCRIPTION	QTY.
1	CAPTIVA 5 WELDED ASSY	1
2	TEK SCREW 14-20 HEX HD 22mm	4
3	LHS BUMPER MOUNT	1
4	RHS BUMPER MOUNT	1
5	TBM ASSY	1
6	SET SCREW M12x35 1.75P GR8.8	2
7	BOLT M12x70x1.75P	4
8	WASHER FLAT M12	6
9	PLUG BRACKET	1
10	NUT MYLOC M4-0.7 Z/P	2
11	HR TOWBALL	1
12	10mm "D" SHACKLE	2
13	ANTI-RATTLE PULL PIN ASSY GOLD	1
14	H.R STICKER	1
15	HITCH BOX COLLAR COVER	1
16	ACRYLIC COMPLIANCE PLATE	1
17	WIRING LOOM	1

Hayman Reese (Cequent)
PO Box 4050, Dandenong South VIC 3164
Phone 1800 812 017 Email info@haymanreese.com.au

www.haymanreese.com.au



HAYMAN REESE
PART No: 03160RW
HOLDEN CAPTIVA 5 CG SERIES
INSTALLATION INSTRUCTIONS

PLEASE ENSURE THAT INSTRUCTIONS ARE UNDERSTOOD PRIOR TO FITMENT
PLACE THESE INSTRUCTIONS IN THE VEHICLE'S GLOVEBOX AFTER INSTALLATION IS COMPLETED

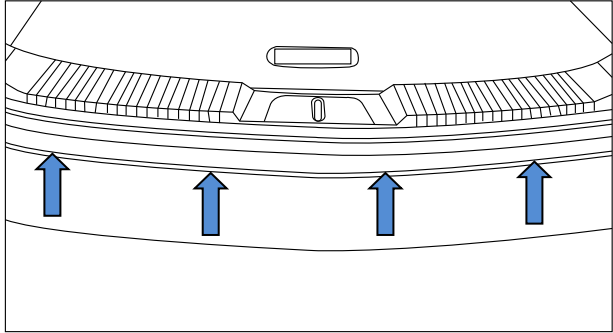
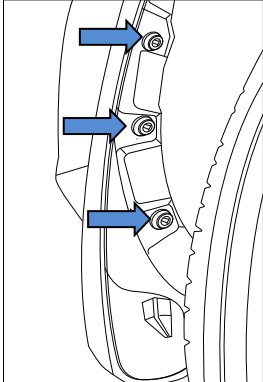
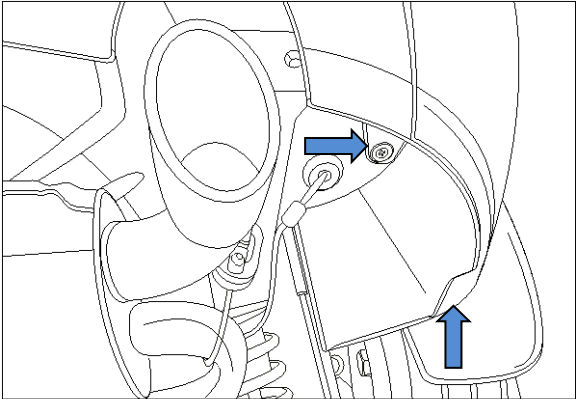
<p>1. Open the vehicle tail gate.</p> <p>2. Remove 4 x Scrivets securing top of bumper to rear of vehicle.</p>	
<p>3. Remove 3 x Hex head Screws within rear wheel arch.</p> <p>Repeat for opposite side of vehicle.</p>	
<p>4. Remove 1 x Scrivet and 1 x Hex head Screw from underside of bumper, rear of rear wheel arch.</p> <p>Repeat for opposite side of vehicle.</p>	

Hayman Reese (Cequent)
PO Box 4050, Dandenong South VIC 3164
Phone 1800 812 017 Email info@haymanreese.com.au

www.haymanreese.com.au



HAYMAN REESE

PART No: 03160RW

HOLDEN CAPTIVA 5 CG SERIES

INSTALLATION INSTRUCTIONS

PLEASE ENSURE THAT INSTRUCTIONS ARE UNDERSTOOD PRIOR TO FITMENT
PLACE THESE INSTRUCTIONS IN THE VEHICLE'S GLOVEBOX AFTER INSTALLATION IS COMPLETED

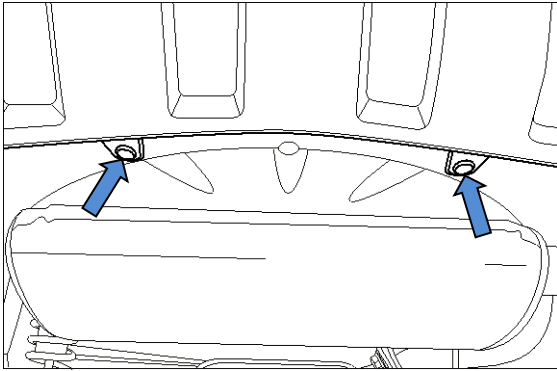
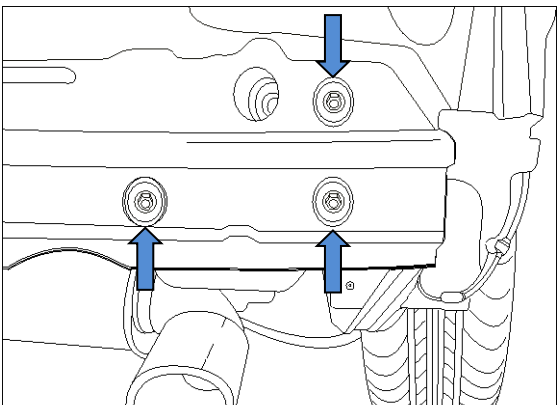
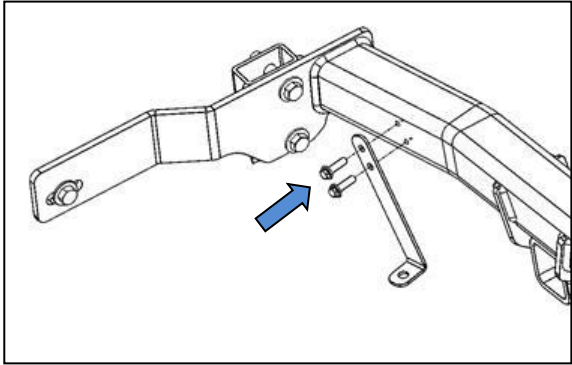
<p>5. Remove 2 x Scrivets from underside of rear bumper.</p> <p>6. Carefully unclip and remove bumper. Disconnect parking sensor loom as required.</p>	
<p>7. Remove and discard rear impact beam by removing 6 x Bolts (3 per side).</p>	
<p>8. Install bumper mount onto towbar using 2 x self-tapping Screws.</p> <p>Repeat for opposite side of towbar.</p>	

Hayman Reese (Cequent)
PO Box 4050, Dandenong South VIC 3164
Phone 1800 812 017 Email info@haymanreese.com.au

www.haymanreese.com.au



HAYMAN REESE
PART No: 03160RW
HOLDEN CAPTIVA 5 CG SERIES
INSTALLATION INSTRUCTIONS

PLEASE ENSURE THAT INSTRUCTIONS ARE UNDERSTOOD PRIOR TO FITMENT
PLACE THESE INSTRUCTIONS IN THE VEHICLE'S GLOVEBOX AFTER INSTALLATION IS COMPLETED

9. Lower exhaust by detaching exhaust hangers (1 per side).

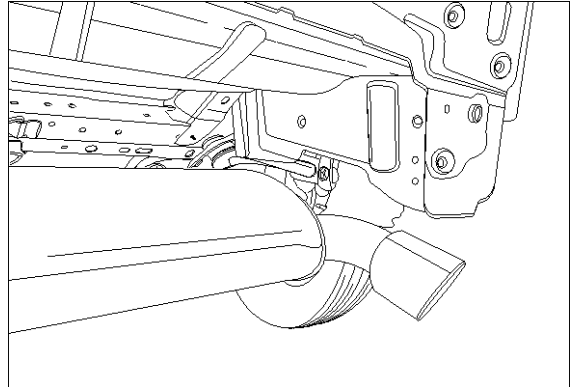

10. Offer towbar to vehicle and loosely secure using 2 x M12 x 35 Hex head Screws and 4 x M12 x 70 Bolts, complete with Flat Washers.
11. Tighten all fasteners to torques listed on page 2 of this document.

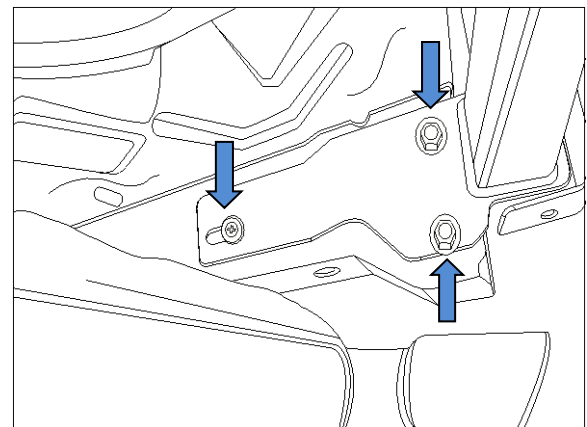
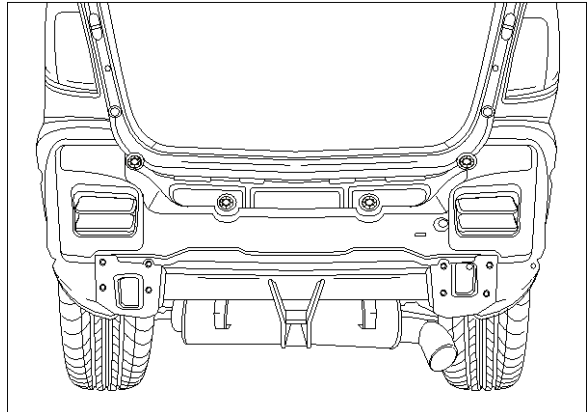

Hayman Reese (Cequent)
PO Box 4050, Dandenong South VIC 3164
Phone 1800 812 017 Email info@haymanreese.com.au

www.haymanreese.com.au



HAYMAN REESE

PART No: 03160RW

HOLDEN CAPTIVA 5 CG SERIES

INSTALLATION INSTRUCTIONS

PLEASE ENSURE THAT INSTRUCTIONS ARE UNDERSTOOD PRIOR TO FITMENT
PLACE THESE INSTRUCTIONS IN THE VEHICLE'S GLOVEBOX AFTER INSTALLATION IS COMPLETED

12. Mark out and drill 2x \varnothing 5mm holes 69mm apart on bumper skin to support the plug bracket. Feed bracket threads through drilled holes prior to reinstalling bumper.

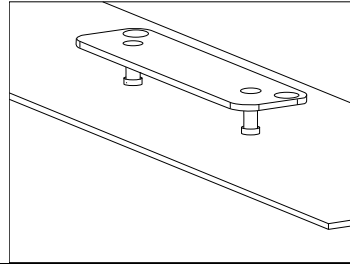

13. Select the appropriate bumper cut from below depending on the style of your bumper. Identify centreline of bumper. Mark the bumper cut as measured on the outside face of bumper, starting from the bottom edge of the bumper.

BUMPER 1

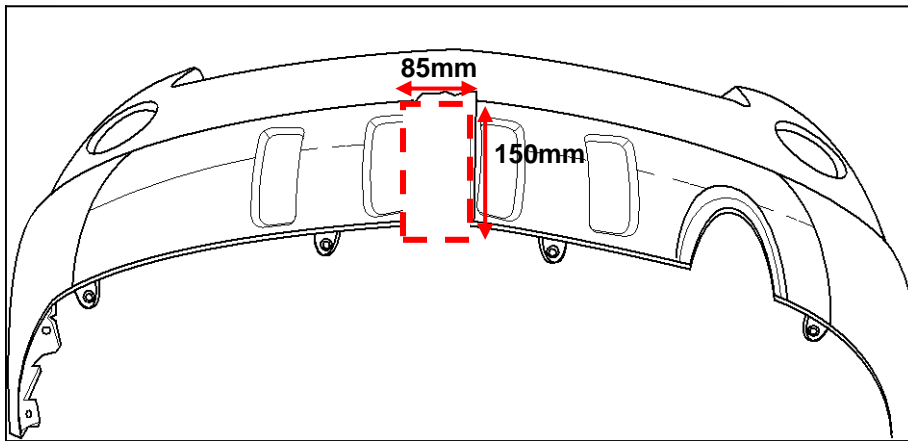

BUMPER 2

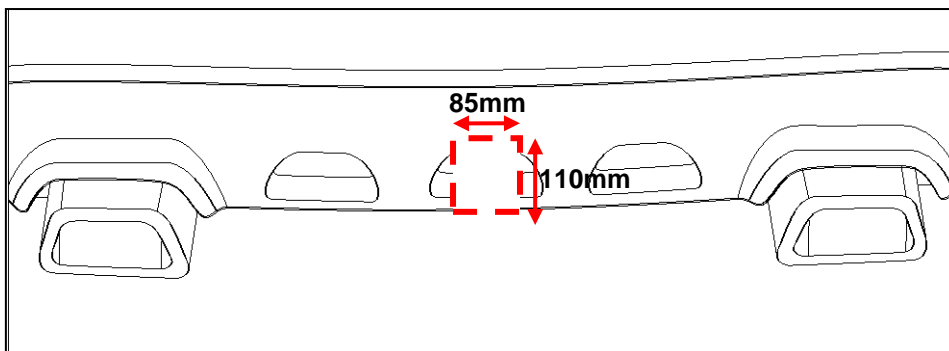

14. Reinstall bumper by following steps 1 to 6 in reverse order

Hayman Reese (Cequent)
PO Box 4050, Dandenong South VIC 3164
Phone 1800 812 017 Email info@haymanreese.com.au

www.haymanreese.com.au



HAYMAN REESE
HOLDEN CAPTIVA
PART No: 100405-WL

INSTALLATION INSTRUCTIONS

PLEASE ENSURE THAT INSTRUCTIONS ARE UNDERSTOOD PRIOR TO FITMENT

Wiring Loom Installation Instructions

HOLDEN CAPTIVA
Part No: 100405-WL
ECU: 04830

Tail Harness Length Required: 1200mm
RPA Override Switch Part No: 04848 (If Fitted)

Wiring Loom Installation Time: Approx 20 Mins

Issue Date 07-07-10

Page 1

Part No: 100405-WL

Hayman Reese (Cequent)
PO Box 4050, Dandenong South VIC 3164
Phone 1800 812 017 Email info@haymanreese.com.au

www.haymanreese.com.au



**HAYMAN REESE
HOLDEN CAPTIVA
PART No: 100405-WL**

INSTALLATION INSTRUCTIONS

PLEASE ENSURE THAT INSTRUCTIONS ARE UNDERSTOOD PRIOR TO FITMENT

1. In the luggage compartment, remove the RHS storage compartment cover (1).



2. Remove the RHS storage compartment (1) by removing the fastener on the bottom.

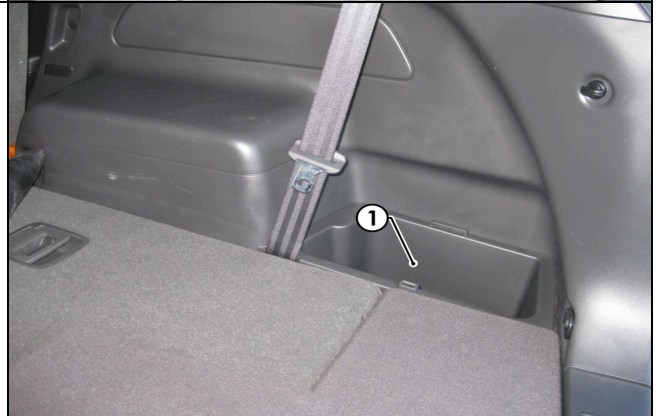

3. Locate the RHS 16-way breakout connector (1).



Issue Date 07-07-10

Page 2

Part No: 100405-WL

Hayman Reese (Cequent)
PO Box 4050, Dandenong South VIC 3164
Phone 1800 812 017 Email info@haymanreese.com.au

www.haymanreese.com.au



HAYMAN REESE
HOLDEN CAPTIVA
PART No: 100405-WL

INSTALLATION INSTRUCTIONS

PLEASE ENSURE THAT INSTRUCTIONS ARE UNDERSTOOD PRIOR TO FITMENT

4. Drill a Ø31mm hole (1) into the area next to the vehicle grommet. File down any rough or sharp edges and then spray on rust inhibitor.
5. Mount the tail harness socket (tail length 1200mm) to the towbar mounting bracket using M4 fasteners (not supplied).



6. Route the tail harness connector into the drilled out hole (1). Adjust the tail harness grommet into place ensuring it is seated correctly. Secure the tail harness grommet into place using a cable tie (not supplied).
7. Connect the Trailer Harness (P/No:100405-WL) 16-way connector (1) to the breakout connector.

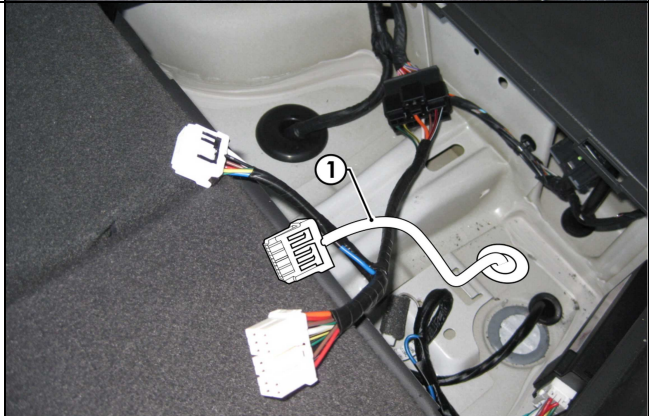

8. Connect the tail harness connector (1) to the trailer patch harness mating connector (2).

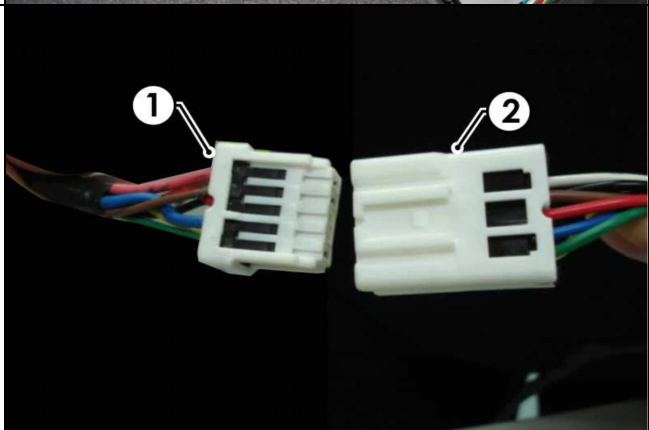

Issue Date 07-07-10

Page 3

Part No: 100405-WL

Hayman Reese (Cequent)
PO Box 4050, Dandenong South VIC 3164
Phone 1800 812 017 Email info@haymanreese.com.au

www.haymanreese.com.au



**HAYMAN REESE
HOLDEN CAPTIVA
PART No: 100405-WL**

INSTALLATION INSTRUCTIONS

PLEASE ENSURE THAT INSTRUCTIONS ARE UNDERSTOOD PRIOR TO FITMENT

9. Connect the 12-way Trailer Patch Connector (2) to the ECU (1).

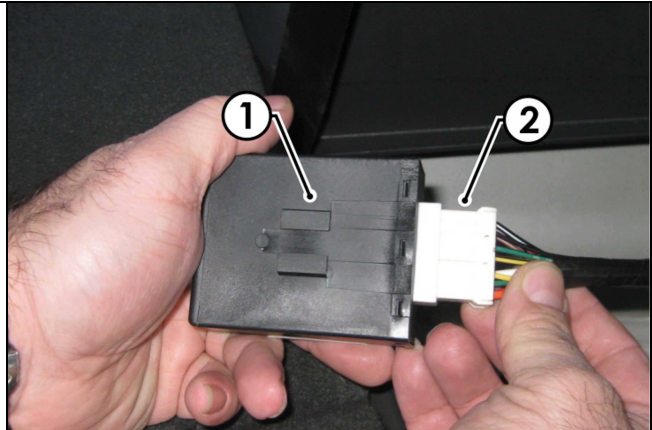

10. Peel the adhesive backing on the ECU (1) and adhere the ECU to the vehicle sheet metal area as show.



11. Test the Trailer Harness function using a Light Board or multimeter.
12. Secure all Harnesses using cables ties (not supplied).
13. Refit all removed parts and secure all fasteners, ensuring there are no squeaks or rattles.
14. Place instructions in glove box after fitment.

Issue Date 07-07-10

Page 4

Part No: 100405-WL

Hayman Reese (Cequent)
PO Box 4050, Dandenong South VIC 3164
Phone 1800 812 017 Email info@haymanreese.com.au

www.haymanreese.com.au





FITTING INSTRUCTIONS

Smart Pin (55070BL)

• These fitting instructions are supplied to ensure understanding of how the SMART PIN should be fitted and used correctly.

• Once installed, we recommend **ALL** instructions are kept and placed in the vehicle glove box.

NOTE: Routine maintenance and inspection of the towbar & SMART PIN is required. Regularly inspect for wear and check the tightness of the SMART PIN NUT. Follow instructions below to retighten the nut when necessary.

***Do not tow with your vehicle if the R CLIP or the SMART PIN NUT is loose or missing. Replacement parts are available from your Hayman Reese Distributor.**

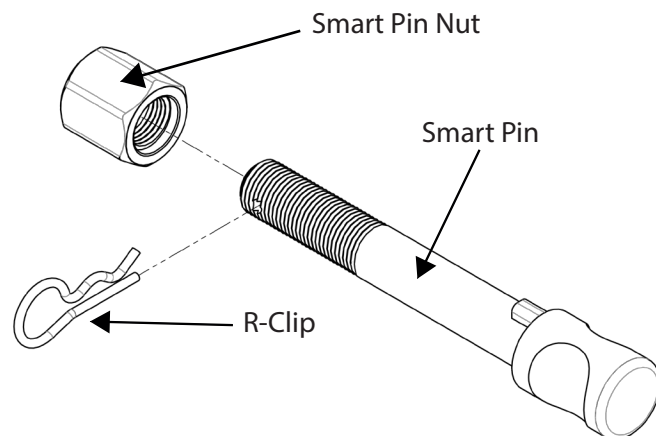
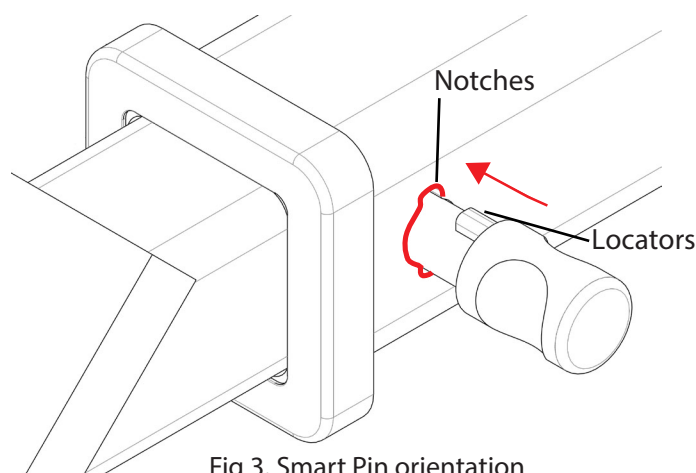
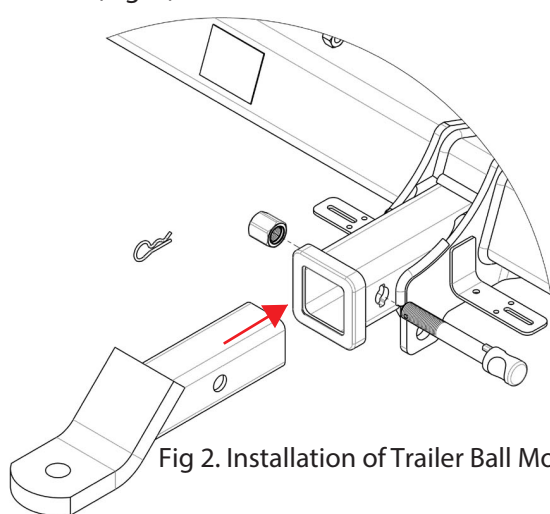

Fig 1. Smart Pin assembly

STEP 1 Insert Trailer Ball Mount (TBM) into towbar HITCHBOX, aligning hole in TBM SHANK with hole in HITCHBOX (Fig. 2).



STEP 2 Insert SMART PIN through hole in HITCHBOX and hole in TBM SHANK; ensure the LOCATORS are inserted into the NOTCHES in the HITCHBOX (Fig. 3).

STEP 3 Screw SMART PIN NUT onto SMART PIN; tighten SMART PIN NUT until finger tight, ensuring TBM is restrained from movement.

STEP 4 Tighten SMART PIN NUT by turning nut a further 1/8th of a turn in the clockwise direction using a 24mm spanner (Fig 4).

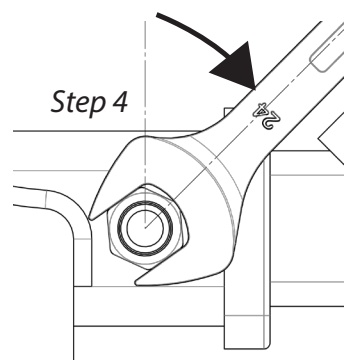

STEP 5 Install SMART PIN R CLIP through the hole on the SMART PIN (Fig. 1).

